

PI

KANSAS

**WELL COMPLETION REPORT AND
DRILLER'S LOG**

State Geological Survey
WICHITA BRANCH

S. 18 T. 7 R. 17 ^W
Loc. C of SE/4 NW/4 NE/4

API No. 15 — 163 — 21,377
County Number

County Rooks

Operator
The Gene Brown Company

Address 407 S. Main
Plainville, Kansas 67663

Well No. 1 Lease Name Dix

Footage Location
990 feet from (N) line 330 1650 feet from (E) (W) line 990

Principal Contractor Lawbanco Drilling Geologist Eric Waddell

Spud Date 8-13-81 Date Completed 8-18-81 Total Depth 3408 P.B.T.D.

Directional Deviation Oil and/or Gas Purchaser

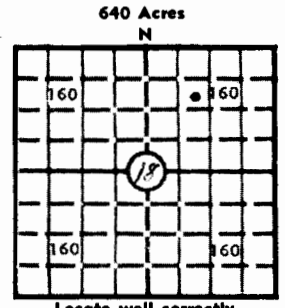

Elev.: Gr. 1881
DF 1884 KB 1886

CASING RECORD

Report of all strings set— surface, intermediate, production, etc.

Purpose of string	Size hole drilled	Size casing set (in O.D.)	Weight lbs./ft.	Setting depth	Type cement	Sacks	Type and percent additives
surface	12 $\frac{1}{4}$ "	8 5/8	20	247	Common	150	Quikset

LINER RECORD

PERFORATION RECORD

Top, ft.	Bottom, ft.	Sacks cement	Shots per ft.	Size & type	Depth interval

Size	Setting depth	Packer set at			

ACID, FRACTURE, SHOT, CEMENT SQUEEZE RECORD

Amount and kind of material used	Depth interval treated

INITIAL PRODUCTION

Date of first production	Producing method (flowing, pumping, gas lift, etc.)
RATE OF PRODUCTION PER 24 HOURS	Oil bbls. Gas MCF Water bbls. Gas-oil ratio CFPB
Disposition of gas (vented, used on lease or sold)	Producing interval(s)

INSTRUCTIONS: As provided in KCC Rule 82-2-125, within 90 days after completion of a well, one completed copy of this Drillers Log shall be trans-
mitted to the State Geological Survey of Kansas, 4150 Monroe Street, Wichita, Kansas 67209. Copies of this form are available from the Conservation
Division, State Corporation Commission, 245 No. Water, Wichita, Kansas 67202. Phone AC 316-522-2206. If confidential custody is desired, please note
Rule 82-2-125. Drillers Logs will be on open file in the Oil and Gas Division, State Geological Survey of Kansas, Lawrence, Kansas 66044.

Operator The Gene Brown Company		DESIGNATE TYPE OF COMP.: OIL, GAS, DRY HOLE, SWDW, ETC.: Dry Hole
Well No. #1	Lease Name Dix	
S 18 T 7 R 17 W		

WELL LOG

Show all important zones of porosity and contents thereof; cored intervals, and all drill-stem tests, including depth interval tested, cushion used, time tool open, flowing and shut-in pressures, and recoveries.

SHOW GEOLOGICAL MARKERS, LOGS RUN, OR OTHER DESCRIPTIVE INFORMATION.

FORMATION DESCRIPTION, CONTENTS, ETC.	TOP	BOTTOM	NAME	DEPTH
Topeka LMS	2851	-965		
Heebner SH	3063	-1177		
Toronto LMS	3088	-1202		
Lansing-KC	3111	-1225		
Base of KC	3335	-1449		
Reworked Arbuckle	3386	-1500		
RTD	3408	-1522		
No logs or drill stem tests were taken on this well.				
USE ADDITIONAL SHEETS, IF NECESSARY, TO COMPLETE WELL RECORD.				

Date Received	<div>Signature <i>Thomas E. Brown</i></div> <div>Title <i>Owner</i></div> <div>Date <i>12/9-81</i></div>
---------------	--