

Ind 11/2/84
KCC

STATE CORPORATION COMMISSION OF KANSAS
OIL & GAS CONSERVATION DIVISION

WELL COMPLETION OR RECOMPLETION FORM
ACO-1 WELL HISTORY

DESCRIPTION OF WELL AND LEASE

Operator: License # 9826
Name Scarth Oil & Gas Co.
Address 901 S. Polk
City/State/Zip Amarillo, TX 79101

Operator Contact Person T. S. Clopton
Phone (806) 373-6932

Contractor: License # 5422
Name Abercrombie Drilling, Inc.

Wellsite Geologist J. F. Howell III
Phone (806) 373-6932

PURCHASER Koch Oil Company Wichita, KS

Designate Type of Completion
 New Well Re-Entry Workover

Oil SWD Temp Abd
 Gas Inj Delayed Comp.
 Dry Other (Core, Water Supply etc.)

If **OWWO**: old well info as follows:
Operator
Well Name
Comp. Date Old Total Depth

WELL HISTORY

Drilling Method:
 Mud Rotary Air Rotary Cable
10-12-84 10-17-84 11-2-84
Spud Date Date Reached TD Completion Date
3638' 3551'
Total Depth PBTD

Amount of Surface Pipe Set and Cemented at 341 feet

Multiple Stage Cementing Collar Used? Yes No
If yes, show depth set feet

If alternate 2 completion, cement circulated from 1712 feet depth to surface 300 SX cmt

API NO. 15-163-22,514
County Rooks 3-7-20W
SW SE SW Sec. 3 Twp. 7 Rge. 20 East West

330 Ft North from Southeast Corner of Section
3630 Ft West from Southeast Corner of Section
(Note: Locate well in section plat below)

Lease Name Ross Well # 2

Field Name Application for new field filed

Producing Formation Lansing "I" & "J"

Elevation: Ground 2141 KB 2146

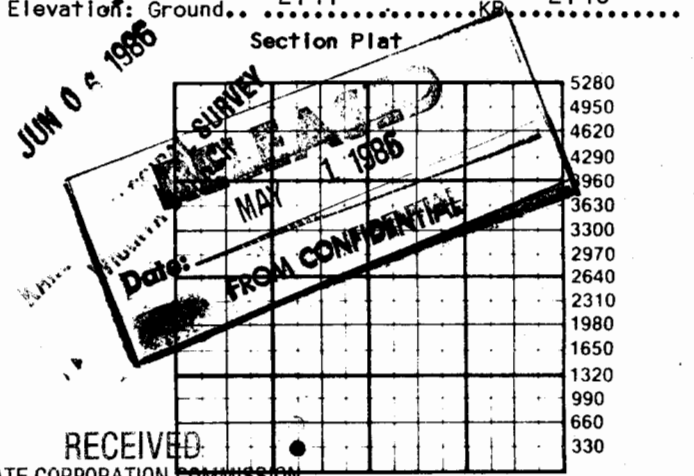

STATE CORPORATION COMMISSION
NOV 14 1984

WATER SUPPLY INFORMATION
Source of Water:
CONSERVATION DIVISION
Division of Water Resources Permit #
Wichita, Kansas

Groundwater 1760 Ft North from Southeast Corner
(Well) 4620 Ft West from Southeast Corner of
Sec 5 Twp 8S Rge 20 East West

Surface Water Ft North from Southeast Corner
(Stream, pond etc) Ft West from Southeast Corner
Sec Twp Rge East West

Other (explain) (purchased from city, R.W.D.#)

Disposition of Produced Water: Disposal Repressuring

Docket # CD-78257

INSTRUCTIONS: This form shall be completed in duplicate and filed with the Kansas Corporation Commission, 200 Colorado Derby Building, Wichita, Kansas 67202, within 90 days after completion or recompletion of any well. Rule 82-3-130 and 82-3-107 apply. Information on side two of this form will be held confidential for a period of 12 months if requested in writing and submitted with the form. See rule 82-3-107 for confidentiality in excess of 12 months. A copy of all wireline logs and drillers time log shall be attached with this form. Submit CP-4 form with plugged wells. Submit CP-111 form with all temporarily abandoned wells.

SIDE TWO

Operator Name Scarth Oil & Gas Lease Name Ross Well # 2 SEC. 3 TWP. 7 RGE. 20 East West

WELL LOG

INSTRUCTIONS: Show important tops and base of formations penetrated. Detail all cores. Report all drill stem tests giving interval tested, time tool open and closed, flowing and shut-in pressures, whether shut-in pressure reached static level, hydrostatic pressures, bottom hole temperature, fluid recovery, and flow rates if gas to surface during test. Attach extra sheet if more space is needed. Attach copy of log.

Drill Stem Tests Taken Yes No
 Samples Sent to Geological Survey Yes No
 Cores Taken Yes No

DST No. 1 -- 3357' to 3375'
 Open 30 mins; shut in 60 mins; open 60 mins; shut in 120 mins. Recovered 80' oil speckled muddy water.
 HH 1744# - 1636#
 IFP 40# - 40# FFP 40# - 50#
 ISIP 951# FSIP 942#

DST No. 2 -- 3504' - 3538'
 Open 30 mins; shut in 60 mins; open 60 mins; shut in 120 mins. Recovered 120' gas in pipe; 30' mud cut oil & 40' clean oil.
 HH 1753' - 1773'
 IFP 40# - 40# FFP 40# - 50#
 ISIP 578# FSIP 628#

DST No. 3 -- 3613' - 3623'
 Open 20 mins; shut in 120 mins; open 30 mins; shut in 60 mins. Recovered 5' sli OCM.
 HH 1911# - 1867#
 IFP 34# - 34# FFP 50# - 50#
 ISIP 320# FSIP 106#

Name	Formation Description	
	Top	Bottom
Anhydrite	1703'	
Topeka	3120'	
Oread	3274'	
Heebner	3325'	
Toronto	3348'	
Lansing	3363'	
Marmaton	3549'	
Arbuckle	3602'	

CASING RECORD <input type="checkbox"/> New <input type="checkbox"/> Used							
Report all strings set-conductor, surface, intermediate, production, etc.							
Purpose of String	Size Hole Drilled	Size Casing Set (in O.D.)	Weight Lbs/Ft.	Setting Depth	Type of Cement	#Sacks Used	Type and Percent Additives
Surface	12-1/4	8-5/8	20#	341	Common	195	2% gel; 3% CC
Production	7-7/8	5-1/2	15-1/2#	3618	SureFill	140	6% Calseal; 4% gel; 1% CC

PERFORATION RECORD		Acid, Fracture, Shot, Cement Squeeze Record	
Shots Per Foot	Specify Footage of Each Interval Perforated	(Amount and Kind of Material Used)	Depth
1	3514-19 (6 holes) 3528-36 (9 holes)	500 gals. MCA 2000 gals. MOD. 202 plus 6 gal. LoSurf. 40# Ferchek & 20 ball sealers	3514' to 3536'

TUBING RECORD	Size 2-3/8"	Set At 3560'	Packer at	Liner Run <input type="checkbox"/> Yes <input checked="" type="checkbox"/> No
---------------	-------------	--------------	-----------	---

Date of First Production	Producing Method <input type="checkbox"/> Flowing <input type="checkbox"/> Pumping <input type="checkbox"/> Gas Lift <input type="checkbox"/> Other (explain).....
	Oil Gas Water Gas-Oil Ratio Gravity