

Ind 10/25/84 KC

STATE CORPORATION COMMISSION OF KANSAS OIL & GAS CONSERVATION DIVISION

WELL COMPLETION OR RECOMPLETION FORM ACO-1 WELL HISTORY

DESCRIPTION OF WELL AND LEASE

Operator: license # 5140 name Frontier Oil Company address 125 N. Market, Ste 1720 City/State/Zip Wichita, Ks, 67202

Operator Contact Person Jean Angle Phone 316-263-1201

Contractor: license # 5302 name Red Tiger Drilling Company

Wellsite Geologist Richard Parker Phone 913-483-5348

PURCHASER Koch Oil Company

Designate Type of Completion [X] New Well [ ] Re-Entry [ ] Workover

- [X] Oil [ ] Gas [ ] Dry [ ] SWD [ ] Inj [ ] Other (Core, Water Supply etc.) [ ] Temp Abd [ ] Delayed Comp.

If WO: old well info as follows: Operator Well Name Comp. Date Old Total Depth

WELL HISTORY

Drilling Method: [X] Mud Rotary [ ] Air Rotary [ ] Cable Spud Date 10-06-84 Date Reached TD 10-14-84 Completion Date 10-25-84 Total Depth 3625' PBTD N/A

Amount of Surface Pipe Set and Cemented at 197.79' @ .205' feet Multiple Stage Cementing Collar Used? [X] Yes [ ] No If Yes, Show Depth Set 1688' feet

If alternate 2 completion, cement circulated from feet depth to w/ SX cmt

API NO. 15-163-22,506 10-7-20W County Rooks NW NW NW Sec 10 Twp 7S Rge 20W 4950 Ft North from Southeast Corner of Section 4950 Ft West from Southeast Corner of Section (Note: locate well in section plat below)

Lease Name Probasco "A" Well# 4 Field Name Probasco Producing Formation Lansing-KC Elevation: Ground 2104' KB 2109'

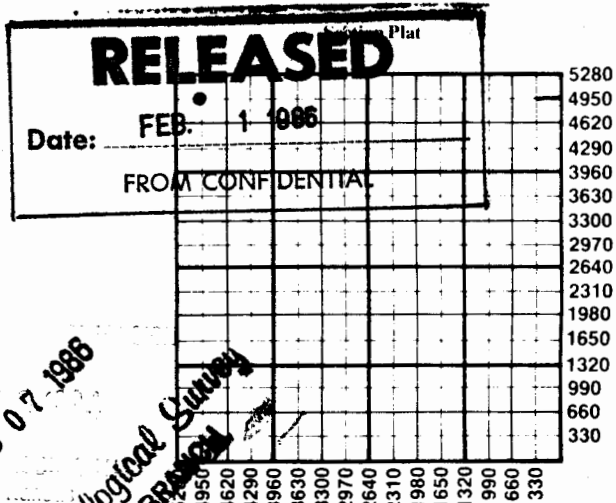

FEB 07 1986 State Geological Survey WICHITA BRANCH

WATER SUPPLY INFORMATION

Source of Water: Stanley Probasco, Stockton, Ks. Division of Water Resources Permit # [ ] Groundwater [X] Surface Water 750 Ft North From Southeast Corner and 1100 Ft West From Southeast Corner Sec 10 Twp 7S Rge 20 [ ] East [X] West (purchased from city, R.W.D.#)

Disposition of Produced Water: [X] Disposal [ ] Repressuring Docket # CD-48236/C-20,839

INSTRUCTIONS: This form shall be completed in duplicate and filed with the Kansas Corporation Commission, 200 Colorado Derby Building, Wichita, Kansas 67202, within 90 days after completion or recompletion of any well. Rules 82-3-130 and 82-3-107 apply.

Information on side two of this form will be held confidential for a period of 12 months if requested in writing and submitted with the form. See rule 82-3-107 for confidentiality in excess of 12 months.

One copy of all wireline logs and drillers time log shall be attached with this form. Submit CP-4 form with all plugged wells. Submit CP-111 form with all temporarily abandoned wells.

# CONFIDENTIAL SIDE TWO

Operator Name Frontier Oil Company Lease Name Probasco A Well# 4 SEC 10 TWP. 7S RGE. 20W  East  West

**WOS-5-01**

## WELL LOG

**INSTRUCTIONS:** Show important tops and base of formations penetrated. Detail all cores. Report all drill stem tests giving interval tested, time tool open and closed, flowing and shut-in pressures, whether shut-in pressure reached static level, hydrostatic pressures, bottom hole temperature, fluid recovery, and flow rates if gas to surface during test. Attach extra sheet if more space is needed. Attach copy of log.

Drill Stem Tests Taken  Yes  No  
 Samples Sent to Geological Survey  Yes  No  
 Cores Taken  Yes  No

**Formation Description**  
 Log  Sample

DST 1 (3354-3374) 60-30-60-30 strg blo both ops  
 Rec 1080' GIP, 1890' CGO IF 90-520 FF 554-694  
 ISI 1128 FSI 1128.

DST 2 (3374-3418) 60-30-60-30 strg blo both ops  
 Rec 90'M, 620' MSW IF 90-226 FF 226-384, ISI 948  
 FSI 903

DST 3 (3468-3486) 60-30-60-30 strg blo both ops  
 Rec 1120' GIP, 1650' CGO, IF 113-486 FF 542-610  
 ISI 681 FSI 655

DST 4 (3488-3508) 150-30 tool malfunctioned fair to  
 strg blo Rec 420' GIP, 90' CGO, 90' MCGO IF 45-102  
 FSI 768

DST 5 (3520-3570) 30-30-30-30 wk blo Rec 10'M  
 IF 57-57 FF 57-57 ISI 193 FSI 113

RTD 3625'

Name	Top	DEPTH
Anhydrite	1672	(+ 437)
Topeka	3090	(- 981)
Heebner	3292	(-1183)
Toronto	3316	(-1207)
Lansing	3330	(-1221)
Base KC	3535	(-1426)
Cherty Cong.	3573	(-1464)
Arbuckle	3611	(-1502)
RTD	3625	(-1516)

<b>TUBING RECORD</b> size 2-3/8" set at 3540' packer at N/A		Liner Run <input type="checkbox"/> Yes <input checked="" type="checkbox"/> No	
Date of First Production 10-25-84	Producing method <input type="checkbox"/> flowing <input checked="" type="checkbox"/> pumping <input type="checkbox"/> gas lift <input type="checkbox"/> Other (explain) .....		
Estimated Production Per 24 Hours	Oil	Gas	Water
	118.20 Bbls	-0- MCF	78.80 Bbls
		Gas-Oil Ratio	Gravity
		N/A CFPB	32.26, 5° Apx.

Disposition of gas:  vented  sold  used on lease

**METHOD OF COMPLETION**  open hole  perforation  other (specify) .....

Dually Completed.  Completed

**PRODUCTION INTERVAL**  
 3369-3374'  
 3480-3486'  
 3495-3501'

Purpose of string	size hole drilled	size casing set (in O.D.)	weight lbs/ft.	setting depth	type of cement	# sacks used	percent additives
Surface	12-1/4"	8-5/8"	20#	205'	Common	160	2% gel 3% cc
FO Tool	"	"	"	1688'	-	-	-
Production	"	"	"	3620'	Common	200	10% salt

PERFORATION RECORD		Acid, Fracture, Shot, Cement Squeeze Record	
shots per foot	specify footage of each interval perforated	(amount and kind of material used)	Depth
4	3369' to 3374'	500 gal. 15% regular	3369-3374'
4	3480' to 3486'	500 gal. 15% regular	3480-3486'
4	3495' to 3501'	500 gal. 15% regular	3495-3501'