

KANSAS DRILLERS LOG

S. 36 T. 7 R. 24 ^{NE}/_W

API No. 15 — 065 — 21,249
County Number

Loc. NE NE SW

County Graham

Operator
Abercrombie Drilling, Inc.

Address
801 Union Center Wichita, Kansas 67202

Well No. #1 Lease Name Keith

Footage Location
2310' feet from (X) (S) line 2310' feet from (X) (W) line

Principal Contractor Abercrombie Drilling, Inc. Geologist Richard Renard

Spud Date 09-17-80 Total Depth 3890' P.B.T.D. 3843'

Date Completed 09-25-80 Oil Purchaser Clear Creek, Inc.

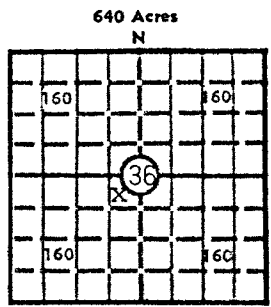

Elev.: Gr. 2374'

DF 2377' KB 2379'

CASING RECORD

Report of all strings set — surface, intermediate, production, etc.

Purpose of string	Size hole drilled	Size casing set (in O.D.)	Weight lbs/ft.	Setting depth	Type cement	Sacks	Type and percent additives
Surface	12-1/4"	8-5/8"	20#	245' K.B.	Common Cement	185	3% c.c., 2% gel.
Production	7 7/8	4 1/2"	10 1/2#	3889'	50/50 posmix common	50 100	2% gel, 12 1/2# gilsin salt saturated

LINER RECORD

PERFORATION RECORD

Top, ft.	Bottom, ft.	Sacks cement	Shots per ft.	Size & type	Depth interval
			4	DP jets	3815 - 3818

TUBING RECORD

Size	Setting depth	Packer set at

ACID, FRACTURE, SHOT, CEMENT SQUEEZE RECORD

Amount and kind of material used	Depth interval treated
1250 gallons of 15% Non-E	3815-3818

INITIAL PRODUCTION

Date of first production 11/9/80 Producing method (flowing, pumping, gas lift, etc.) Pumping

RATE OF PRODUCTION PER 24 HOURS
 Oil 52 bbls. Gas 54 bbls. MCF 54 Gas-oil ratio CFPB

Disposition of gas (vented, used on lease or sold) _____ Producing interval(s) 3815-3818

INSTRUCTIONS: As provided in KCC Rule 82-2-125, within 90 days after completion of a well, one completed copy of this Drillers Log shall be transmitted to the State Geological Survey of Kansas, 4150 Monroe Street, Wichita, Kansas 67209. Copies of this form are available from the Conservation Division, State Corporation Commission, 3830 So. Meridian (P.O. Box 17027), Wichita, Kansas 66217. Phone AC 316-522-2206. If confidential custody is desired, please note Rule 82-2-125. Drillers Logs will be on open file in the Oil and Gas Division, State Geological Survey of Kansas, Lawrence, Kansas 66044.

Operator		DESIGNATE TYPE OF COMP.: OIL, GAS, DRY HOLE, SWDW, ETC.:
Well No. 1	Lease Name Keith	Oil
S 36 T 7S R 24 X W		

WELL LOG

Show all important zones of porosity and contents thereof; cored intervals, and all drill-stem tests, including depth interval tested, cushion used, time tool open, flowing and shut-in pressures, and recoveries.

SHOW GEOLOGICAL MARKERS, LOGS RUN, OR OTHER DESCRIPTIVE INFORMATION.

FORMATION DESCRIPTION, CONTENTS, ETC.	TOP	BOTTOM	NAME	DEPTH
Clay, Sand & Shale	0	247		
Shale & Sand	247	1240	SAMPLE TOPS:	
Shale	1240	1759		
Sand & Shale	1759	1861	Anhydrite	2063' (+ 316')
Shale	1861	2063	B/Anhydrite	2097' (+ 282')
Anhydrite	2063	2097		
Shale	2097	3145		
Shale & Lime	3145	3349		
Lime & Shale	3349	3607		
Shale & Lime	3607	3684		
Lime	3684	3890		
Rotary Total Depth		3890		
DST #1 (3674'-3684') 30", 30", 30", 30" Recovered 5' mud. IFP 20#-20#, IBHP 20#, FFP 20#-20#, FBHP 20#.				
DST #2 (3683'-3720') 30", 30", 30", 30" Weak blow 20", recovered 10' mud. IFP 40#-40#, IBHP 40#, FFP 50#-50#, FBHP 50#.				
DST #3 (3742'-3772') 30", 30", 30", 30" Weak blow 15", 10' mud. IFP 40#-40#, IBHP 60#, FFP 40#-40#, FBHP 50#.				
DST #4 (3775'-3807') Misrun				
DST #5 (3768'-3807') 30", 45", 30", 45" Strong blow. Rec. 360' muddy water with oil spots. IFP 54#-131#, IBHP 1285#, FFP 141#-185#, FBHP 1254#				
DST #6 (3806'-3822') 30", 45", 30", 45" 60' gip, 210' mco, IFP 43#-65#, IBHP 1317#, FFP 87#-109#, FBHP 1243#				
DST #7 (3822'-3836') 30", 30", 30", 30" Weak blow, died. Recovered 20' SOSM, IFP 43#-32#, IBHP 217#, FFP 32#-32#, FBHP 76#				

USE ADDITIONAL SHEETS, IF NECESSARY, TO COMPLETE WELL RECORD.

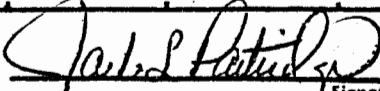
Date Received	 Signature
	Jack L. Partridge, Asst. Sec.-Treas. Title
	10-02-80 Date