

WICHITA BRANCH
KANSAS DRILLERS LOG

IMPORTANT
Kans. Geo. Survey request
samples on this well.

15-065-20971
3-7-25W

S. 3 T. 7 R. 25 E
W

API No. 15 — 065 — 20,971
County Number

Loc. NW SE

County Graham

Operator
Jinkins Oil Co., Inc.

Address
Suite 411, 200 East First Wichita, Kansas 67202

Well No. <u>#1</u>	Lease Name <u>Dugan</u>
-----------------------	----------------------------

Footage Location
660 feet from (NO (S) line ~~660~~ 1980 feet from (E) (SW) line

Principal Contractor <u>Emphasis Oil Operations</u>	Geologist <u>R., B. Jinkins</u>
--	------------------------------------

Spud Date <u>12-5-77</u>	Total Depth <u>3910'</u>	P.B.T.D.
-----------------------------	-----------------------------	----------

Date Completed	Oil Purchaser
----------------	---------------

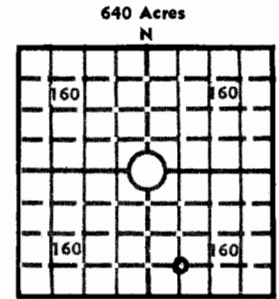

Elev.: Gr. 2509'

DF 2511' KB 2514'

CASING RECORD

Report of all strings set — surface, intermediate, production, etc.

Purpose of string	Size hole drilled	Size casing set (in O.D.)	Weight lbs/ft.	Setting depth	Type cement	Sacks	Type and percent additives
Surface	12"	8-5/8"		258'	Common	175	2% ca gel 3% Cl.

LINER RECORD

PERFORATION RECORD

Top, ft.	Bottom, ft.	Sacks cement	Shots per ft.	Size & type	Depth interval

TUBING RECORD

Size	Setting depth	Packer set at

ACID, FRACTURE, SHOT, CEMENT SQUEEZE RECORD

Amount and kind of material used	Depth interval treated

INITIAL PRODUCTION

Date of first production		Producing method (flowing, pumping, gas lift, etc.)			
RATE OF PRODUCTION PER 24 HOURS	Oil bbis.	Gas MCF	Water bbis.	Gas-oil ratio CFPB	
Disposition of gas (vented, used on lease or sold)			Producing interval (s)		

INSTRUCTIONS: As provided in KCC Rule 82-2-125, within 90 days after completion of a well, one completed copy of this Drillers Log shall be transmitted to the State Geological Survey of Kansas, 4150 Monroe Street, Wichita, Kansas 67209. Copies of this form are available from the Conservation Division, State Corporation Commission, 3830 So. Meridian (P.O. Box 17027), Wichita, Kansas 66217. Phone AC 316-522-2206. If confidential custody is desired, please note Rule 82-2-125. Drillers Logs will be on open file in the Oil and Gas Division, State Geological Survey of Kansas, Lawrence, Kansas 66044.

Operator
JINKINS OIL COMPANY, INC.

DESIGNATE TYPE OF COMP.: OIL, GAS,
DRY HOLE, SWD, ETC.:
DRY HOLE

Well No. 1 Lease Name
Dugan

S 3 T 7S R 25 ^{BK} W

WELL LOG

Show all important zones of porosity and contents thereof; cored intervals, and all drill-stem tests, including depth interval tested, cushion used, time tool open, flowing and shut-in pressures, and recoveries.

SHOW GEOLOGICAL MARKERS, LOGS RUN,
OR OTHER DESCRIPTIVE INFORMATION.

FORMATION DESCRIPTION, CONTENTS, ETC.	TOP	BOTTOM	NAME	DEPTH
Surface soil and shale	0	266	Electra, Inc.	GR-G-N-C
Shale	266	1597	Anhydrite	2147
Sand and Shale	1997	1925	Heebner	3668
Shale	1925	2148	Toronto	3680
Anhydrite	2148	2181	Lansing	3698
Shale	2181	2694	BKC	3893
Shale and lime	2694	3130	TD	3905
Lime and shale	3130	3635		
Shale and lime	3635	3760		
Lime	3760	3786		
Lime and shale	3786	3804		
Lime	3804	3910		

USE ADDITIONAL SHEETS, IF NECESSARY, TO COMPLETE WELL RECORD.

Date Received

Robert B. Jenkins
Signature

President

Title

12-20-77

Date