

KANSAS DRILLERS LOG

S. 2 T. 7S R. 27W E
W

API No. 15 — 179 — 20,491
County Number

Loc. NE SE NE

County Sheridan

Operator
National Oil Company

Address
200 W. Douglas, Suite 550, Wichita, Ks. 67202

Well No. 1 Lease Name
Sniffen

Footage Location
990 feet from (N) (S) line 330 feet from (E) (W) line

Principal Contractor John O. Farmer Geologist Jay Dirks

Spud Date January 14, 1978 Total Depth 4,090 P.B.T.D.

Date Completed January 25, 1978 Oil Purchaser

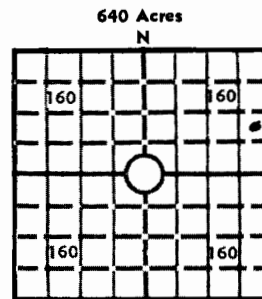

Elev.: Gr. 2,678

DF 2,680 KB 2,683

CASING RECORD

Report of all strings set — surface, intermediate, production, etc.

Purpose of string	Size hole drilled	Size casing set (in O.D.)	Weight lbs/ft.	Setting depth	Type cement	Sacks	Type and percent additives
Surface	12 1/4	8-5/8	26	283	Common	190	

LINER RECORD

PERFORATION RECORD

Top, ft.	Bottom, ft.	Sacks cement	Shots per ft.	Size & type	Depth interval

TUBING RECORD

Size	Setting depth	Packer set at

ACID, FRACTURE, SHOT, CEMENT SQUEEZE RECORD

Amount and kind of material used	Depth interval treated

INITIAL PRODUCTION

Date of first production		Producing method (flowing, pumping, gas lift, etc.)			
RATE OF PRODUCTION PER 24 HOURS	Oil bbls.	Gas MCF	Water bbls.	Gas-oil ratio	CFPB
Disposition of gas (vented, used on lease or sold)			Producing interval (s)		

INSTRUCTIONS: As provided in KCC Rule 82-2-125, within 90 days after completion of a well, one completed copy of this Drillers Log shall be transmitted to the State Geological Survey of Kansas, 4150 Monroe Street, Wichita, Kansas 67209. Copies of this form are available from the Conservation Division, State Corporation Commission, 3830 So. Meridian (P.O. Box 17027), Wichita, Kansas 66217. Phone AC 316-522-2206. If confidential custody is desired, please note Rule 82-2-125. Drillers Logs will be on open file in the Oil and Gas Division, State Geological Survey of Kansas, Lawrence, Kansas 66044.

Operator National Oil Company		DESIGNATE TYPE OF COMP.: OIL, GAS, DRY HOLE, SWDW, ETC.: Dry
Well No. 1	Lease Name Sniffen	
S <u>2</u> T <u>7S</u> R <u>27</u> ^E W NE SE NE Sheridan County, Kansas		

WELL LOG

Show all important zones of porosity and contents thereof; cored intervals, and all drill-stem tests, including depth interval tested, cushion used, time tool open, flowing and shut-in pressures, and recoveries.

SHOW GEOLOGICAL MARKERS, LOGS RUN, OR OTHER DESCRIPTIVE INFORMATION.

FORMATION DESCRIPTION, CONTENTS, ETC.	TOP	BOTTOM	NAME	DEPTH
DST #1, 3863-80'; 30-30-60-60; Rec 70' thin mud w/SSO, 60' WM, 300' W; ISIP 1279; FSIP 1247 IFP 73-94; FFP 126-210; T 112°.			<u>Log Tops</u> Heebner	3814 -1131
DST #2, 3879-3920'; 30-30-60-60; Rec 1320' fluid of which 240' CGO, 300' M&WCGO; 120' SOCWM, 60' VSOCW, 600' SW; ISIP 1303; FSIP 1284; IFP 82-164; FFP 201-613; T 113°.			Toronto Lansing B/Kansas City	3841 -1158 3857 -1174 4061 -1378
DST #3, 3923-38'; 30-30-30-30; Rec 15' mud; ISIP 1310; FSIP 1289; IFP 63-63; FFP 63-63.			RTD	4090 -1407
DST #4, 3997-4027'; 30-30-30-30; Rec 20' oil spk mud; ISIP 84; FSIP 73; IFP 63-63; FFP 63-63; T 114°.			LTD	4087 -1404
DST #5, (Straddle test), 3863-91'; 30-30-60-60; Rec 45' GO; 300' G&OCM, 420' GOCMW, 300' W; ISIP 1331; FSIP 1321; IFP 105-253; FFP 337-527.				

USE ADDITIONAL SHEETS, IF NECESSARY, TO COMPLETE WELL RECORD.

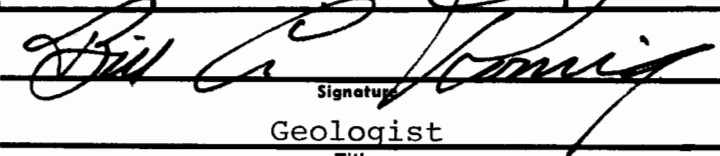
Date Received	 Signature Geologist Title February 24, 1978 Date
---------------	--

09909