

KANSAS DRILLERS LOG

State Geological Survey
WICHITA, KANSAS
MAR 17 1977

API No. 15 — 193 — 20,093
County Number

S. 24 T. 7 R. 31 $\frac{1}{2}$ W
Loc. C NE NW
County Thomas

Operator
Gulf Oil Corp.

Address
P. O. Box 12116 Oklahoma City, Oklahoma 73112

Well No. #1-24 Lease Name E. L. McCormick

Footage Location
660' SNL feet from (N) (S) line 660' WEL feet from (E) (W) line

Principal Contractor Rains and Williamson Geologist H. O. Arnold

Spud Date 10/14/76 Total Depth 4325' P.B.T.D. 4269'

Date Completed 12/7/76 Oil Purchaser Koch

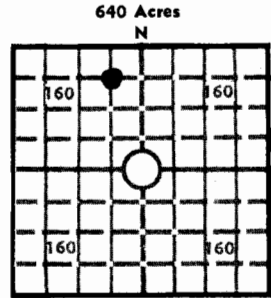

Elev.: Gr. 2927'

DF KB 2932'

MAR 17 1976

CASING RECORD

Report of all strings set — surface, intermediate, production, etc.

Purpose of string	Size hole drilled	Size casing set (in O.D.)	Weight lbs/ft.	Setting depth	Type cement	Sacks	Type and percent additives
Surface	12-1/4"	8-5/8"	24	414'	60/40 Poz Class A	250	2% gel, 3% cc
Production	7-7/8"	5-1/2"	14	4309'	50/50 Poz	200	2% gel, 1% salt 3/4 of 1% CFR

LINER RECORD

PERFORATION RECORD

Top, ft.	Bottom, ft.	Sacks cement	Shots per ft.	Size & type	Depth interval
None			4	3-5/8" Golden Jet Gun	4170-78'

Size	Setting depth	Packer set at
2-3/8"	4198'	-----

ACID, FRACTURE, SHOT, CEMENT SQUEEZE RECORD

Amount and kind of material used	Depth interval treated
1000 gals 15% acid w/emulsifier & inhibitor	4170-78'

INITIAL PRODUCTION

Date of first production 12/7/76	Producing method (flowing, pumping, gas lift, etc.) Pumping			
RATE OF PRODUCTION PER 24 HOURS	Oil 25 bbls.	Gas TSTM MCF	Water 0 bbls.	Gas-oil ratio ---- CFPB
Disposition of gas (vented, used on lease or sold) ----			Producing interval(s) 4170-78'	

INSTRUCTIONS: As provided in KCC Rule 82-2-125, within 90 days after completion of a well, one completed copy of this Drillers Log shall be transmitted to the State Geological Survey of Kansas, 4150 Monroe Street, Wichita, Kansas 67209. Copies of this form are available from the Conservation Division, State Corporation Commission, 3830 So. Meridian (P.O. Box 17027), Wichita, Kansas 66217. Phone AC 316-522-2206. If confidential custody is desired, please note Rule 82-2-125. Drillers Logs will be on open file in the Oil and Gas Division, State Geological Survey of Kansas, Lawrence, Kansas 66044.

Operator

Gulf Oil Corporation

DESIGNATE TYPE OF COMP.: OIL, GAS, DRY HOLE, SWDW, ETC.:

Well No.

1-24

Lease Name

E. L. McCormick

Oil

S 24 T 7S R 31W E W

WELL LOG

Show all important zones of porosity and contents thereof; cored intervals, and all drill-stem tests, including depth interval tested, cushion used, time tool open, flowing and shut-in pressures, and recoveries.

SHOW GEOLOGICAL MARKERS, LOGS RUN, OR OTHER DESCRIPTIVE INFORMATION.

FORMATION DESCRIPTION, CONTENTS, ETC.	TOP	BOTTOM	NAME	DEPTH
Clay	40'			
Sand	195'			
Shale	1980'			
Sand	2010'			
Shale	2084'			
Shale and Redbed	2580'			
Redbed and Shale	2845'			
Shale	3710'			
Shale and Lime	3810'			
Lime	4325'			

USE ADDITIONAL SHEETS, IF NECESSARY, TO COMPLETE WELL RECORD.

Date Received

C. H. Groen

Signature

C. H. Groen, Area Engineer

Title

12/17/76

Date