

State Geological Survey

WICHITA BRANCH

IMPORTANT
Kans. Geo. Survey request
samples on this well.

15-193-20170

KANSAS DRILLERS LOG

API No. 15 — 193 — 20,170
County Number

Operator
D. G. Hansen Trust

Address
P. O. Box 187 Logan, Kansas 67646

Well No. # 1 Lease Name Davis

Footage Location
660 feet from (RD) (S) line 660 feet from (E) (W) line

Principal Contractor Abercrombie Drilling, Inc. Geologist J. E. Jespersen

Spud Date 8-23-78 Total Depth 4921 P.B.T.D.

Date Completed 9-3-78 Oil Purchaser

S. 27 T. 7 R. 36 ^K_W
Loc. SE SE
County Thomas

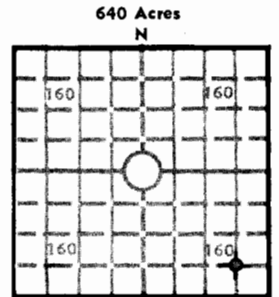

Elev.: Gr. 3365

DF 3367 KB 3370

CASING RECORD

Report of all strings set — surface, intermediate, production, etc.

Purpose of string	Size hole drilled	Size casing set (in O.D.)	Weight lbs/ft.	Setting depth	Type cement	Sacks	Type and percent additives
Surface	12 1/4"	8 5/8"	28#	346.63	60/40 Poz	235	3% cc, 2% gel

LINER RECORD

PERFORATION RECORD

Top, ft.	Bottom, ft.	Sacks cement	Shots per ft.	Size & type	Depth interval

TUBING RECORD

Size	Setting depth	Packer set at

ACID, FRACTURE, SHOT, CEMENT SQUEEZE RECORD

Amount and kind of material used	Depth interval treated

INITIAL PRODUCTION

Date of first production	Producing method (flowing, pumping, gas lift, etc.)				
RATE OF PRODUCTION PER 24 HOURS	Oil	Gas	Water	Gas-oil ratio	
	bbls.	MCF	bbls.	CFPB	
Disposition of gas (vented, used on lease or sold)			Producing interval(s)		

INSTRUCTIONS: As provided in KCC Rule 82-2-125, within 90 days after completion of a well, one completed copy of this Drillers Log shall be transmitted to the State Geological Survey of Kansas, 4150 Monroe Street, Wichita, Kansas 67209. Copies of this form are available from the Conservation Division, State Corporation Commission, 3830 So. Meridian (P.O. Box 17027), Wichita, Kansas 66217. Phone AC 316-522-2206. If confidential custody is desired, please note Rule 82-2-125. Drillers Logs will be on open file in the Oil and Gas Division, State Geological Survey of Kansas, Lawrence, Kansas 66044.

Operator **The Dane G. Hansen Trust** DESIGNATE TYPE OF COMP.: OIL, GAS, DRY HOLE, SWDW, ETC.: **Dry**

Well No. **#1** Lease Name **Davis**

S 3 T 27 R 27 W

WELL LOG

Show all important zones of porosity and contents thereof; cored intervals, and all drill-stem tests, including depth interval tested, cushion used, time tool open, flowing and shut-in pressures, and recoveries.

SHOW GEOLOGICAL MARKERS, LOGS RUN, OR OTHER DESCRIPTIVE INFORMATION.

FORMATION DESCRIPTION, CONTENTS, ETC.	TOP	BOTTOM	NAME	DEPTH
SAND	0	100	Blaine Anhy.	2620
SAND & SHALE	100	2206	S. C. Anhy.	2938
SHALE & SAND	2206	2450	B/S. C. Anhy.	2972
SHALE & SHELLS	2450	2942	B/Chase Grp.	3265
ANHYDRITE	2942	2975	Neva	3594
SHALE & RED BEDS	2975	3062	Wabaunsee	3764
SHALE & LIME	3062	4029	Tarkio	3849
LIME & SHALE	4029	4258	Heebner	4162
SHALE & LIME	4258	4312	Toronto	4191
LIME & SHALE	4312	4450	Lansing	4207
SHALE & LIME	4450	4606	B/Kansas City	4508
SHALE & LIME	4606	4620	Marmaton	4524
LIME	4620	4730	Fort Scott	4640
SHALE & LIME	4730	4797	Cherokee	4665
LIME & RTD	4797	4921	B/Cher Lm	4770
			B/Penn Sd	4820
			Mississippi	4882
			LTD	4920

DST #1 - 4198-4258. 15-45-75-45.
Weak Steady blow thruout. Rec. 125' Mdy SW
SIP 1338/1285. FP 55/55.
DST #2 - 4269-4334. 15-45-45-45.
Good blow thruout. Rec. 1200' SW.
SIP 1360/1338. FP 87/262.
DST #3 - 4375-4450. 15-45-30-45.
Weak blow died in 10". Rec. 10' Mud.
SIP 164/218. FP 65/65
DST #4 - 4554-4620. 15-45-30-45.
Weak blow died in 13". Rec. 15' Mud.
SIP 1317/1232. FP 65/65.
DST #5 - 4719-4815. 15-45-75-45.
Weak steady blow thruout. Rec. 125' Drg. Mud,
60' Wtry Mud. SIP 1530/1351. FP 87/109.

USE ADDITIONAL SHEETS, IF NECESSARY, TO COMPLETE WELL RECORD.

Date Received	<i>Jan 1 Burt</i>
	Signature
	Manager
	Title
	September 22, 1978
	Date

State Geological Survey

OPERATOR A BRANCH
 CONTRACTOR:
 WELL NAME:
 LOCATION:
 SPUD DATE:
 COMPLETION DATE:

Dane G. Hansen Trust
 Abercrombie Drilling, Inc.
 Davis #1
 SE SE Section ~~27-7S-36W~~
 Thomas County, Kansas
 August 23, 1978
 September 3, 1978

0	100	Sand
100	2206	Sand & shale
2206	2450	Shale & sand
2450	2942	Shale & shells
2942	2975	Anhydrite
2975	3062	Shale & red beds
3062	4029	Shale & lime
4029	4258	Lime & shale
4258	4312	Shale & lime
4312	4450	Lime & shale
4450	4606	Shale & lime
4606	4620	Shale & lime
4620	4730	Lime
4730	4797	Shale & lime
4797	4921	Lime
	4921	Rotary Total Depth

Spud hole August 23, 1978. Drilled 350' of 12¼" hole. Ran 9 joints of 8-5/8" - 28# surface casing. Set at 346.63' K.B. with 235 sacks of 60-40 posmix, 3% CaCl, 2% gel. Cement did circulate. Plug was down at 7:00 p.m., August 23, 1978.

T.D. 4921'. Set first plug at 1850' with 70 sacks, second plug at 300' with 20 sacks, third plug at 40' with 10 sacks. Cemented with 50-50 posmix, 6% gel. Job was complete at 2:30 a.m., September 3, 1978. State Plugger, Leo Massey.

SAMPLE TOPS:

Anhydrite 2943' (+427)
 B/Anhydrite 2975' (+395)