

15-8-14W

**KANSAS DRILLERS LOG**

State Geological Survey  
WICHITA, BRANCH

API No. 15 - 41 - 30009-0001 0WWO  
County Number

S. 15 T. 8 R. 14<sup>K</sup><sub>W</sub>  
Loc. C NE SW  
County Osborne

Operator  
**Petroleum Management, Inc.**

Address **1515 Vickers KSB&T Building  
Wichita, Kansas**

Well No. #1 Lease Name Spears

Footage Location 1980 South 1980 West  
feet from (N) (S) line feet from (E) (W) line

Principal Contractor Red Tiger Drilling Company Geologist

Spud Date 7-11-73 (Washout Old Well) Total Depth 2975' P.B.T.D.

Date Completed 8-10-73 Abandoned Oil Purchaser

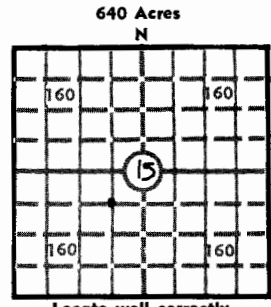

Elev.: Gr. \_\_\_\_\_  
DF 1873 KB \_\_\_\_\_

**CASING RECORD**

Report of all strings set — surface, intermediate, production, etc.

Purpose of string	Size hole drilled	Size casing set (in O.D.)	Weight lbs/ft.	Setting depth	Type cement	Sacks	Type and percent additives
Surface Csg		10-3/4"		289'			BY CARTER OIL CO. - 1948
Prod. Csg		4-1/2"	9.5#	2933'	Pozmix	50	4% Gel
					Common	150	

**LINER RECORD**

**PERFORATION RECORD**

Top, ft.	Bottom, ft.	Sacks cement	Shots per ft.	Size & type	Depth interval
			2	Deep Penetrating	2812-20
			2	" "	2733-37
			1	" "	2617
			2	" "	2556-60

**ACID, FRACTURE, SHOT, CEMENT SQUEEZE RECORD**

Amount and kind of material used	Depth interval treated
250 gal MCA	2812-20
1000 gal Non E	2812-20
200 sx common cement - squeeze	2617

**INITIAL PRODUCTION**

Date of first production None Producing method (flowing, pumping, gas lift, etc.)

RATE OF PRODUCTION PER 24 HOURS	Oil	Gas	Water	Gas-oil ratio
	bbls.	MCF	bbls.	CFPB
Disposition of gas (vented, used on lease or sold)	Producing interval (s)			

INSTRUCTIONS: As provided in KCC Rule 82-2-125, within 90 days after completion of a well, one completed copy of this Drillers Log shall be transmitted to the State Geological Survey of Kansas, 4150 Monroe Street, Wichita, Kansas 67209. Copies of this form are available from the Conservation Division, State Corporation Commission, 3830 So. Meridian (P.O. Box 17027), Wichita, Kansas 66217. Phone AC 316-522-2206. If confidential custody is desired, please note Rule 82-2-125. Drillers Logs will be on open file in the Oil and Gas Division, State Geological Survey of Kansas, Lawrence, Kansas 66044.

Operator PETROLEUM MANAGEMENT, INC.

DESIGNATE TYPE OF COMP.: OIL, GAS, DRY HOLE, SWDW, ETC.:

DRY HOLE

Well No. #1

Lease Name SPEARS

S 15 T 8 S R 14 W E W

WELL LOG

Show all important zones of porosity and contents thereof; cored intervals, and all drill-stem tests, including depth interval tested, cushion used, time tool open, flowing and shut-in pressures, and recoveries.

SHOW GEOLOGICAL MARKERS, LOGS RUN, OR OTHER DESCRIPTIVE INFORMATION.

FORMATION DESCRIPTION, CONTENTS, ETC.	TOP	BOTTOM	NAME	DEPTH
Wash Down of well drilled by Carter Oil Company March, 1943.			H. H. Neuschwaner #1	

USE ADDITIONAL SHEETS, IF NECESSARY TO COMPLETE WELL RECORD.

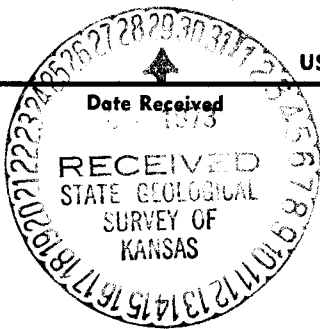

*Dale Silcott*  
 Dale Silcott Signature  
 Vice President Title  
 9-25-73 Date