

KANSAS

State Geological Survey

WELL COMPLETION REPORT AND
DRILLER'S LOG

WICHITA BRANCH

API No. 15 — 163 — 21,131
County NumberS. 20 T. 8S R. 17W
Loc. 1330' FN 380' FW
County Rooks

Operator

The Two Way Oil Company

Address

407 S. Main Plainville, Kansas 67663

Well No.

4

Lease Name

Stamper A

Footage Location

1330 feet from (N) (S) line 1310 940 feet from (E) (W) line 380

Principal Contractor

Lawrence Drilling Inc.

Geologist

Eric Madell

Spud Date

9/5-80

Date Completed

9/10-80

Total Depth

3368

P.B.T.D.

3351

Directional Deviation

Oil and/or Gas Purchaser

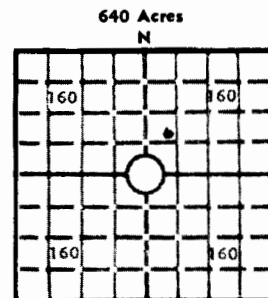

Locate well correctly

Elev.: Gr. 1881DF 1882 KB 1886

CASING RECORD

Report of all strings set — surface, intermediate, production, etc.

Purpose of string	Size hole drilled	Size casing set (in O.D.)	Weight lbs/ft.	Setting depth	Type cement	Sacks	Type and percent additives
<u>Surface</u>	<u>12 1/4"</u>	<u>8 5/8"</u>	<u>28 7/8</u>	<u>150</u>	<u>Common</u>	<u>60</u>	<u>3% cc 2% gel</u>
<u>Long String</u>	<u>7 7/8"</u>	<u>4 1/2"</u>	<u>10 1/2</u>	<u>3367</u>	<u>60/40 Poz</u>	<u>150</u>	<u>8% Salt 4% cc 1% gel</u>

LINER RECORD

PERFORATION RECORD

Top, ft.	Bottom, ft.	Sacks cement	Shots per ft.	Size & type	Depth interval
			<u>4</u>	<u>3/8"</u>	<u>3328-34</u>
			<u>4</u>	<u>3/8"</u>	<u>3152-60</u>

ACID, FRACTURE, SHOT, CEMENT SQUEEZE RECORD

Amount and kind of material used	Depth interval treated
<u>2,000 Gal 28% Acid</u>	<u>3328-34</u>
<u>1,000 Gal 15% reg acid</u>	<u>3152-60</u>

INITIAL PRODUCTION

Date of first production 10/24-80		Producing method (flowing, pumping, gas lift, etc.) Pumping			
Rate of production per 24 hours	Oil 40	Gas bbls.	Water MCF	Gas-oil ratio bbls.	CFPB
Disposition of gas (vented, used on lease or sold) Vented			Producing interval (s) Calculus 3328-34 - 1. Kc. 315		

INSTRUCTIONS: As provided in KCC Rule 82-2-125, within 90 days after completion of a well, one completed copy of this Drillers Log shall be transmitted to the State Geological Survey of Kansas, 4150 Monroe Street, Wichita, Kansas 67209. Copies of this form are available from the Conservation Division, State Corporation Commission, 245 No. Water, Wichita, Kansas 67202. Phone AC 316-522-2206. If confidential custody is desired, please note Rule 82-2-125. Drillers Logs will be on open file in the Oil and Gas Division, State Geological Survey of Kansas, Lawrence, Kansas 66044.

Operator <u>The Laro relay oil Co.</u>		DESIGNATE TYPE OF COMP.: OIL, GAS, DRY HOLE, SWDW, ETC.: <u>oil</u>
Well No. <u>H-14</u>	Lease Name <u>Stanger</u>	
S <u>20</u> T <u>8</u> R <u>17</u> W <u>W</u>		

WELL LOG			SHOW GEOLOGICAL MARKERS, LOGS RUN, OR OTHER DESCRIPTIVE INFORMATION.	
Show all important zones of porosity and contents thereof; cored intervals, and all drill-stem tests, including depth interval tested, cushion used, time tool open, flowing and shut-in pressures, and recoveries.				
FORMATION DESCRIPTION, CONTENTS, ETC.	TOP	BOTTOM	NAME	DEPTH
			<u>Topeka</u>	<u>2804 - 915</u>
			<u>Heebner</u>	<u>3016 - 1127</u>
			<u>Toronto</u>	<u>3038 - 1149</u>
			<u>L.K.C.</u>	<u>3058 - 1169</u>
			<u>B.H.L.</u>	<u>3284 - 1395</u>
			<u>Marmaton SD</u>	<u>3289 - 1400</u>
			<u>Simpson</u>	<u>3316 - 1427</u>
			<u>Osborne</u>	<u>3323 - 1434</u>
USE ADDITIONAL SHEETS, IF NECESSARY, TO COMPLETE WELL RECORD.				

Date Received	<u>Thomas E. Brown</u> Signature <u>Partner</u> Title <u>1/20-81</u> Date
---------------	--