

15-163-20859

State Geological Survey  
WICHITA BRANCH  
KANSAS DRILLERS LOG

**IMPORTANT**  
Kans. Geo. Survey request  
samples on this well.

S. 23 T. 8S R. 17W <sup>E</sup> <sub>W</sub>  
Loc. SW NE SE  
County Rooks

API No. 15 — 163 — 20859  
County Number  
Operator Ruggels Chesney Co.  
Address Box 254 Natoma, Ks. 67651  
Well No. # 1 Lease Name Harrison  
Footage Location  
feet from (N) (S) line feet from (E) (W) line  
Principal Contractor Lawbance Drilling, Inc. Geologist Jerry Green  
Spud Date 10-19-78 Total Depth 3,483 P.B.T.D.  
Date Completed 10-28-78 Oil Purchaser

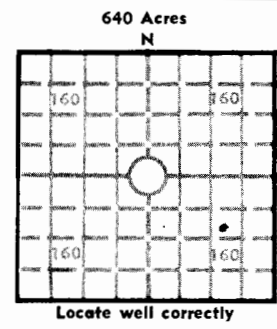

Elev.: Gr. \_\_\_\_\_  
DF \_\_\_\_\_ KB 1973

**CASING RECORD**

Report of all strings set — surface, intermediate, production, etc.

Purpose of string	Size hole drilled	Size casing set (in O.D.)	Weight lbs/ft.	Setting depth	Type cement	Sacks	Type and percent additives
Surface	12 1/2	8 5/8	23#	290	Quick-set	170	1% gel
Production		4 1/2	10 1/2 #	3218	Common	200 1/4	per cent

**LINER RECORD**

**PERFORATION RECORD**

Top, ft.	Bottom, ft.	Sacks cement	Shots per ft.	Size & type	Depth interval
			4	3/8 perf.	3202-05
<b>TUBING RECORD</b>					
Size	Setting depth	Packer set at			
2 3/8	3373				3214-15 3271-75 3289-94 3350-53

**ACID, FRACTURE, SHOT, CEMENT SQUEEZE RECORD**

Amount and kind of material used	Depth interval treated
500 gal mud 15% NE acid	3271-3253
5000 gal 28% demulsion acid	3202-3253

**INITIAL PRODUCTION**

Date of first production 1-20-79 Producing method (flowing, pumping, gas lift, etc.) pumping  
RATE OF PRODUCTION PER 24 HOURS  
Oil 18 bbls. Gas none MCF Water 24 bbls. Gas-oil ratio \_\_\_\_\_ CFPB  
Disposition of gas (vented, used on lease or sold) vented Producing interval(s) 3202-05-14-15-71-75

INSTRUCTIONS: As provided in KCC Rule 82-2-125, within 90 days after completion of a well, one completed copy of this Drillers Log shall be transmitted to the State Geological Survey of Kansas, 4150 Monroe Street, Wichita, Kansas 67209. Copies of this form are available from the Conservation Division, State Corporation Commission, 3830 So. Meridian (P.O. Box 17027), Wichita, Kansas 66217. Phone AC 316-522-2206. If confidential custody is desired, please note Rule 82-2-125. Drillers Logs will be on open file in the Oil and Gas Division, State Geological Survey of Kansas, Lawrence, Kansas 66044.

Operator Ruggels-Chesney Company DESIGNATE TYPE OF COMP.: OIL, GAS, DRY HOLE, SWDW, ETC.:

Well No. Harrison #1 Lease Name Harrison Lease

S 23 T 8 R 17 <sup>E</sup><sub>W</sub>

**WELL LOG**

Show all important zones of porosity and contents thereof; cored intervals, and all drill-stem tests, including depth interval tested, cushion used, time tool open, flowing and shut-in pressures, and recoveries.

SHOW GEOLOGICAL MARKERS, LOGS RUN, OR OTHER DESCRIPTIVE INFORMATION.

FORMATION DESCRIPTION, CONTENTS, ETC.	TOP	BOTTOM	NAME	DEPTH
Rock-Shale-Shells	0	320		
Shale	320	400		
Shale and Lime	400	1,256		
Anhy	1256	1,288		
Shale	1288	1,570		
Shale and Lime	1570	1,760		
Lime and Shale	1760	1,945		
Lime	1945	2,235		
Lime and Shale	2235	2,840		
Lime	2840	3,483		

USE ADDITIONAL SHEETS, IF NECESSARY, TO COMPLETE WELL RECORD.

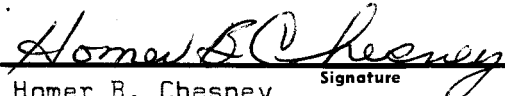
Date Received	 _____ Homer B. Chesney <span style="float: right;">Signature</span> _____ Field Superintendent <span style="float: right;">Title</span> _____ December 19, 1978 _____ <span style="float: right;">Date</span>
---------------	--