

JUL

IMPORTANT
Kans. Geo. Survey request
samples on this well.

KANSAS

**WELL COMPLETION REPORT AND
DRILLER'S LOG**

State Geological Survey

TIGHT

S. 14 T. 8 R. 18 W
Loc. SE SW SE

API No. 15 — 163 County — WICHITA Number 21,213

County Rooks

Operator
F & M Oil Co., Inc.

Address
422 Union Center Wichita, Kansas 67202

Well No. #1 Lease Name Russ

Footage Location
990 feet from 3950 (S) line 330 feet from (E) line

Principal Contractor
Abercrombie Drilling Geologist Roger Fisher

Spud Date 2-13-81 Date Completed 2-23-81 Total Depth 3423' P.B.T.D.

Directional Deviation Oil and/or Gas Purchaser

CONFIDENTIAL

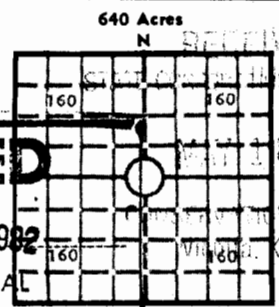

RELEASED

APR 30 1982

FROM CONFIDENTIAL

Locate well correctly
Elev.: Gr. 1946
DF KB 1950

CASING RECORD

Report of all strings set — surface, intermediate, production, etc.

Purpose of string	Size hole drilled	Size casing set (in O.D.)	Weight lbs/ft.	Setting depth	Type cement	Sacks	Type and percent additives
Surface	12 1/2"	8-5/8"		207'	common	150	2% gel., 3% CC
Production		4 1/2"		3421'	posmix	100	60/40 2% gel 3%

LINER RECORD

PERFORATION RECORD

Top, ft.	Bottom, ft.	Sacks cement	Shots per ft.	Size & type	Depth interval
			1		3294', 3309', 3333'

TUBING RECORD

Size	Setting depth	Packer set at

ACID, FRACTURE, SHOT, CEMENT SQUEEZE RECORD

Amount and kind of material used	Depth interval treated
2500 gal. 28% acid, -	3294, 3308, 3333

INITIAL PRODUCTION

Date of first production April 1, 1981	Producing method (flowing, pumping, gas lift, etc.) Pumping
RATE OF PRODUCTION PER 24 HOURS	Oil 20 bbls. Gas MCF Water Gas-oil ratio CFPB
Disposition of gas (vented, used on lease or sold)	Producing interval (s)

INSTRUCTIONS: As provided in KCC Rule 82-2-125, within 90 days after completion of a well, one completed copy of this Drillers Log shall be transmitted to the State Geological Survey of Kansas, 4150 Monroe Street, Wichita, Kansas 67209. Copies of this form are available from the Conservation Division, State Corporation Commission, 245 No. Water, Wichita, Kansas 67202. Phone AC 316-522-2206. If confidential custody is desired, please note Rule 82-2-125. Drillers Logs will be on an open file in the Oil and Gas Division, State Geological Survey of Kansas, Lawrence, Kansas 66044.

DESIGNATE TYPE OF COMP.: OIL, GAS, DRY HOLE, SWDW, ETC.:

Operator F & M OIL CO., INC.		
Well No. 1	Lease Name Russ	Oil
S 14 T 8S R 18W E W		

WELL LOG

Show all important zones of porosity and contents thereof; cored intervals, and all drill-stem tests, including depth interval tested, cushion used, time tool open, flowing and shut-in pressures, and recoveries.

SHOW GEOLOGICAL MARKERS, LOGS RUN, OR OTHER DESCRIPTIVE INFORMATION.

FORMATION DESCRIPTION, CONTENTS, ETC.	TOP	BOTTOM	NAME	DEPTH
DST#1 3002-3160, 45-45-45-45, recovered 80' mud, 120' watery mud. FP's 109-173, SIP's 1036-1009.			<u>SAMPLE TOPS:</u> Anhydrite	1328 (+ 622)
DST#2 3178-3205, 45-45-45-45. Recovered 130' muddy water. FP's 64-119, SIP's 1000-954.			B/Anhydrite	1363 (+ 587)
DST#3 3278-3356, 30-30-30-30. Weak 25" blow, recovered 180' heavy oil cut mud. FP's 91-146, SIP's 990-963.			Topeka	2884 (- 934)
DST#4 3356-83, 30-30-30-30. 12" blow, recovered 5' mud. FP's 60-60, SIP's 72-60.			Heebner	3095 (-1145)
DST#5 3355-96, 30-30-30-30, Weak 9" blow recovered 5' mud. FP's 60-60, SIP's 72-60.			Toronto	3117 (=1167)
DST#6 3382-3403, 30-30-30-30. Weak 8" blow. recovered 65' mud. FP's 73-64, SIP's 128-73.			Lansing	3138 (-1188)
			Arbuckle	3374 (-1423)

USE ADDITIONAL SHEETS, IF NECESSARY, TO COMPLETE WELL RECORD.

Date Received	<i>E. A. Fulkowski</i>	
	Signature	
	President	
	Title	
	MAY 13, 81	
	Date	

RECORDED AND INDEXED
MAY 13 1981
F&M OIL CO.

14-8-18W JUL

CONFIDENTIAL

State Geological Survey
WICHITA BRANCH

CONTRACTOR'S WELL LOG

OPERATOR:	F & M Oil Company
CONTRACTOR:	Abercrombie Drilling, Inc.
WELL NAME:	RUSS #1
LOCATION:	SE SW SE SE/4, Section 14-8S-18W Rooks County, Kansas
SPUD DATE:	2/14/81
COMPLETION DATE:	2/24/81

0	20	Post Rock
20	1335	Sand & Shale
1335	1363	Anhydrite
1363	1647	Sand & Shale
1647	3423	Shale & Lime
	3423	Rotary Total Depth

Spud hole @ 2:00 p.m., 2/14/81. Cut 210' of a 12 1/4" hole. Ran 5 jts. of 8 5/8" - 20# casing (tally 201.32). Set @ 207.82. Cemented with 150 sx. of common 2% gel, 3% c.c. Plug was down @ 7:45 p.m., 2/13/81.

T.D. @ 3423'. LTD @ 3422'. Ran 85 jts. of 4 1/2" - 9 1/2# casing (tally 3419.61) Set @ 3420'. Cemented with 100 sx. of 60-40 posmix, 2% gel, 3% c.c., 10% salt. Ran 20 bbls. of salt flush. Job was completed @ 1:20 a.m., 2/24/81. Mud Wt. 9.5, Visc. 49, WL 16, pH 6.4, Chl. 25,000, Solids 8.5%, LCM 2#, Acc. Mud Cost \$3056.60.

SAMPLE TOPS:

Anhydrite	1328'
B/Anhydrite	1363'

STATE OF KANSAS)
) SS
 COUNTY OF SEDGWICK)

Jack L. Partridge, Vice President of Abercrombie Drilling, Inc., does hereby state that the above and foregoing is a true and correct copy of the log of the RUSS #1, SE SW SE SE/4, Section 14-8S-18W, Rooks County, Kansas.

ABERCROMBIE DRILLING, INC.

BY: Jack L. Partridge
Jack L. Partridge, Vice President