

State Geological Survey KANSAS WICHITA BRANCH WICHITA DRILLERS LOG

API No. 15 — 163 — 20,492
County Number

Operator
National Oil Co., Inc.

Address
Suite 550, 200 West Douglas
Wichita, Kansas

Well No. #3-SWDW Lease Name Kriley

Footage Location
feet from (N) (S) line feet from (E) (W) line

Principal Contractor Red Tiger Drlg. Geologist

Spud Date 4-22-73 Total Depth 974' P.B.T.D.

Date Completed 4-23-73 Oil Purchaser

S. 22 T. 8 R. 18 W
Loc. C W 1/2 W 1/2 W 1/2
County Rocks

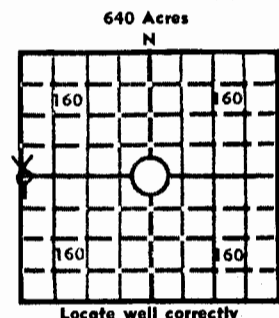

Elev.: Gr.
DF KB

CASING RECORD

Report of all strings set — surface, intermediate, production, etc.

Purpose of string	Size hole drilled	Size casing set (in O.D.)	Weight lbs/ft.	Setting depth	Type cement	Sacks	Type and percent additives
	12 1/4			974	60-40 Poz	275	4% Gel

LINER RECORD

PERFORATION RECORD

Top, ft.	Bottom, ft.	Sacks cement	Shots per ft.	Size & type	Depth interval

TUBING RECORD

Size	Setting depth	Packer set at			

ACID, FRACTURE, SHOT, CEMENT SQUEEZE RECORD

Amount and kind of material used	Depth interval treated

INITIAL PRODUCTION

Date of first production Producing method (flowing, pumping, gas lift, etc.)

RATE OF PRODUCTION PER 24 HOURS	Oil bbls.	Gas MCF	Water bbls.	Gas-oil ratio CFPB
---------------------------------	-----------	---------	-------------	--------------------

Disposition of gas (vented, used on lease or sold) Producing interval (s)

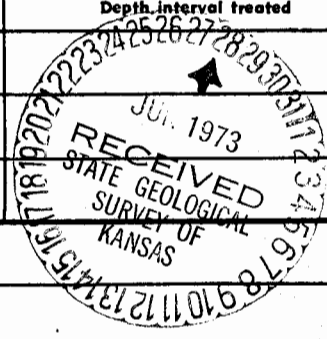

INSTRUCTIONS: As provided in KCC Rule 82-2-125, within 90 days after completion of a well, one completed copy of this Drillers Log shall be trans-
mitted to the State Geological Survey of Kansas, 4150 Monroe Street, Wichita, Kansas 67209. Copies of this form are available from the Conservation
Division, State Corporation Commission, 3830 So. Meridian (P.O. Box 17027), Wichita, Kansas 66217. Phone AC 316-522-2206. If confidential custody
is desired, please note Rule 82-2-125. Drillers Logs will be on open file in the Oil and Gas Division, State Geological Survey of Kansas, Lawrence, Kansas
66044.