

**WELL COMPLETION REPORT AND
DRILLER'S LOG**

S. 13 T. 8 R. 20 $\frac{E}{W}$

API No. 15 — 163 — 21,173
County Number

Loc. SE NE NW

County Rooks

Operator
F & M OIL Co., Inc

Address
422 Union Center, Wichita, Kansas 67202

Well No. 1 Lease Name Roy

Footage Location
2310 feet from (N) (X) line 330 feet from (E) (W) line

Principal Contractor: Abercrombie Drilling Geologist: Bob Gebhart

Spud Date: 11-15-80 Date Completed: 11-6-80 Total Depth: 3500 P.B.T.D.

Directional Deviation Oil and/or Gas Purchaser

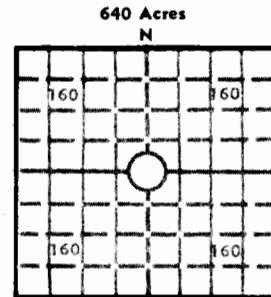

Elev.: Gr. 1977

DF _____ KB 1982

CASING RECORD

Report of all strings set — surface, intermediate, production, etc.

Purpose of string	Size hole drilled	Size casing set (in O.D.)	Weight lbs/ft.	Setting depth	Type cement	Sacks	Type and percent additives
surface	12 1/4"	8-5/8"		284	common	220	2% gel, 3% Ca. Cl.
production		4 1/2"		3498	60-40	150	10% salt saturate

LINER RECORD

PERFORATION RECORD

Top, ft.	Bottom, ft.	Sacks cement	Shots per ft.	Size & type	Depth interval
			2		3354-58
			2		3372-76

TUBING RECORD

Size	Setting depth	Packer set at

ACID, FRACTURE, SHOT, CEMENT SQUEEZE RECORD

Amount and kind of material used	Depth interval treated
3000 gal. 28% acid	3332-40

INITIAL PRODUCTION

Date of first production December 12, 1980	Producing method (flowing, pumping, gas lift, etc.) pumping
RATE OF PRODUCTION PER 24 HOURS	Oil 31.80 bbls. Gas - MCF Water 2.54 bbls. Gas-oil ratio CFPB
Disposition of gas (vented, used on lease or sold) sold	Producing interval (s)

INSTRUCTIONS: As provided in KCC Rule 82-2-125, within 90 days after completion of a well, one completed copy of this Drillers Log shall be transmitted to the State Geological Survey of Kansas, 4150 Monroe Street, Wichita, Kansas 67209. Copies of this form are available from the Conservation Division, State Corporation Commission, 245 No. Water, Wichita, Kansas 67202. Phone AC 316-522-2206. If confidential custody is desired, please note Rule 82-2-125. Drillers Logs will be on open file in the Oil and Gas Division, State Geological Survey of Kansas, Lawrence, Kansas 66044.

Operator
F & M Oil Co., Inc.

DESIGNATE TYPE OF COMP.: OIL, GAS,
DRY HOLE, SWDW, ETC.: oil

Well No. 1 Lease Name Roy

S 13 T 8 R 20 ~~W~~

WELL LOG

Show all important zones of porosity and contents thereof; cored intervals, and all drill-stem tests, including depth interval tested, cushion used, time tool open, flowing and shut-in pressures, and recoveries.

SHOW GEOLOGICAL MARKERS, LOGS RUN, OR OTHER DESCRIPTIVE INFORMATION.

FORMATION DESCRIPTION, CONTENTS, ETC.	TOP	BOTTOM	NAME	DEPTH
DST #1 3226-78, 30-45-30-45. Str. blow. Rec. 1100' SW. FP's 107-387, SIP's 1274 1274			Electric Log Tops: Anhydrite	1476 (+ 506)
DST #2 3315-80, 30-45-30-45. Str. blow. Rec. 10' SL. OCM, 60' VHOCM, (30% M, 70%O). 120' VGMO. FP's 89-150, SIP's 1221-1178			Topeka	2956 (- 974)
DST #3 3380-3400, 30-30-30-30. Wk 15" blow. Rec. 10' M. FP's 32-32, SIP's 463-75			Heebner	3159 (-1177)
DST #4 3460-70, 30-30-30-30. Wk 15" blow. Rec. 5'M FP's 43--32, SIP's 452-387.			Toronto	3188 (-1206)
			Lansing	3201 (-1219)
			B/KC	3414 (-1432)
			Arbuckle	3461 (-1479)
			LTD	3501

USE ADDITIONAL SHEETS, IF NECESSARY, TO COMPLETE WELL RECORD.

Date Received	<i>C. A. Salkowski</i>
	Signature
	<i>President</i>
	Title
	Date

54573

13-8-20W

State Geological Survey
WICHITA, BRANCH

CONTRACTOR'S WELL LOG

OPERATOR: F & M Oil Company
 CONTRACTOR: Abercrombie Drilling, Inc.
 WELL NAME: ROY #1
 LOCATION: C SE NE NW, Section 13-8S-20W
 Rooks County, Kansas
 SPUD DATE: 10-15-80
 COMPLETION DATE: 10-21-80

0	286	Clay, Sand, Shale
286	925	Shale
925	1477	Shale & Sand
1477	1511	Anhydrite
1511	2300	Shale
2300	2860	Shale & Lime
2860	3058	Shale
3058	3200	Shale & Lime
3200	3500	Lime
	3500	RTD

Spud hole @ 1:15 p.m. 10-15-80. Drilled 286' of a 12-1/4" hole. Ran 7 joints of 8-5/8" 20# casing (tally 277.71') Set @ 284' T.D. Cemented with 220 sx. of common, 3% c.c., 2% gel. Cement did circulate. Plug was down @ 5:00 p.m. 10-15-80.

T.D. 3500'. Ran 87 joints of 4-1/2" 9-1/2# casing (tally 3501') Set @ 3498'. Ran 10 barrels salt flush. Cementing with 150 sx. of 60/40 posmix, 10% salt saturated. Plug was down @ 7:50 p.m. 10-21-80.

SAMPLE TOPS:

Anhydrite 1477'
 B/Anhydrite 1511'

STATE OF KANSAS)
) SS
 COUNTY OF SEDGWICK)

Jack L. Partridge, Assistant Secretary-Treasurer of Abercrombie Drilling, Inc., does hereby state that the above and foregoing is a true and correct copy of the log of the ROY #1, C SE NE NW, Section 13-8S-20W, Rooks County, Kansas.