

15-065-20980

*Geological Survey*

WICHITA BRANCH  
KANSAS DRILLERS LOG

S. 33 T. 8S R. 22W<sup>E</sup><sub>W</sub>

API No. 15 — 065 — 20,980  
County Number

Loc. NE NW NE

County Graham

Operator  
National Oil Company

Address  
200 West Douglas, Suite 550, Wichita, KS 67202

Well No. 1 Lease Name Elliott

Footage Location  
330 feet from (N) ~~31~~ line 1650 feet from (E) ~~20~~ line

Principal Contractor: Abercrombie Drilling Geologist: R. B. Gebhart

Spud Date: Jan. 4, 1978 Total Depth: 3882 P.B.T.D.

Date Completed: January 12, 1978 Oil Purchaser

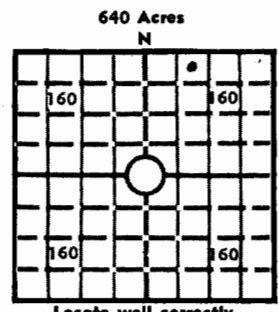

Elev.: Gr. 2254

DF 2260 KB 2262

CASING RECORD

Report of all strings set — surface, intermediate, production, etc.

Purpose of string	Size hole drilled	Size casing set (in O.D.)	Weight lbs/ft.	Setting depth	Type cement	Sacks	Type and percent additives
Surface	12 1/4	8-5/8	23	251	Common	190	2% gel, 3% cc

LINER RECORD

PERFORATION RECORD

Top, ft.	Bottom, ft.	Sacks cement	Shots per ft.	Size & type	Depth interval

TUBING RECORD

Size	Setting depth	Packer set at

ACID, FRACTURE, SHOT, CEMENT SQUEEZE RECORD

Amount and kind of material used	Depth interval treated

INITIAL PRODUCTION

Date of first production		Producing method (flowing, pumping, gas lift, etc.)			
RATE OF PRODUCTION PER 24 HOURS	Oil bbls.	Gas MCF	Water bbls.	Gas-oil ratio	CFPB
Disposition of gas (vented, used on lease or sold)			Producing interval (s)		

INSTRUCTIONS: As provided in KCC Rule 82-2-125, within 90 days after completion of a well, one completed copy of this Drillers Log shall be transmitted to the State Geological Survey of Kansas, 4150 Monroe Street, Wichita, Kansas 67209. Copies of this form are available from the Conservation Division, State Corporation Commission, 3830 So. Meridian (P.O. Box 17027), Wichita, Kansas 66217. Phone AC 316-522-2206. If confidential custody is desired, please note Rule 82-2-125. Drillers Logs will be on open file in the Oil and Gas Division, State Geological Survey of Kansas, Lawrence, Kansas 66044.

Operator

National Oil Company

DESIGNATE TYPE OF COMP.: OIL, GAS,  
DRY HOLE, SWDW, ETC.:

Dry

Well No.

1

Lease Name

Elliott

S 33 T 8S R 22W<sup>E</sup><sub>W</sub>

NE NW NE, Graham County, Kansas

**WELL LOG**

Show all important zones of porosity and contents thereof; cored intervals, and all drill-stem tests, including depth interval tested, cushion used, time tool open, flowing and shut-in pressures, and recoveries.

SHOW GEOLOGICAL MARKERS, LOGS RUN,  
OR OTHER DESCRIPTIVE INFORMATION.

FORMATION DESCRIPTION, CONTENTS, ETC.	TOP	BOTTOM	NAME	DEPTH
DST #1, 3602-90'; 30-45-30-45; Wk blow thruout; Rec 300' very thin mud, 240' SMW w/few oil spots in tool; IFP 126-210; FFP 253-327; ISIP 1226; FSIP 1205; BHT 111 <sup>o</sup> .			Log Tops	
			Anhydrite	1840 +422
			B/Anhydrite	1874 +388
			Topeka	3271 -1009
			Heebner	3488 -1226
			Toronto	3515 -1253
			Lansing	3528 -1266
			B/Kansas	
			City	3743 -1481
			LTD	3881 -1619
			RTD	3882 -1620

USE ADDITIONAL SHEETS, IF NECESSARY, TO COMPLETE WELL RECORD.

Date Received

*Bill C. Koenig*  
Signature

Geologist

Title

January 24, 1978

Date

55257

## WICHITA BRANCH

OPERATOR:  
CONTRACTOR:  
WELL NAME:  
LOCATION:  
  
SPUD DATE:  
COMPLETION DATE:

The National Oil Co.  
Abercrombie Drilling, Inc.  
Elliott #1  
NE NW NE Section 33-8S-22W  
Graham County, Kansas  
January 4, 1978  
January 12, 1978

0	260	Surface soil, sand & shale
260	660	Shale
660	1735	Shale & sand
1735	1837	Shale & lime
1837	1873	Anhydrite
1873	2395	Shale
2395	2653	Shale & lime
2653	2786	Shale
2786	3124	Lime & shale
3124	3295	Shale
3295	3540	Lime & shale
3540	3587	Shale & lime
3587	3650	Lime
3650	3690	Lime & shale
3690	3882	Lime
	3882	Rotary Total Depth

## SAMPLE TOPS:

Anhydrite 1848' (+414)  
B/Anhydrite 1875' (+387)

Spud hole at 6:45 p.m., January 4, 1978. Drilled 260' of 12¼" hole. Ran 6 joints of 8-5/8" - 23# casing. Set at 251.52'. Cemented with 190 sacks common cement, 2% gel, 3% CaCl. Cement did circulate. Plug was down at 12:45 a.m., January 5, 1978.

T.D. 3882'. Set 1st plug at 850' with 70 sacks, 2nd plug at 240' with 20 sacks, 3rd plug - 40' solid bridge with 10 sacks. Cemented with 50/50 posmix, 6% gel. Job complete at 2:30 a.m., January 12, 1978.