

State Geological Survey
WICHITA, BRANCH

KANSAS DRILLERS LOG

S. 36 T. 8 R. 24 ^{E/W}
 Loc. 1320 FEL & FWL/C NE
 County Graham

API No. 15 — 065 — 20,655
 County Number

Operator Empire Drilling Company	
Address 650 Fourth National Bank Building Wichita, Kansas 67202	
Well No. #1	Lease Name Popp
Footage Location 1320 feet from (N) <input checked="" type="checkbox"/> line 1320 feet from (E) <input checked="" type="checkbox"/> line	
Principal Contractor Murfin Drilling Company	Geologist Steve Powell
Spud Date 3-30-74	Total Depth 3900'
Date Completed 4-5-74	P.B.T.D.
Oil Purchaser	

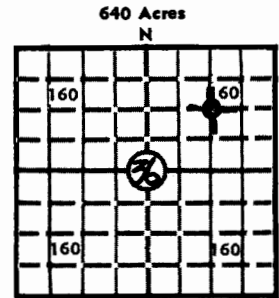

Elev.: Gr. 2355
 DF _____ KB 2360

CASING RECORD

Report of all strings set— surface, intermediate, production, etc.

Purpose of string	Size hole drilled	Size casing set (in O.D.)	Weight lbs/ft.	Setting depth	Type cement	Socks	Type and percent additives
Surface	12 1/4	8 5/8	28	221	60/40 Pox Mix w/ HA 5	225	

LINER RECORD

PERFORATION RECORD

Top, ft.	Bottom, ft.	Sacks cement	Shots per ft.	Size & type	Depth interval

TUBING RECORD

Size	Setting depth	Packer set at

ACID, FRACTURE, SHOT, CEMENT SQUEEZE RECORD

Amount and kind of material used	Depth interval treated

INITIAL PRODUCTION

Date of first production		Producing method (flowing, pumping, gas lift, etc.)			
RATE OF PRODUCTION PER 24 HOURS	Oil	Gas	Water	Gas-oil ratio	
	bbis.	MCF	bbis.	CFPB	
Disposition of gas (vented, used on lease or sold)			Producing interval (s)		

INSTRUCTIONS: As provided in KCC Rule 82-2-125, within 90 days after completion of a well, one completed copy of this Drillers Log shall be transmitted to the State Geological Survey of Kansas, 4150 Monroe Street, Wichita, Kansas 67209. Copies of this form are available from the Conservation Division, State Corporation Commission, 3830 So. Meridian (P.O. Box 17027), Wichita, Kansas 66217. Phone AC 316-522-2206. If confidential custody is desired, please note Rule 82-2-125. Drillers Logs will be on open file in the Oil and Gas Division, State Geological Survey of Kansas, Lawrence, Kansas 66044.

Operator
 Empire Drilling Company

DESIGNATE TYPE OF COMP.: OIL, GAS,
 DRY HOLE, SWDW, ETC.:
 Dry Hole

Well No.
 1

Lease Name
 Popp

S 36 T 8S R 24 W

WELL LOG

Show all important zones of porosity and contents thereof; cored intervals, and all drill-stem tests, including depth interval tested, cushion used, time tool open, flowing and shut-in pressures, and recoveries.

SHOW GEOLOGICAL MARKERS, LOGS RUN,
 OR OTHER DESCRIPTIVE INFORMATION.

FORMATION DESCRIPTION, CONTENTS, ETC.	TOP	BOTTOM	NAME	DEPTH
			Sample Tops:	
Sand-Shale		50	Anhydrite	2044
Sand		160	Base Anhydrite	2079
Shale		221	Topeka	3506
Cement-Shale		930	Heebner	3665
Shale		2044	Toronto	3690
Anhydrite		2079	Lansing	3708
Shale		2590	Muncie Creek	3821
Shale-Lime		3080	Rotary TD	3900
Shale		3255		
Shale-Lime		3465		
Lime		3585		
Shale-Lime		3680		
Lime		3900		
Total Depth		3900		
No tests taken.				

USE ADDITIONAL SHEETS, IF NECESSARY, TO COMPLETE WELL RECORD.

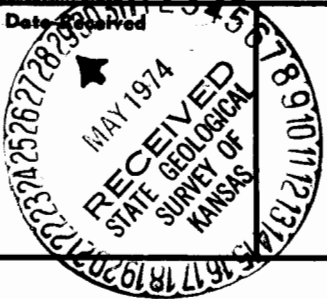

J. E. Rakaskas
 J. E. Rakaskas
 Exploration Manager

May 2, 1974

50241