

28-8-32 W

STATE CORPORATION COMMISSION OF KANSAS  
OIL & GAS CONSERVATION DIVISION

WELL COMPLETION OR RECOMPLETION FORM  
ACO-1 WELL HISTORY

DESCRIPTION OF WELL AND LEASE

Operator: License # 6939  
Name CHAPMAN EXPLORATION, INC.  
Address 404 Cities Service Building  
Tulsa, Oklahoma  
City/State/Zip 74119

Purchaser DRY HOLE

Operator Contact Person VIRGIL JOHNSON  
Phone 918/582-2247

Contractor: License # 6033  
Name MURFIN DRILLING, Wichita, Ks.

Wellsite Geologist  
Phone

Designate Type of Completion  
 New Well  Re-Entry  Workover  
 Oil  SWD  Temp Abd  
 Gas  Inj  Delayed Comp.  
 Dry  Other (Core, Water Supply etc.)

If OWWO: old well info as follows:  
Operator  
Well Name  
Comp. Date Old Total Depth

WELL HISTORY

Drilling Method:  
 Mud Rotary  Air Rotary  Cable  
8/4/84 8/14/84 8/14/84  
Spud Date Date Reached TD Completion Date  
4715' DRY  
Total Depth PBD

Amount of Surface Pipe Set and Cemented at 345 feet  
Multiple Stage Cementing Collar Used?  Yes  No  
If yes, show depth set feet  
If alternate 2 completion, cement circulated  
from feet depth to w/SX cmt

API NO. 15-193-20316  
County THOMAS  
NW SW NE Sec. 28 Twp. 8S Rge. 32  East  West

3630 Ft North from Southeast Corner of Section  
2310 Ft West from Southeast Corner of Section  
(Note: Locate well in section plat below)

Lease Name BOEGER Well # 1  
Field Name

Producing Formation DRY HOLE

Elevation: Ground 3092' KB 3100'  
Section Plat

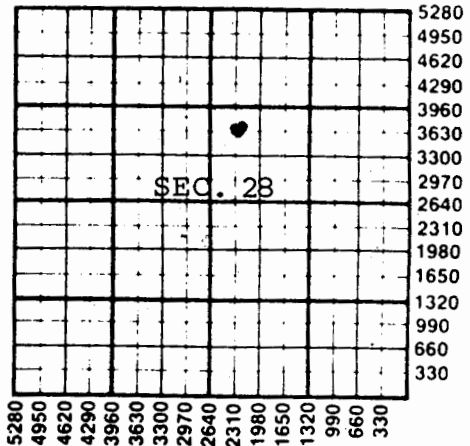

WATER SUPPLY INFORMATION

Disposition of Produced Water:  Disposal  DRY HOLE  
Docket #  Repressuring

Questions on this portion of the ACO-1 call:  
Water Resources Board (913) 296-3717

Source of Water:  
Division of Water Resources Permit #

Groundwater Ft North from Southeast Corner (Well) Ft West from Southeast Corner of Sec Twp Rge  East  West

Surface Water Ft North from Southeast Corner (Stream, pond etc) Ft West from Southeast Corner Sec Twp Rge  East  West

Other (explain) From nearby irrigation well (purchased from city, R.W.D. #)

INSTRUCTIONS: This form shall be completed in duplicate and filed with the Kansas Corporation Commission, 200 Colorado Derby Building, Wichita, Kansas 67202, within 90 days after completion or recompletion of any well. Rule 82-3-130 and 82-3-107 apply.

Information on side two of this form will be held confidential for a period of 12 months if requested in writing and submitted with the form. See rule 82-3-107 for confidentiality in excess of 12 months.

One copy of all wireline logs and drillers time log shall be attached with this form. Submit CP-4 form with all plugged wells. Submit CP-111 form with all temporarily abandoned wells.

MAY 12 1986  
KANSAS CORPORATION COMMISSION  
WICHITA BRANCH

SIDE TWO

Operator Name CHAPMAN EXPLORATION, INC. Lease Name BOEGER Well # 1

Sec. 28 Twp. 8S Rge. 32  East  West County THOMAS

WELL LOG

INSTRUCTIONS: Show important tops and base of formations penetrated. Detail all cores. Report all drill stem tests giving interval tested, time tool open and closed, flowing and shut-in pressures, whether shut-in pressure reached static level, hydrostatic pressures, bottom hole temperature, fluid recovery, and flow rates if gas to surface during test. Attach extra sheet if more space is needed. Attach copy of log.

Drill Stem Tests Taken  Yes  No  
Samples Sent to Geological Survey  Yes  No  
Cores Taken  Yes  No

Formation Description  Log  Sample

DST #1 4563-4605'  
30-30-30-30  
Rec. 15' mud  
SIP 55 - 55  
FP 44 - 55

Name	Top	Bottom
Topeka	3846'	
Heebner	4049'	
Toronto	4069'	
L K C	4085'	
Marmaton	4392'	
Fort Scott	4530'	
Cherokee	4561'	
Mississipian	4651'	
TD	4715'	

DST #2 3767-95'  
45-45-45-45  
1800' SW  
SIP 1140 - 1140  
IFP 133 - 599  
FFP 632 - 865

CASING RECORD  New  Used

Report all strings set-conductor, surface, intermediate, production, etc.

Purpose of String	Size Hole Drilled	Size Casing Set (in O.D.)	Weight Lbs/Ft.	Setting Depth	Type of Cement	#Sacks Used	Type and Percent Additives
Surface	12-1/4"	8-5/8"	24	345'		300	2% CaCl

PERFORATION RECORD

Acid, Fracture, Shot, Cement Squeeze Record

Shots Per Foot	Specify Footage of Each Interval Perforated	(Amount and Kind of Material Used)	Depth
.....	.....	.....	.....
.....	.....	.....	.....
.....	.....	.....	.....
.....	.....	.....	.....

TUBING RECORD Size Set At Packer at Liner Run  Yes  No

Date of First Production Producing Method  Flowing  Pumping  Gas Lift  Other (explain).....