

KANSAS

**WELL COMPLETION REPORT AND
DRILLER'S LOG**

API No. 15 — 193 County — 20,210 Number State Geological Survey

S. 33 T. 8S R. 36 ^{NE} _W

Loc. C NW SE

County THOMAS

Operator Abraxas Petroleum Corporation WICHITA, KANSAS

Address P.O. Box 17485

Well No. 2 Lease Name Studer "A"

Footage Location 1980 feet from XX (S) line 1980 feet from (E) XX line

Principal Contractor Rains & Williamson Oil Co. Geologist Glenn Tracey

Spud Date 10-5-80 Date Completed 11-16-80 Total Depth 4,760' P.B.T.D. 4,756'

Directional Deviation 1/2 ° @ 4740' Oil and/or Gas Purchaser Koch Oil Company

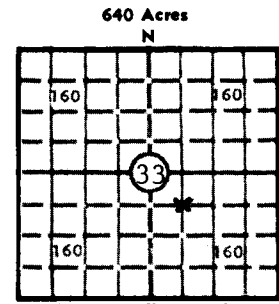

Locate well correctly
Elev.: Gr. 3,408'
DF 3414' KB 3415'

CASING RECORD

Report of all strings set — surface, intermediate, production, etc.

Purpose of string	Size hole drilled	Size casing set (in O.D.)	Weight lbs/ft.	Setting depth	Type cement	Sacks	Type and percent additives
Surface	12-1/4"	8-5/8"	20	286	60/40 Pos.	225	2% Gel 3% CaCl ₂
Production	7-7/8"	4-1/2"	9.5	4759	60/40 Pos.	200	2% Gel 18% Salt

LINER RECORD

PERFORATION RECORD

Top, ft.	Bottom, ft.	Sacks cement	Shots per ft.	Size & type	Depth interval
			4	.41"	4721-26
			4	.41"	4702-06
			4	.41"	4693-98
			4	.41"	4277-81
			4	.41"	4269-73

TUBING RECORD

Size	Setting depth	Pecker set at
2-3/8	4740'	None

ACID, FRACTURE, SHOT, CEMENT SQUEEZE RECORD

Amount and kind of material used	Depth interval treated
Squeeze - 50 sxs. 60/40 Pos.	4269-73 & 4277-81 and reperforated same zone.
Acid - 500 gal. MCA & 1500 gal. 15% HCL	4693-98, 4702-06, 4721-26

INITIAL PRODUCTION

Date of first production <u>Dec. 5, 1980</u>		Producing method (flowing, pumping, gas lift, etc.) <u>Pumping</u>			
RATE OF PRODUCTION PER 24 HOURS	Oil <u>36.40 bbls.</u>	Gas <u>TSTM</u>	Water <u>MCF</u>	Gas-oil ratio <u>1.68 bbls.</u>	<u>TSTM</u> CFPB
Disposition of gas (vented, used on lease or sold) <u>None</u>			Producing interval (s) <u>4269-73, 4277-81</u> <u>4721-26, 4702-06, 4693-98 (Lansing K.C.)</u>		

INSTRUCTIONS: As provided in KCC Rule 82-2-125, within 90 days after completion of a well, one completed copy of this Drillers Log shall be transmitted to the State Geological Survey of Kansas, 4150 Monroe Street, Wichita, Kansas 67209. Copies of this form are available from the Conservation Division, State Corporation Commission, 245 No. Water, Wichita, Kansas 67202. Phone AC 316-522-2206. If confidential custody is desired, please note Rule 82-2-125. Drillers Logs will be on open file in the Oil and Gas Division, State Geological Survey of Kansas, Lawrence, Kansas 66044.

Operator Abraxas Petroleum Corporation		DESIGNATE TYPE OF COMP.: OIL, GAS, DRY HOLE, SWDW, ETC.:
Well No. 2	Lease Name Studer "A"	Oil
S <u>33</u> T <u>8S</u> R <u>36</u> ^{EX} _W		

WELL LOG	SHOW GEOLOGICAL MARKERS, LOGS RUN, OR OTHER DESCRIPTIVE INFORMATION.
Show all important zones of porosity and contents thereof; cored intervals, and all drill-stem tests, including depth interval tested, cushion used, time tool open, flowing and shut-in pressures, and recoveries.	

FORMATION DESCRIPTION, CONTENTS, ETC.	TOP	BOTTOM	NAME	DEPTH
DST #1 IF 260# First FF 380# 30 min. Open ISI 1254# 30 min. Second IF 410# Open FF 500# 30 min. FSI 1254# 30 min. Strong blow throughout. Rec. 960' muddy salt water.	4180	4250	Lansing A, B, C & D	
DST #2 IF 40# First FF 100# 30 min. Open ISI 1205# 45 min. Second IF 120# Open FF 180# 45 min. FSI 1185# 60 min. Fair steady blow. Rec. 310' HOCM (60% oil, 32% mud and 8% water) and 60' muddy oil. (80% oil, 10% mud, 10% water)	4250	4283	Lansing E & F	
DST #3 Pressure recorders did not work. Misrun. Rec. 744' salt water.	4286	4300	Lansing G	
DST #4 IF 330# First FF 1027# 30 min. Open ISI 1304# 30 min. Second IF 1096# Open FF 1274# 30 min. FSI 1314# 30 min. Strong blow. Rec. 2,660' salt water.	4312	4325	Lansing G	

USE ADDITIONAL SHEETS, IF NECESSARY, TO COMPLETE WELL RECORD.

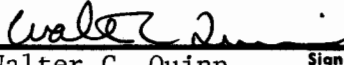
Date Received	<div style="text-align: right;">  Signature Walter C. Quinn Production Manager Title December 10, 1980 Date </div>
---------------	--

57930

DESIGNATE TYPE OF COMPANY OIL, GAS, DRY HOLE, SWDW, ETC.

Operator Abraxas Petroleum Corporation	
Well No. 2	Lease Name Studer "A"
S 33 T 8S R 36 XX W	

State of Oklahoma
WICHTIA, DISTRICT H
33-8-36W

WELL LOG

Show all important zones of porosity and contents thereof; cored intervals, and all drill-stem tests, including depth interval tested, cushion used, time tool open, flowing and shut-in pressures, and recoveries.

SHOW GEOLOGICAL MARKERS, LOGS RUN, OR OTHER DESCRIPTIVE INFORMATION.

FORMATION DESCRIPTION, CONTENTS, ETC.	TOP	BOTTOM	NAME	DEPTH
DST #5 IF 50# First FF 50# 30 min. Open ISI 1156# 30 min. Second IF 50# Open FF 50# 30 min. FSI 1116# 30 min. Slight blow. Rec. 5' drilling mud w/ some oil spots.	4330	4337	Lansing H	
DST #6 IF 40# First FF 30# 30 min. Open ISI 659# 30 min. Second IF 40# Open FF 20# 30 min. FSI 330# 30 min. Weak blow, died in 10 min. 2nd, no blow rec. 6' drilling mud.	4339	4350	Lansing I	
DST #7 IF 50# First FF 50# 30 min. Open ISI 110# 30 min. Second IF 40# Open FF 40# 30 min. FSI 120# 30 min. Weak blow, died in 25 min. 2nd, no blow rec. 30' drilling mud w/oil specks.	4367	4400	Lansing K	
DST #8 IF 60# First FF 70# 30 min. Open ISI 1225# 30 min. Second IF 50# Open FF 60# 30 min. FSI 118# 30 min. Weak blow 1st, no blow on 2nd. Rec. 30' drilling mud.	4400	4435	Lansing L	

USE ADDITIONAL SHEETS, IF NECESSARY, TO COMPLETE WELL RECORD.

Date Received	<p><i>Walter C. Quinn</i> Walter C. Quinn Signature Production Manager Title December 10, 1980 Date</p>
---------------	---

Operator Abraxas Petroleum Corporation		DESIGNATE TYPE OF COMP.: OIL, GAS, DRY HOLE, SWDW, ETC.
Well No. 2	Lease Name Studer "A"	State Geological Survey WICHITA, BRANCH 33-8-36W
S 33 T8S R 36 W		

WELL LOG

Show all important zones of porosity and contents thereof; cored intervals, and all drill-stem tests, including depth interval tested, cushion used, time tool open, flowing and shut-in pressures, and recoveries.

SHOW GEOLOGICAL MARKERS, LOGS RUN, OR OTHER DESCRIPTIVE INFORMATION.

FORMATION DESCRIPTION, CONTENTS, ETC.	TOP	BOTTOM	NAME	DEPTH
DST #9 IF 92# First FF 119# 30 min. Open ISI 1490# 45 min. Second IF 119# Open FF 145# 45 min. FSI 1464# 60 min. Fair blow. Rec. 120' mud-cut gassy oil (80% oil), 30' Oil and Gas cut mud (20% oil).	4659	4740	Cherokee	

USE ADDITIONAL SHEETS, IF NECESSARY, TO COMPLETE WELL RECORD.

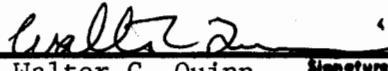
Date Received	
	Walter C. Quinn <small>Signature</small>
	Production Manager <small>Title</small>
	December 10, 1980 <small>Date</small>

DRILLER'S LOG

State Geological Survey
WICHITA, BRANCH

COMPANY: Abraxas Petroleum Corporation

SEC. 33 T. 8S R. 36W

WELL NAME: Studer "A" #2

LOC. C SE NE

COUNTY: Thomas

RIG NO. #1

TOTAL DEPTH 4760'

ELEVATION

COMMENCED: 10-5-80

COMPLETED: 10-20-80

CONTRACTOR: Rains & Williamson Oil Co., Inc.

CASING RECORD:

SURFACE: 8 5/8" @ 286' w/225 sx. 60/40 poz., 3% cc., 2% gel.

PRODUCTION: 4 1/2" @ 4756' w/200 sx. 60/40 poz., 18% salt, 2% gel, 05% CF

LOG

(Figures Indicate Bottom of Formations)

Sand, Clay & Shale	290
Shale & Sand	537
Shale	1847
Shale & Sand	2358
Shale, Sand & Lime	2682
Shale & Sand	3476
Shale	3543
Shale & Lime	4283
Lime & Shale	4370
Shale & Lime	4480
Shale	4760
<u>ROTARY TOTAL DEPTH</u>	<u>4760</u>

STATE OF Kansas)

COUNTY OF _____)

SS: