

KANSAS DRILLERS LOG

S. 31 T. 9S R. 17W ^W_W

API No. 15 — 163 — 21,297
County Number

Loc. SW NE NW

County Rooks

Operator
Woodman & Iannitti Oil Company

Address
1008 Douglas Bldg., 104 South Broadway, Wichita, KS 67202

Well No. #1 Lease Name Adam

Footage Location
990 feet from (N) ~~W~~ line 990 feet from (E) ~~W~~ line

Principal Contractor Geologist
John O. Farmer, Inc. Green & Green

Spud Date Total Depth P.B.T.D.
5-14-81 3620'

Date Completed Oil Purchaser
5-22-81

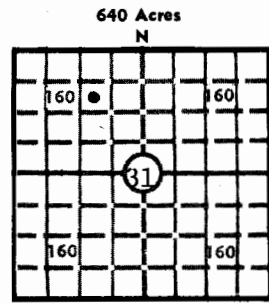

Elev.: Gr.

DF KB 2115

CASING RECORD

Report of all strings set — surface, intermediate, production, etc.

Purpose of string	Size hole drilled	Size casing set (in O.D.)	Weight lbs/ft.	Setting depth	Type cement	Sacks	Type and percent additives
Surface	12-1/4"	8-5/8"	24	246'	Common	175	
Production	7-7/8"	4-1/2"		3618	Common	150	

LINER RECORD

PERFORATION RECORD

Top, ft.	Bottom, ft.	Sacks cement	Shots per ft.	Size & type	Depth interval

TUBING RECORD

Size	Setting depth	Packer set at

ACID, FRACTURE, SHOT, CEMENT SQUEEZE RECORD

Amount and kind of material used	Depth interval treated

INITIAL PRODUCTION

Date of first production		Producing method (flowing, pumping, gas lift, etc.)			
RATE OF PRODUCTION PER 24 HOURS	Oil bbls.	Gas MCF	Water	Gas-oil ratio	CFPB
Disposition of gas (vented, used on lease or sold)			Producing interval (s)		

RECEIVED
STATE CORPORATION COMMISSION
AUG - 3 1981
CONSERVATION DIVISION
Wichita, Kansas

INSTRUCTIONS: As provided in KCC Rule 82-2-125, within 90 days after completion of a well, one completed copy of this Drillers Log shall be transmitted to the State Geological Survey of Kansas, 4150 Monroe Street, Wichita, Kansas 67209. Copies of this form are available from the Conservation Division, State Corporation Commission, 3830 So. Meridian (P.O. Box 17027), Wichita, Kansas 66217. Phone AC 316-522-2206. If confidential custody is desired, please note Rule 82-2-125. Drillers Logs will be on open file in the Oil and Gas Division, State Geological Survey of Kansas, Lawrence, Kansas 66044.

Operator Woodman & Iannitti Oil Company		DESIGNATE TYPE OF COMP.: OIL, GAS, DRY HOLE, SWDW, ETC.:
Well No. #1	Lease Name Adams	Oil
S 31 T 9S R 17W ^{EX} _W		

WELL LOG

Show all important zones of porosity and contents thereof; cored intervals, and all drill-stem tests, including depth interval tested, cushion used, time tool open, flowing and shut-in pressures, and recoveries.

SHOW GEOLOGICAL MARKERS, LOGS RUN, OR OTHER DESCRIPTIVE INFORMATION.

FORMATION DESCRIPTION, CONTENTS, ETC.	TOP	BOTTOM	NAME	DEPTH
Shale	0	380		
Shale & Sand	380	940		
Sand	940	1110		
Red Bed	1110	1403		
Anhydrite	1403	1444		
Shale & Lime	1444	1545		
Shale & Salt Lime	1545	1885		
Shale & Lime	1885	2085		
Lime & Shale	2085	2235		
Shale & Lime	2235	2575		
Lime & Shale	2575	2725		
Shale & Lime	2725	3045		
Lime & Shale	3045	3145		
Shale & Lime	3145	3325		
Lime & Shale	3325	3400		
Lime	3400	3620		
Anhy 1404-1444 + 710				
Topeka 3038 - 923				
Heebner 3252 -1137				
Toronto 3273 -1158				
Lansing 3295 -1180				
Base-Kansas City 3522 -1407				
Conglomerate Chert 3536 -1421				
Simpson Dolemite 3578 -1463				
Arbuckle 3604 -1489				
D.S.T. #1 3364-3400				
30, 30, 30, 30				
Recovered 1010' salt water				
IFP 74-35, IBHP 822, F.F.P 371-540				
FBHP 812				
D.S.T. #2 3420-3485				
30"				
Recovered 80' mud				
IFP 85-85				
IBHP 906				
FFP 95-95				
FBHP 833				

USE ADDITIONAL SHEETS, IF NECESSARY, TO COMPLETE WELL RECORD.

Date Received	<i>John D. Farmer III</i>
	Signature
	Vice-President
	Title
	May 26, 1981
	Date

59750

WOODMAN-IANNITTI OIL CO.
P.O. Box 308
Great Bend, Kansas 67530

31-9-170

TO: Interestholders

June 26, 1981

Lease: # Adam

5-14-81 Moved in Rotary (J. O. Farmer) and set 251' 8 5/8" 28Lb. cemented with 175 sacks, cement circulated.

Permanent zero is 5' above ground level. Geologist was Cliff Ottowa, (J. R. Green). Electra ran an open hole log.

5-22-81 Reached TD of 3616'. 4 1/2" 9 1/2 LB, new 8rd. casing was set at 3616' and cemented with 150 sacks common.

Shoe jt was 16.87 float is at 3599'.

6-19-81 Moved in double drum (Chase Well "Lawrence") just got rigged up.

6-20-81 Swabbed hole down, check for leaks no leaks hole dry.

Rigged up Electra and ran correlation log, found TD @ 3570' which is 29' too shallow its cement above plug. Will not clean out since our lowest perforation well be 100' above this.

Rigged up and perforated as follows for limited entry.

Zone	Perf.	Shots	Size
J	3472'	1	3/8th
I	3455'	1	3/8th
H	3432'	1	3/8th

None of the above perforations had any show or made anything natural.

Acidized by limited entry the J - I and H zones with 2500 gals. 15% reg. NE acid. Max pressure 1150# after we had 500 gal in pressure down to 900# where it remained for rest of treatment.

Swabbed hole down, we started getting a small show of oil at 3000' on swab down, from 3000' to 3500' good show, hole swabbed 40 bbl. getting load back.

	Swab test	H	I	J
1st. hour.	100' = 1 1/2 bbl.	5 %		
2nd. hour	75' = 1.10 bbls	16 %		

This is at the rate of 29 BFPD 20% oil = 5.80 + 23.20 BWPD

Zones are giving what the DST indicated. They were mostly water not much acid. We are sure after a few more hours test our total fluid will fall considerably. Shut down for week end.

6-22-81 Ran swab - 2400' down to fluid = 1070' fluid in hole or 16 BBLs. well made over week end, there was 95' of oil on top which = 9% oil or 1.60 BO+ 14.40 BW.

Put on Swab test

1st. hour	48.9	GFPH	11% oil
2nd. hour	48	GFPH	9% oil
3rd. hour	39	GFPH	20% oil = 23 BFPD - 4.80 oil + 18.2 Water
4th hour	30	GFPH	20% oil = 18 BFPD - 3.60 oil + 14.40 Water

11:30 AM rigged up Electra to perforate.

Zone	Perf.	feet	SPF	
E	3370-73'	3	3	No shows

Set plug at 3400'. Ran swab zone did not make anything natural. Acidized E Zone with 1000' gals. 15% reg NE. Acid all went on vacuum. Pulled retrievable bridge plug.

Rigged up to perforate.

Zone	Perf.	Feet	SPF	Made natural
D	3347-50'	3	3	Nothing

Acidized with 1000 Gals. 15% NE. Had to go to 1400# before acid started to feed. Pumping 1/2 BPM pressure went from 1400# to 100# 4 BBLs. in, increased to 1 BPM then to 2 BPM - 100# all acid in

RECEIVED
STATE CORPORATION COMMISSION
AUG - 3 1981
CONSERVATION DIVISION
Wichita, Kansas

31-9-17W

LEASE: Adam

CONTINUED - PAGE 2

June 26, 1981

on vacuum immediately. Let set 30 minutes. Started to swab down - fluid was down 900'. Swabbed down to 2600' recovered 48 bbls only a scum of oil. Lacked 32 bbls. getting load back. Shut down for night.

6-23-81 Ran swab, fluid was down 1800' only a small show of oil on top of fluid Est. a quart.
Swabbed down, now we have recovered all of our load plus 6 bbls.

Put on Test (The D Zone)
1ST. HOUR 6.63 BFPH Scum of oil
2ND. HOUR 5.01 BFPH Scum of oil
3RD. HOUR 2.90 BFPH Scum of oil

Went in and moved the plug down hole to 3400' which is 30' below the E zone so we can include the E in our swab testing along with our D zone. Now swab testing D & E zones together. From fillup it looks like our E zone will not make anything.

Swab test D & E zones together after each had been treated with 1000 gals. acid.

1st. hour 5.01 BFPH Scum of oil
2nd. hour 5.01 BFPH Scum of oil
3rd. hour 3.34 BFPH Scum of oil
4th hour 3.34 BFPH Scum of oil

Expect these two zones to go to just a few BWPD and no oil.

Went in and retrieved bridge plug to perforate A zone.

Zone	Perf	Feet	SPF	Made natural
A	3294-96'	2	3	Show of oil

Ran retrievable bridge plug back and set at 3330'. Ran swab to check if A zone made anything natural - none.

Acidized A Zone with 1000 gals. 15% reg. Started to feed at 425# pumping 1 BPM. pressure down to 300# 200 gals in., increased to 2 1/2 BPM 400# back to 200# 500 gals. in., increased pump to 4 1/2 BPM 450# at end of treatment on vacuum immediately. 5:05 PM.

5:40 PM ran swab. found fluid 900' down. Swabbed down to 2400' recovered 48 bbls. of load. 7:30 PM. Shut down for night.

6-24-81 Ran swab fluid was down 1800'. Swabbed hole down recovered 84 bbls. fluid. 14 Bbls. over load put on test.

Swab test A zone after 1000 gals. acid.

1st. hour 14 BBL 15% oil
2nd. Hour 5.80 BBL. 30% oil
3rd. hour 5.80 BBL. 30% oil
4th hour 5.80 BBL. 30% oil

The A zone was real consistant on swab test. Zone at present should produce 139 BFPD - 41 BOPD + 98 SWPD, we do look for both to decline in 30 to 60 days.

ANALYSIS:

J - I and H zone swabbed at the rate of 18 BFPD - 3.60 BOPD + 14.40 BWPD. E & D zones swabbed (together) at the rate of 3.34 BFPD all water scum of oil.

All Zones	Total Fluid per day	Water	Oil
J I & H	18	14.40	3.60
E & D	80	80	.25
A	139	98	41
Total	228	192.40	44.85

We are going to pump all zones together and hope the E & D dry up. If not we will have to squeeze the E & D zones off.

CONCLUSION:

We were quite foolish perforating the E & D zones, especially at this time. If water doesn't deplete we will have to shut off by packer or squeezing E & D. A SWD well is a must. None of the zones were communciated. Equipping well and lease for pump.

RECEIVED
STATE CORPORATION COMMISSION
'AUG - 3 1981
CONSERVATION DIVISION
Wichita, Kansas