

KANSAS DRILLERS LOG

API No. 15 — 163 — 21,242
 County Number

State Geological Survey
 WICHITA, KANSAS

S. 31 T. 9S R. 17W
 Loc. NE SW SW
 County Rooks

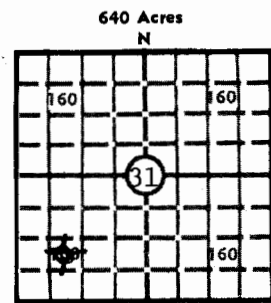

Elev.: Gr. 2118'
 DF 2121' KB 2123'

Operator: Woodman & Iannitti Oil Company
 Address: 1008 Douglas Bldg., 104 South Broadway, Wichita, KS 67202
 Well No. #2 Lease Name Westhusing
 Footage Location: 990 feet from ~~XXX~~ (S) line 990 feet from ~~XXX~~ (W) line
 Principal Contractor: John O. Farmer, Inc. Geologist: Cliff Ottaway
 Spud Date: 2-11-81 Total Depth: 3630' P.B.T.D.
 Date Completed: 2-20-81 Oil Purchaser:

CASING RECORD

Report of all strings set— surface, intermediate, production, etc.

Purpose of string	Size hole drilled	Size casing set (in O.D.)	Weight lbs/ft.	Setting depth	Type cement	Sacks	Type and percent additives
Surface	12-1/4"	8-5/8"	24	210'	Common	150	

LINER RECORD

PERFORATION RECORD

Top, ft.	Bottom, ft.	Sacks cement	Shots per ft.	Size & type	Depth interval

Size	Setting depth	Packer set at

ACID, FRACTURE, SHOT, CEMENT SQUEEZE RECORD

Amount and kind of material used	Depth interval treated

INITIAL PRODUCTION

Date of first production: _____ Producing method (flowing, pumping, gas lift, etc.): _____

RATE OF PRODUCTION PER 24 HOURS	Oil	Gas	Water	Gas-oil ratio
	bbls.	MCF	bbls.	CFPB

Disposition of gas (vented, used on lease or sold): _____ Producing interval(s): _____

INSTRUCTIONS: As provided in KCC Rule 82-2-125, within 90 days after completion of a well, one completed copy of this Drillers Log shall be transmitted to the State Geological Survey of Kansas, 4150 Monroe Street, Wichita, Kansas 67209. Copies of this form are available from the Conservation Division, State Corporation Commission, 3830 So. Meridian (P.O. Box 17027), Wichita, Kansas 66217. Phone AC 316-522-2206. If confidential custody is desired, please note Rule 82-2-125. Drillers Logs will be on open file in the Oil and Gas Division, State Geological Survey of Kansas, Lawrence, Kansas 66044.

Operator Woodman & Iannitti Oil Company		DESIGNATE TYPE OF COMP.: OIL, GAS, DRY HOLE, SWDW, ETC.:
Well No. #2	Lease Name Westhusing	Dry Hole
S 31 T 9S R17W ^{EX} _W		

WELL LOG

Show all important zones of porosity and contents thereof; cored intervals, and all drill-stem tests, including depth interval tested, cushion used, time tool open, flowing and shut-in pressures, and recoveries.

SHOW GEOLOGICAL MARKERS, LOGS RUN, OR OTHER DESCRIPTIVE INFORMATION.

FORMATION DESCRIPTION, CONTENTS, ETC.	TOP	BOTTOM	NAME	DEPTH
Sand & Shale	0	865		
Shale & Sand	865	950		
Sand	950	1125		
Red Bed	1125	1390		
Anhydrite	1390	1449		
Shale & Shells	1449	1620		
Shale & Lime	1620	2090		
Lime & Shale	2090	2265		
Shale & Lime	2265	2850		
Lime & Shale	2850	3070		
Lime	3070	3630		

USE ADDITIONAL SHEETS, IF NECESSARY, TO COMPLETE WELL RECORD.

Date Received	<i>John D. Farmer III</i>
	Signature
	Vice-President
	Title
	February 23, 1981
	Date

59770