

State Geological Survey
WICHITA, BRANCH
KANSAS
MAY 8 0 REC'D

**WELL COMPLETION REPORT AND
DRILLER'S LOG**

API No. 15 — 163 — 20,926
County Number

S. 17 T. 9S R. 18W E
Loc. SE/4 SE/4 SE/4
County Rooks

Operator
Frontier Oil Company

Address
1720 KSB&T Building, Wichita, Kansas 67202

Well No. 1 Lease Name Harrison "A"

Footage Location
feet from (N) (S) line feet from (E) (W) line

Principal Contractor Red Tiger Drilling Company Geologist Jerry Knobel

Spud Date 6/15/79 Date Completed 6/27/79 Total Depth 3,552' P.B.T.D.

Directional Deviation Oil and/or Gas Purchaser NCRA

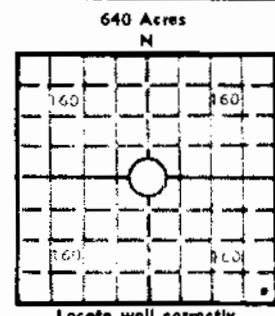

Elev.: Gr. 2122
DF 2124 KB 2,127'

CASING RECORD

Report of all strings set — surface, intermediate, production, etc.

Purpose of string	Size hole drilled	Size casing set (in O.D.)	Weight lbs./ft.	Setting depth	Type cement	Sacks	Type and percent additives
Surface	12 1/4"	8 5/8"	28#	256'	Common	165	3% C.C., 2% Gel
Production	7 7/8"	4 1/2"	9.5#	3,549'	Common	750	10% Salt, 4% Gel, 6% Gel

LINER RECORD

PERFORATION RECORD

Top, ft.	Bottom, ft.	Sacks cement	Shots per ft.	Size & type	Depth interval
TUBING RECORD			Open Hole		
Size	Setting depth	Packer set at			
2-3/8"	3520'				

ACID, FRACTURE, SHOT, CEMENT SQUEEZE RECORD

Amount and kind of material used	Depth interval treated
250 gal 15% INS Acid	3549-3552

RECEIVED
STATE CORPORATION COMMISSION
OCT 31 1979
CONSERVATION DIVISION
WICHITA, KANSAS

INITIAL PRODUCTION

Date of first production 8-7-79 Producing method (flowing, pumping, gas lift, etc.) Pump

RATE OF PRODUCTION PER 24 HOURS	Oil	Gas	Water	Gas-oil ratio
	25 bbls.	0 MCF	0 bbls.	CFPB

Disposition of gas (vented, used on lease or sold) Producing interval (s) 3549-3552

INSTRUCTIONS: As provided in KCC Rule 82-2-125, within 90 days after completion of a well, one completed copy of this Drillers Log shall be transmitted to the State Geological Survey of Kansas, 4150 Monroe Street, Wichita, Kansas 67209. Copies of this form are available from the Conservation Division, State Corporation Commission, 245 No. Water, Wichita, Kansas 67202. Phone AC 316-522-2206. If confidential custody is desired, please note Rule 82-2-125. Drillers Logs will be on open file in the Oil and Gas Division, State Geological Survey of Kansas, Lawrence, Kansas 66044.

Operator Frontier Oil Company		DESIGNATE TYPE OF COMP.: OIL, GAS, DRY HOLE, SWDW, ETC.:
Well No. 1	Lease Name Harrison "A"	Oil
S 17 T 9S R 18W ^E _W		

WELL LOG

Show all important zones of porosity and contents thereof; cored intervals, and all drill-stem tests, including depth interval tested, cushion used, time tool open, flowing and shut-in pressures, and recoveries.

SHOW GEOLOGICAL MARKERS, LOGS RUN, OR OTHER DESCRIPTIVE INFORMATION.

FORMATION DESCRIPTION, CONTENTS, ETC.	TOP	BOTTOM	NAME	DEPTH
Surface Clay & Shale	0	264		
Clay & Shale	264	312		
Sand & Shale	312	1466		
Anhydrite	1466	1501		
Shale & Red Bed	1501	1551		
Shale, Red Bed & Lime Streaks	1551	1792		
Lime & Shale	1792	3065		
Lime	3065	3128		
Lime & Shale	3128	3252		
Lime	3252	3552		
RTD		3552		

USE ADDITIONAL SHEETS, IF NECESSARY, TO COMPLETE WELL RECORD.

Date Received	<i>Daphne V. Star</i>
	Signature
	Office Manager
	Title
	September 20, 1979
	Date

59849