

7-9-20W *lud*

SIDE ONE

STATE CORPORATION COMMISSION OF KANSAS
OIL & GAS CONSERVATION DIVISION

WELL COMPLETION OR RECOMPLETION FORM
ACO-1 WELL HISTORY

DESCRIPTION OF WELL AND LEASE

Operator: License # 5140
Name Frontier Oil Company
Address 125 N. Market, Ste. 1720
City/State/Zip Wichita, Ks. 67202

Purchaser N/A

Operator Contact Person Jean Angle
Phone 316-263-1201

Contractor: License # 5302
Name Red Tiger Drilling Company

Wellsite Geologist Richard D. Parker
Phone 913-483-5348

Designate Type of Completion
 New Well Re-Entry Workover
 Oil SWD Temp Abd
 Gas Inj Delayed Comp.
 Dry Other (Core, Water Supply etc.)

If OWWO: old well info as follows:
Operator
Well Name
Comp. Date Old Total Depth

WELL HISTORY

Drilling Method:
 Mud Rotary Air Rotary Cable
5-18-85 5-26-85 5-26-85
Spud Date Date Reached TD Completion Date
3815' N/A
Total Depth PBDT

Amount of Surface Pipe Set and Cemented at 300' feet
Multiple Stage Cementing Collar Used? Yes No
If yes, show depth set.....feet
If alternate 2 completion, cement circulated
from.....feet depth to.....w/.....SX cmt

API No. 15-163-22-687

County Rooks

C-N/2.N/2.S/2 Sec.7... Twp.9S.Rge.20W. East West

2310 Ft North from Southeast Corner of Section
2640 Ft West from Southeast Corner of Section
(Note: Locate well in section plat below)

Lease Name Desmarteau Well # 2

Field Name Arpin SW.

Producing Formation N/A

Elevation: Ground 2204' KB 2209'

Section Plat

JUN 1 1985
RECEIVED
State Geological Survey
WICHITA BRANCH
JUN 11 1985
CONSERVATION DIVISION
Wichita, Kansas

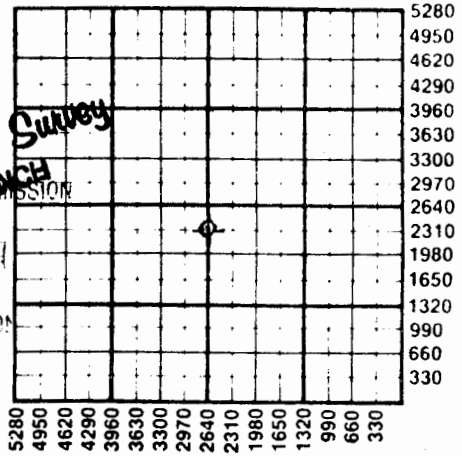

WATER SUPPLY INFORMATION

Disposition of Produced Water: Disposal Repressuring
Docket #

Questions on this portion of the ACO-1 call:

Water Resources Board (913) 296-3717
Source of Water: Richard Simoneau, Damor, Ks.
Division of Water Resources Permit #

Groundwater.....Ft North from Southeast Corner
(Well)Ft West from Southeast Corner of
Sec Twp Rge East West

Surface Water 1800 Ft North from Southeast Corner
2300 Ft West from Southeast Corner
Sec 17 Twp 9S Rge 20 East West

Other (explain).....
(purchased from city, R.W.D. #)

INSTRUCTIONS: This form shall be completed in duplicate and filed with the Kansas Corporation Commission, 200 Colorado Derby Building, Wichita, Kansas 67202, within 90 days after completion or recompletion of any well. Rule 82-3-130 and 82-3-107 apply.
Information on side two of this form will be held confidential for a period of 12 months if requested in writing and submitted with the form. See rule 82-3-107 for confidentiality in excess of 12 months.
One copy of all wireline logs and drillers time log shall be attached with this form. Submit CP-4 form with all plugged wells. Submit CP-111 form with all temporarily abandoned wells.