

KANSAS DRILLERS LOG

*State Geological Survey
Wichita, Kansas*

API No. 15 — 163 — 20629
County Number

S. 7 T. 9s R. 20 ^{NE} _W
Loc. 1200' FS & 330' FE NW/4
County Rooks, Ks

Operator
MURFIN DRILLING COMPANY

Address
617 Union Center, Wichita, Kansas 67202

Well No. 1 Lease Name **DAUPHIN-DESMARTEAU**

Footage Location
1200' feet from ~~XX~~ (S) line 330' feet from (E) ~~XX~~ line NW/4

Principal Contractor **Murfin Drilling** Geologist **Roger Welty**

Spud Date 8/3/76 Total Depth 3810' P.B.T.D.

Date Completed 8/11/76 Oil Purchaser **CRA, Inc.**

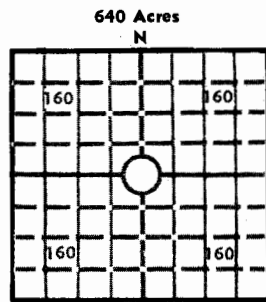

640 Acres
N
Locate well correctly
Elev.: Gr. 2182'
DF _____ KB 2187'

CASING RECORD

Report of all strings set — surface, intermediate, production, etc.

Purpose of string	Size hole drilled	Size casing set (in O.D.)	Weight lbs/ft.	Setting depth	Type cement	Sacks	Type and percent additives
Surface	12 1/4"	8 5/8	24#	180'	Comm. Sunset	130	
Production	7 7/8"	4 1/2	9.5	3809'	Comm. 10% salt 3/4 1% CFR-2	100 ← 100 →	Latex

LINER RECORD

PERFORATION RECORD

Top, ft.	Bottom, ft.	Sacks cement	Shots per ft.	Size & type	Depth interval
			4	Jumbo Jets	3463-66'

Size	Setting depth	Packer set at
2 3/8" EUE	3464.69'	--

ACID, FRACTURE, SHOT, CEMENT SQUEEZE RECORD

Amount and kind of material used	Depth interval treated
250 gal. SS-20 and 500 gal. SS-20	3463-66'

INITIAL PRODUCTION

Date of first production 9/1/76 Producing method (flowing, pumping, gas lift, etc.) Pumping

RATE OF PRODUCTION PER 24 HOURS	Oil <u>28.80</u> bbls.	Gas _____ MCF	Water <u>43.20</u> bbls.	Gas-oil ratio _____ CFPB
---------------------------------	------------------------	---------------	--------------------------	--------------------------

Disposition of gas (vented, used on lease or sold) _____ Producing interval (s) 3463-66'

INSTRUCTIONS: As provided in KCC Rule 82-2-125, within 90 days after completion of a well, one completed copy of this Drillers Log shall be transmitted to the State Geological Survey of Kansas, 4150 Monroe Street, Wichita, Kansas 67209. Copies of this form are available from the Conservation Division, State Corporation Commission, 3830 So. Meridian (P.O. Box 17027), Wichita, Kansas 66217. Phone AC 316-522-2206. If confidential custody is desired, please note Rule 82-2-125. Drillers Logs will be on open file in the Oil and Gas Division, State Geological Survey of Kansas, Lawrence, Kansas 66044.

Operator Murfin Drilling

DESIGNATE TYPE OF COMP.: OIL, GAS,
DRY HOLE, SWDW, ETC.:

Producer

Well No.

1

Lease Name

DAUPHIN-DESMARTEAU

S 7 T 9s R 20 ^{EX}
W

WELL LOG

Show all important zones of porosity and contents thereof; cored intervals, and all drill-stem tests, including depth interval tested, cushion used, time tool open, flowing and shut-in pressures, and recoveries.

SHOW GEOLOGICAL MARKERS, LOGS RUN,
OR OTHER DESCRIPTIVE INFORMATION.

FORMATION DESCRIPTION, CONTENTS, ETC.	TOP	BOTTOM	NAME	DEPTH
surface soil, rock		65	Log tops:	
shale		180		
sand, shale		550	Anhydrite	1666 +521
sand stks, shale		1170	Topeka	3178 -991
sand - cedar hill		1400	Heebner	3384 -1197
shale - red bed		1665	Toronto	3406 -1216
shale		3360	LKC	3424 -1237
lime, shale		3470	BKC	3641 -1454
lime		3725	Arbuckle	3735 -1548
lime, shale		3810	LTD	3806 -1619
RTD		3810		
DST #1: 3345-60/45-45-60-45, fair bl. incr. to good, rec 430' MW, SIP 1113-1068, FP 46-218#.				
DST #2: 3446-70/30-30-30-30, strong bl, rec. 420' GO, 840' MGO, SIP 1068-1068, FP 69-493#.				
DST #3: 3486-3501/30-30-30-30, rec. 10' M, SIP 34-34, FP 34-34#.				
DST #4: 3486-3510/30-30-30-30, rec. 1940' SGCMW, SIP 1102-1102, FP 126-955#, 114 ^o .				
DST #5: 3545-3635/30-30-30-30, rec. 10' M, SIP 298-161, FP 69-80#.				

USE ADDITIONAL SHEETS, IF NECESSARY, TO COMPLETE WELL RECORD.

Date Received

Larry M. Jack
Signature

Larry M. Jack, Production Engineer

Title

October 2, 1976

Date

HEL10