

Incl Pl 715184
8-9-20^{K9C}

STATE CORPORATION COMMISSION OF KANSAS
OIL & GAS CONSERVATION DIVISION

WELL COMPLETION OR RECOMPLETION FORM
ACO-1 WELL HISTORY

DESCRIPTION OF WELL AND LEASE

Operator: license # 5140
name Frontier Oil Company
address 125 N. Market, Ste 1720
Wichita, Ks. 67202
City/State/Zip

Operator Contact Person Jean Angle
Phone 316-263-1201

Contractor: license # 5302
name Red Tiger Drilling Company

Wellsite Geologist Steven D. Angle
Phone 913-628-2586
PURCHASER Koch Oil Company

Designate Type of Completion
 New Well Re-Entry Workover

Oil SWD Temp Abd
 Gas Inj Delayed Comp.
 Dry Other (Core, Water Supply etc.)

If OWWO: old well info as follows:
Operator
Well Name
Comp. Date Old Total Depth

WELL HISTORY

Drilling Method: Mud Rotary Air Rotary Cable
6-2-84 6-14-84 7-5-84
Spate Date Reached TD Completion Date
3785' N/A
Total Depth PBDT

Art of Surface Pipe Set and Cemented at 219.35' feet

Multiple Stage Cementing Collar Used? Yes No

If Yes, Show Depth Set 1673' feet

If alternate 2 completion, cement circulated from feet depth to w/ SX cmt

API NO. 15-163-22,397

County Rooks

SW SE NW (location) Sec. 8 Twp. 9S Rge. 20W East West

2970 Ft North from Southeast Corner of Section
3630 Ft West from Southeast Corner of Section
(Note: locate well in section plat below)

Lease Name Thyfault Well# 1

Field Name Arpin So

Producing Formation Arbuckle

Elevation: Ground 2172' KB 2177'

RELEASED

Date: AUG 1 1985

FROM CONFIDENTIAL

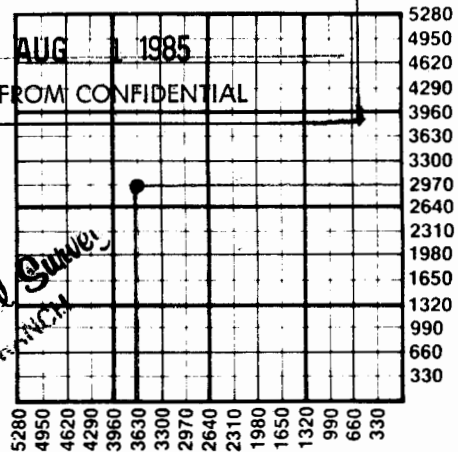

WATER SUPPLY INFORMATION

Source of Water:
Division of Water Resources Permit #

Groundwater (Well) Ft North From Southeast Corner and Ft. West From Southeast Corner of Sec Twp Rge East West

Surface Water (Stream, Pond etc.) Ft North From Southeast Corner and Ft West From Southeast Corner Sec Twp Rge East West

Other (explain) Purchased/Irene Thyfault, Damar, Ks. (purchased from city, R.W.D.#)

Disposition of Produced Water: Disposal Repressuring

Docket # Pending #3 Thyfault SWDW

| Estimated Production Per 24 Hours | Oil | Gas | Water | Gas-Oil Ratio | Gravity |
|-----------------------------------|---------|---------|----------|---------------|---------|
| | 20 Bbls | N/A MCF | 108 Bbls | N/A CFPB | |

Disposition of gas: vented sold

METHOD OF COMPLETION
 open hole perforation other (specify)

PRODUCTION INTERVAL
3716-3732'

Operator Name Frontier Oil Company Lease Name Thyfault Well# 1 SEC 8 TWP 9S RGE 20W East West

| | | | | |
|--|--|--|---|--|
| TUBING RECORD size <u>2-3/8"</u> set at <u>3703'</u> packer at <u>N/A</u> | | | Liner Run <input type="checkbox"/> Yes <input checked="" type="checkbox"/> No | |
| Date of First Production <u>7-5-84</u> | Producing method <input type="checkbox"/> flowing <input checked="" type="checkbox"/> pumping <input type="checkbox"/> gas lift <input type="checkbox"/> Other (explain) | | | |

Drill Stem Tests Taken Yes No
 Samples Sent to Geological Survey Yes No
 Cores Taken Yes No

DST 1 (3329-3409) 60-30-60-30 Strg blo Rec 870' MSW.
Press not recorded.

DST 2 (3409-3470) 60-30-60-30 wk to fr blo Rec 180'
GOSpk M IF 31-51 FF 62-82 ISI 931 FSI 929.

DST 3 (3466-3499) 60-30-60-30 wk to strg blo Rec 1000'
WM IF 51-165 FF 165-207 ISI 1034 FSI 1034

DST 4 (3534-3568) 60-30 15-30 wk blo both ops Rec 5'M
All press 20#.

DST 5 (3558-3625) 30-30-30-30 wk blo 1st op no blo 2nd
op Rec 5'M IF 62-62 FF 62-62 ISI 207 FSI 103

DST 6 (3678-3707) 30-30-30-30 wk blo Rec 15' OSpkM
IF 20-30 FF 30-30 ISI 207 FSI 103.

DST 7 (3707-3717) 60-30-60-30 wk blo TO Rec 64' HD&GCM
IF 20-20 FF 20-40 ISI 89 FSI 410.

DST 8 (3715-3725) 60-30-60-30 wk to strg blo Rec 60' GIP
255' Free Gsy O IF 20-103 FF 103-145 ISI 518 FSI 518

DST 9 (3725-3735) 60-30-60-30 wk to strg blo Rec 282'
C1 O, 285' GCMO IF 52-104 FF 155-228 ISI 560 FSI 539

DST 10 (3735-3745) 60-30-60-30 strg blo Rec 1255'SW
IF 414-550 FF 621-621 ISI 621 FSI 621.
RTD 3785'

| Name | Formation Description | |
|------------------|-----------------------|--------|
| | Top | Bottom |
| Anhydrite | 1658 | 1698 |
| Topeka | 3171 | |
| Heebner | 3375 | |
| Toronto | 3395 | |
| Lansing | 3415 | |
| Base Kansas City | | 3052 |
| Conglomerate | 3658 | |
| Arbuckle | 3698 | |
| RTD | 3785 | |

| CASING RECORD <input checked="" type="checkbox"/> new <input type="checkbox"/> used | | | | | | | |
|---|-------------------|---------------------------|----------------|---------------|----------------|--------------|----------------------------|
| Report all strings set - conductor, surface, intermediate, production, etc. | | | | | | | |
| Purpose of string | size hole drilled | size casing set (in O.D.) | weight lbs/ft. | setting depth | type of cement | # sacks used | type and percent additives |
| Surface | 12 1/2" | 8-5/8" | 24# | 226.70' | Common | 160 | 2% gel 3% cc |
| Production | 7-7/8" | 5-1/2" | 14# | 3784' | Common | 200 | 10% Salt |
| DV | 7-7/8" | 5-1/2" | 14# | 1673' | 50-50 Poz | 500 | 6% gel. |

| PERFORATION RECORD | | Acid, Fracture, Shot, Cement Squeeze Record | |
|--------------------|---|---|-------|
| shots per foot | specify footage of each interval perforated | (amount and kind of material used) | Depth |
| 4 | 3716 - 3732' | 250 gal, 15% INS acid. | |
| | | | |
| | | | |