

Section 20 Township 9 Range 18W

Well No. #6 Baumgartner "B"

Company Heathman & Seeligson

NORTH

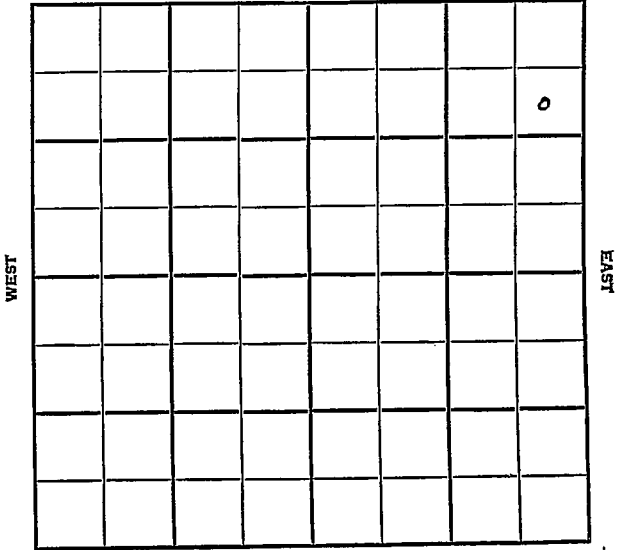

SOUTH

SEC.	20	TWP.	9	R.	18W
------	----	------	---	----	-----

WELL NO. #6 Baumgartner "B" FARM

COMPANY Heathman & Seeligson

CONTRACTOR H & S

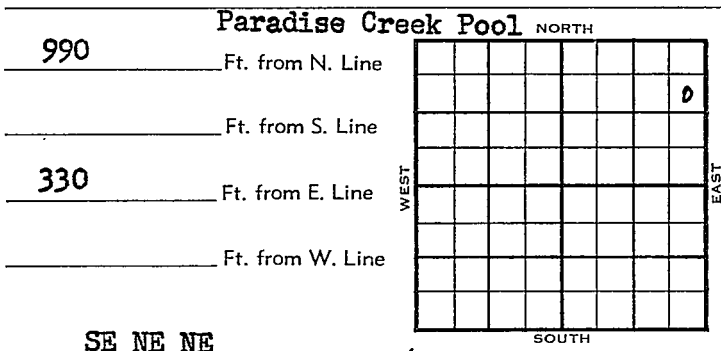

SE NE NE

1954	ELEVATION	REPORT
	2170'	

12/15 M I R

1955  
1/26

Spud 12-14-54 - Oil Well  
 TD 3589'  
 8" @ 160'  
 Anhy 1495', Top. 3087', Heeb 3299',  
 Tor. 3320', Lans. 3340'  
 BST 3380-90', opn 40", rec. 10' mud,  
 0#  
 DST 3395-3407', opn 1 hr., rec. 960'  
 VSOCM & SW 1060#  
 DST 3470-85', opn 1 hr., rec. 120'  
 sw, 1120#  
 DST 3532-62', opn 40", rec. 10' mud,  
 645#  
 B KC 3546', Arb. 3582'  
 TD 3584'  
 5" @ 3583'  
 DD 3589'  
 B/30 boph 8 hrs., 500A  
 S/7 boph 8 hrs., 1000A  
 S/11 boph  
 C omp. 431 bopd

COMPLETED



County \_\_\_\_\_ Rocks \_\_\_\_\_ State Kansas  
 Sec. 20 (Blk.) 9 (Sur.) 18W Map No. \_\_\_\_\_  
 Operator Heathman & Seeligson  
 Well No. 6 Farm Baumgartner "B"  
 Elev. 2170 Location SE NE NE

990 Ft. From N Line NE

330 Ft. From E Line Quarter

1st. Report

Completion JAN 26 1955

Remarks Paradise Creek Pool

H & S - Contr.

Spudding Date 12-14-54

Drlg. Data Oil well TD 3589

8" @ 160 Anhy 1495 Top. 3087

Heeb. 3299 Tor. 3320 Lans. 3340

DST 3380-90 open 40 min. Rec. 10' mud

0# DST 3395-3407 open 1 hr. Rec.

960' vsocm & sw 1060# DST 3470-85

open 1 hr. Rec. 120' sw 1120# DST 3532-

62 open 40 min. Rec. 10' mud 645#

B KC 3546 Arb. 3582 TD 3584 5" @ 3583

DD 3589 B/ 30-goph 8 hr. 500 A

S/ 7 boph 8 hr. 1000 A S/ 11 boph

Comp. 431 bopd.

FABEN GILSTRAP