

15-065-21192

State Geological Survey
WICHITA BRANCH
KANSAS DRILLERS LOG

S. 1 T. 9S R. 21W^{XX}_W
Loc. SE SE SE
County Graham

API No. 15 —————
County Number

Operator
Dean Allison Oil Company

Address
507 Insurance Building, Wichita, KS 67202

Well No. #1 Lease Name Arpin

Footage Location
330 feet from ~~XX~~ (S) line 330 feet from (E) ~~XW~~ line

Principal Contractor John O. Farmer, Inc. Geologist Jim Thompson

Spud Date 12-27-79 Total Depth 3735' P.B.T.D.

Date Completed 1-5-80 Oil Purchaser

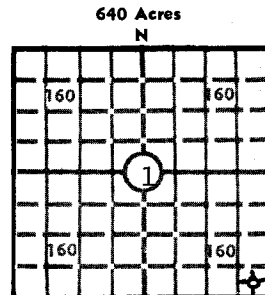

640 Acres
N
Locate well correctly
Elev.: Gr. 2154'
DF 2157' KB 2159'

CASING RECORD

Report of all strings set — surface, intermediate, production, etc.

| Purpose of string | Size hole drilled | Size casing set (in O.D.) | Weight lbs/ft. | Setting depth | Type cement | Sacks | Type and percent additives |
|-------------------|-------------------|---------------------------|----------------|---------------|-------------|-------|----------------------------|
| Surface | 12-1/4 | 8-5/8 | 28 | 221' | Common | 165 | |
| | | | | | | | |
| | | | | | | | |
| | | | | | | | |

LINER RECORD

PERFORATION RECORD

| Top, ft. | Bottom, ft. | Sacks cement | Shots per ft. | Size & type | Depth interval |
|----------|-------------|--------------|---------------|-------------|----------------|
| | | | | | |

| Size | Setting depth | Packer set at |
|------|---------------|---------------|
| | | |

ACID, FRACTURE, SHOT, CEMENT SQUEEZE RECORD

| Amount and kind of material used | Depth interval treated |
|----------------------------------|------------------------|
| | |
| | |
| | |

INITIAL PRODUCTION

| | | | | |
|--|---|---------|-----------------------|--------------------|
| Date of first production | Producing method (flowing, pumping, gas lift, etc.) | | | |
| RATE OF PRODUCTION PER 24 HOURS | Oil bbls. | Gas MCF | Water bbls. | Gas-oil ratio CFPB |
| Disposition of gas (vented, used on lease or sold) | | | Producing interval(s) | |

INSTRUCTIONS: As provided in KCC Rule 82-2-125, within 90 days after completion of a well, one completed copy of this Drillers Log shall be transmitted to the State Geological Survey of Kansas, 4150 Monroe Street, Wichita, Kansas 67209. Copies of this form are available from the Conservation Division, State Corporation Commission, 3830 So. Meridian (P.O. Box 17027), Wichita, Kansas 66217. Phone AC 316-522-2206. If confidential custody is desired, please note Rule 82-2-125. Drillers Log will be on open file in the Oil and Gas Division, State Geological Survey of Kansas, Lawrence, Kansas 66044.

| | | |
|---|---------------------|---|
| Operator Dean Allison Oil Company | | DESIGNATE TYPE OF COMP.: OIL, GAS, DRY HOLE, SWDW, ETC.: |
| Well No. #1 | Lease Name Arpin | Dry Hole |
| S 1 T 9S R 21W ^{KX} _W | | |

WELL LOG

Show all important zones of porosity and contents thereof; cored intervals, and all drill-stem tests, including depth interval tested, cushion used, time tool open, flowing and shut-in pressures, and recoveries.

SHOW GEOLOGICAL MARKERS, LOGS RUN, OR OTHER DESCRIPTIVE INFORMATION.

| FORMATION DESCRIPTION, CONTENTS, ETC. | TOP | BOTTOM | NAME | DEPTH |
|---|------|--------|---------------|--------------|
| Clay & Post Rock | -0- | 25 | | Sample Tops |
| Blue Shale | 25 | 221 | | |
| Shale & Sand | 221 | 1162 | Anhydrite | 1658 (+501) |
| Sand | 1162 | 1402 | B/Anhydrite | 1706 (+453) |
| Red Bed | 1402 | 1658 | Heebner | 3367 (-1208) |
| Anhydrite | 1658 | 1706 | Lansing | 3408 (-1249) |
| Shale & Lime | 1706 | 3415 | Reworked Arb. | 3724 (-1565) |
| Lime | 3415 | 3585 | Arbuckle | 3730 (-1571) |
| Lime & Shale | 3585 | 3632 | T.D. | 3735 (-1576) |
| Lime | 3632 | 3720 | | |
| Lime & Shale | 3720 | 3735 | | |
| <p>DST #1 3453-3498'</p> <p>Tool open: 30-30-60-30; good blow</p> <p>Rec: 680' slightly oil & gas cut muddy water</p> <p>BHP: 892-861</p> <p>FP: 73-354</p> <p>DST #2 3497-3632'</p> <p>Tool open: 30-30-60-30; fair blow</p> <p>Rec: 350' slightly oil cut muddy water</p> <p>BHP: 954-934</p> <p>FP: 104-229</p> <p>DST #3 3676-3735'</p> <p>Tool open: 30-30-10-20; weak blow</p> <p>Rec: 15' mud - no oil</p> <p>FP: 42</p> <p>IFP: 52</p> <p>FFP: 42</p> | | | | |

USE ADDITIONAL SHEETS, IF NECESSARY, TO COMPLETE WELL RECORD.

| | |
|---------------|-----------------------|
| Date Received | <i>John O. Farmer</i> |
| | Signature |
| | President |
| | Title |
| | January 9, 1980 |
| | Date |