

State Geological Survey

WICHITA, BRANCH

KANSAS DRILLERS LOG

S. 28 T. 9S R. 21 ^K/_W

Loc. SE SW SW

County Graham

API No. 15 — 065 — 01138 — 0001
County Number

Operator

Earl Knighton

Address

710 Petroleum Building, Wichita, Kansas 67202

Well No.

1-3

Lease Name

Dodson OWWO

Footage Location

330 feet from (R) (S) line 990 feet from (E) (W) line

Principal Contractor

B & N Drilling

Geologist

--

Spud Date

9/12/78

Total Depth

3905'
~~3865'~~

P.B.T.D.

3856

Date Completed

9/14/78

Oil Purchaser

Mobil

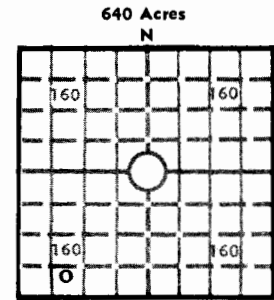

Elev.: Gr. _____

DF _____ KB 2348

CASING RECORD

Report of all strings set — surface, intermediate, production, etc.

| Purpose of string | Size hole drilled | Size casing set (in O.D.) | Weight lbs/ft. | Setting depth | Type cement | Sacks | Type and percent additives |
|-------------------|-------------------|---------------------------|----------------|---------------|-------------|-------|----------------------------|
| Surface | Set Previously | | | | | | |
| Production | -- | 4 1/2" | 9.5 | 3905 | 60/40 poz | 100sx | 5% gel |
| | | | | | | | |
| | | | | | | | |

LINER RECORD

PERFORATION RECORD

| Top, ft. | Bottom, ft. | Sacks cement | Shots per ft. | Size & type | Depth interval |
|----------|-------------|--------------|---------------|-------------|----------------|
| -- | | | 4 | DP | 3617-3773 |
| | | | | | |
| | | | | | |

TUBING RECORD

| Size | Setting depth | Packer set at |
|------|---------------|---------------|
| 2" | 3810 | none |
| | | |
| | | |

ACID, FRACTURE, SHOT, CEMENT SQUEEZE RECORD

| Amount and kind of material used | Depth interval treated |
|----------------------------------|------------------------|
| 4000 g 15% | 3617-3773 o, all |
| | |
| | |

INITIAL PRODUCTION

| | | | | | |
|--|---------|---|------------------------|---------------|------|
| Date of first production | | Producing method (flowing, pumping, gas lift, etc.) | | | |
| 11/25/78 | | Pumping | | | |
| RATE OF PRODUCTION PER 24 HOURS | Oil | Gas | Water | Gas-oil ratio | |
| | 7 bbls. | -- | 85 MCF | -- | CFPB |
| Disposition of gas (vented, used on lease or sold) | | | Producing interval (s) | | |
| -- | | | 3617-3773 | | |

INSTRUCTIONS: As provided in KCC Rule 82-2-125, within 90 days after completion of a well, one completed copy of this Drillers Log shall be transmitted to the State Geological Survey of Kansas, 4150 Monroe Street, Wichita, Kansas 67209. Copies of this form are available from the Conservation Division, State Corporation Commission, 3830 So. Meridian (P.O. Box 17027), Wichita, Kansas 66217. Phone AC 316-522-2206. If confidential custody is desired, please note Rule 82-2-125. Drillers Logs will be on open file in the Oil and Gas Division, State Geological Survey of Kansas, Lawrence, Kansas 66044.

| | | |
|---|----------------------|---|
| Operator Earl Knighton | | DESIGNATE TYPE OF COMP.: OIL, GAS, DRY HOLE, SWDW, ETC.: |
| Well No. 1-3 OWWO | Lease Name Dodson | oil |
| S 28 T 9S R 21 ^{XK} _W | | |

WELL LOG

Show all important zones of porosity and contents thereof; cored intervals, and all drill-stem tests, including depth interval tested, cushion used, time tool open, flowing and shut-in pressures, and recoveries.

SHOW GEOLOGICAL MARKERS, LOGS RUN, OR OTHER DESCRIPTIVE INFORMATION.

| FORMATION DESCRIPTION, CONTENTS, ETC. | TOP | BOTTOM | NAME | DEPTH |
|---|-------|--------|------|-------|
| OWWO - Did not drill deeper (well log previously filed-Eld. Refg. #3 Dodson--Comp 5/18/56) nn | ----- | ----- | | |

USE ADDITIONAL SHEETS, IF NECESSARY, TO COMPLETE WELL RECORD.

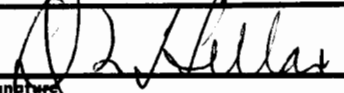
| | |
|---------------|---|
| Date Received | Earl M. Knighton by  |
| | Operator Signature |
| | 1/23/79 Title |
| | Date |

61112