

WICHITA BRANCH  
KANSAS DRILLERS LOG

S. 33 T. 9 R. 21 <sup>R</sup> W

Loc. \_\_\_\_\_  
County \_\_\_\_\_

API No. 15 — GRAHAM — OWWO  
County Number

Operator  
**EARL M. KNIGHTON**

Address  
**710 PETROLEUM BUILDING - WICHITA, KANSAS 67202**

Well No. #1 Lease Name Cox OWWO

Footage Location  
330 feet from (N) ~~XX~~ line 330 feet from ~~XX~~ (W) line

Principal Contractor **CHASE WELL SERVICE** Geologist **None**

Spud Date **October 25, 1977** Total Depth **3900** P.B.T.D. -----

Date Completed **November 7, 1977** Oil Purchaser **Mobil**

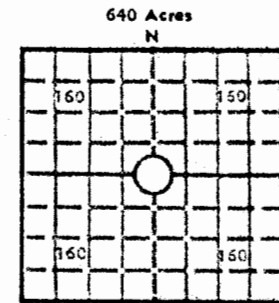

Elev.: Gr. \_\_\_\_\_  
DF \_\_\_\_\_ KB **2335**

**CASING RECORD**

Report of all strings set — surface, intermediate, production, etc.

Purpose of string	Size hole drilled	Size casing set (in O.D.)	Weight lbs/ft.	Setting depth	Type cement	Sacks	Type and percent additives
Surface	12 1/4"	8 5/8"	?	255'	?	150	?
Production	7 7/8"	5 1/2"	?	3897'	?	75	?
						(DV @ 1600', 500 Sks)	

**LINER RECORD**

**PERFORATION RECORD**

Top, ft.	Bottom, ft.	Sacks cement	Shots per ft.	Size & type	Depth interval
<b>TUBING RECORD</b>					
Size 2"	Setting depth 3887'	Packer set at			

**ACID, FRACTURE, SHOT, CEMENT SQUEEZE RECORD**

Amount and kind of material used	Depth interval treated
None	

**INITIAL PRODUCTION**

Date of first production <b>November 18, 1977</b>	Producing method (flowing, pumping, gas lift, etc.) <b>Pumping</b>			
RATE OF PRODUCTION PER 24 HOURS	Oil 4 bbls.	Gas --- MCF	Water 25 bbls.	Gas-oil ratio ----- CFPB
Disposition of gas (vented, used on lease or sold) <b>None</b>	Producing interval(s) <b>3897-3900</b>			

INSTRUCTIONS: As provided in KCC Rule 82-2-125, within 90 days after completion of a well, one completed copy of this Drillers Log shall be transmitted to the State Geological Survey of Kansas, 4150 Monroe Street, Wichita, Kansas 67209. Copies of this form are available from the Conservation Division, State Corporation Commission, 3830 So. Meridian (P.O. Box 17027), Wichita, Kansas 66217. Phone AC 316-522-2206. If confidential custody is desired, please note Rule 82-2-125. Drillers Logs will be on open file in the Oil and Gas Division, State Geological Survey of Kansas, Lawrence, Kansas 66044.

Operator Earl M. Knighton		DESIGNATE TYPE OF COMP.: OIL, GAS, DRY HOLE, SWDW, ETC.: Oil
Well No. 1	Lease Name Cox	
S 33 T 9 R 21 W		
<b>WELL LOG</b>		SHOW GEOLOGICAL MARKERS, LOGS RUN, OR OTHER DESCRIPTIVE INFORMATION.
Show all important zones of porosity and contents thereof; cored intervals, and all drill-stem tests, including depth interval tested, cushion used, time tool open, flowing and shut-in pressures, and recoveries.		
FORMATION DESCRIPTION, CONTENTS, ETC.	TOP	BOTTOM
	NAME	DEPTH

WELL LOG BUREAU—KANSAS GEOLOGICAL SOCIETY  
608 East Murdock, Wichita, Kansas

COPY

Company- EL DORADO REFINING COMPANY  
Farm- Cox No. 5

SEC. 33 T. 9 R-21W  
NE NW NW

Total Depth. 3903  
Comm. 5-12-56 Comp. 5-19-56  
Shot or Treated.  
Contractor.  
issued. 7-7-56

County Graham  
KANSAS

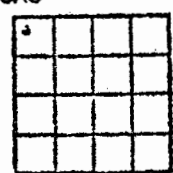

CASING:  
8 5/8" 255' cem w/150 ex.  
5 1/2" 3900' cem w/575 ex.

Elevation. 2335 D.F.

Production. 2130 BOPD

Figures indicate Bottom of Formations.

clay, shale	60
sand	95
shale	820
sand, shale	1555
shale red, shells	1795
anhydrite	1840
shale, shells	2250
shale, lime	3545
lime	3820
lime, shale	3903
Total Depth	

Tops: (Scout)

Anhydrite	1795
Heebner	3515
Toronto	3542
Lansing	3552
Base Kansas City	3781
Congl.	3846
Arbuckle	3893

USE ADDITIONAL SHEETS, IF NECESSARY, TO COMPLETE WELL RECORD.

Date Received	<i>Earl M. Knighton</i> Signature
	Operator
	12/27/77 Date

1841t