

Wichita, Kansas

# S NEW ACO-1 FORM

SIDE ONE

✓  
Inv  
13-9-22 W  
P1

STATE CORPORATION COMMISSION OF KANSAS  
OIL & GAS CONSERVATION DIVISION

## WELL COMPLETION OR RECOMPLETION FORM ACO-1 WELL HISTORY

### DESCRIPTION OF WELL AND LEASE

Operator: license # 5463  
name Samson Resources Company  
address Samson Plaza  
Two West Second Street  
City State Zip Tulsa, Oklahoma 74103

Operator Contact Person R. J. Davis  
Phone (918) 583-1791

Contractor: license # 5420  
name White & Ellis Drilling, Inc.

Site Geologist Keith Reavis  
Phone (316) 792-1383

PURCHASER Bigheart

Designate Type of Completion  
New Well Re-Entry Workover  
Oil XX SWD Temp Abd  
Gas Inj Delayed Comp.  
Dry Other (Core, Water Supply etc.)

If OWWO: old well info as follows:  
Operator  
Well Name  
Comp. Date Old Total Depth

### WELL HISTORY

Drilling Method: X Mud Rotary Air Rotary Cable  
2-18-85 2-25-85 2-26-85  
Spud Date Date Reached TD Completion Date

34' 3884'  
Total Depth PBTD

Amount of Surface Pipe Set and Cemented at 274 feet

Multiple Stage Cementing Collar Used? X Yes No

If Yes, Show Depth Set 1750 feet

If alternate 2 completion, cement circulated  
from 1750 feet depth to surface w/ 500 SX cmt

API NO. 15 065-22,139

County Graham

NE/4 Sec 13 Twp 9 Rge 22 West

3250 Ft North from Southeast Corner of Section  
1470 Ft West from Southeast Corner of Section  
(Note: locate well in section plat below)

Lease Name Buss "C" Well # 6

Field Name Morel

Producing Formation Arbuckle

Elevation: Ground 2273' KB 2278'

Section Plat

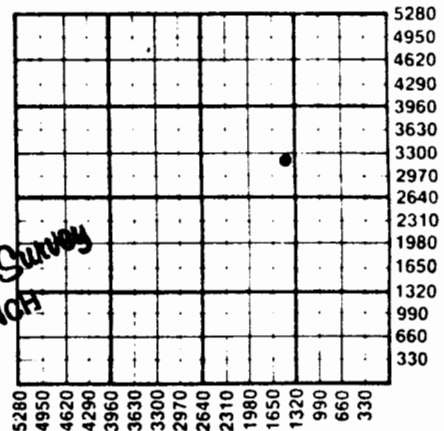

NOV 18 1985  
State Geological Survey  
WICHITA BRANCH

### WATER SUPPLY INFORMATION

Source of Water:  
Division of Water Resources Permit # N/A

Groundwater Ft North From Southeast Corner and  
(Well) Ft West From Southeast Corner of  
Sec Twp Rge East West

X Surface Water Ft North From Southeast Corner and  
(Stream, Pond etc.) Pond Ft West From Southeast Corner  
NW/4 Sec 11 Twp 9S Rge 22 East XX West

Landowners (George Buss) and Roy Van Loenen  
X Other (explain) Hauled by White & Ellis, Inc.  
(purchased from city, R.W.D.#)

Disposition of Produced Water: X Disposal  
Repressuring

Docket # D-24,221

**INSTRUCTIONS:** This form shall be completed in duplicate and filed with the Kansas Corporation Commission, 200 Colorado Derby Building, Wichita, Kansas 67202, within 90 days after completion or recompletion of any well. Rules 82-3-130 and 82-3-107 apply.  
Information on side two of this form will be held confidential for a period of 12 months if requested in writing and submitted with the form. See rule 82-3-107 for confidentiality in excess of 12 months.

63733

**SIDE TWO**

Operator Name Samson Resources Company Lease Name Buss "C" Well# 6 SEC 13 TWP 9 RGE 22  East  West

**WELL LOG**

**INSTRUCTIONS:** Show important tops and base of formations penetrated. Detail all cores. Report all drill stem tests giving interval tested, time tool open and closed, flowing and shut-in pressures, whether shut-in pressure reached static level, hydrostatic pressures, bottom hole temperature, fluid recovery, and flow rates if gas to surface during test. Attach extra sheet if more space is needed. Attach copy of log.

Drill Stem Tests Taken  Yes  No  
 Samples Sent to Geological Survey  Yes  No  
 Cores Taken  Yes  No

Formation Description  
 Log  Sample

LOG TOPS

Heebner	3436	(-1150)
Toronto	3460	(-1183)
Lansing	3475	(-1198)
Base/Kansas City	3689	(-1412)
Conglomerate	3769	(-1492)
Arbuckle	3791	(-1514)
R.T.D.	3900	(-1623)
L.T.D.	3901	(-1624)

Name	Top	Bottom
Cellar	0'	8'
Shale, Sand	8'	1851'
Shale, Lime	1851'	2487'
Shale	2487'	2867'
Shale, Lime	2867'	3225'
Lime, Shale	3225'	3900'

<b>TUBING RECORD</b> size <u>3-1/2"</u> set at <u>3860</u> packer at <u>3860</u>		Liner Run <input type="checkbox"/> Yes <input checked="" type="checkbox"/> No	
Date of First Production	Producing method <input type="checkbox"/> flowing <input checked="" type="checkbox"/> pumping <input type="checkbox"/> gas lift <input type="checkbox"/> Other (explain) _____		
Estimated Production Per 24 Hours	Oil	Gas	Water
	None Bbls	None MCF	None Bbls
		Gas-Oil Ratio	Gravity
		CFPB	

Disposition of gas:  vented  open hole  perforation  
 sold  other (specify) \_\_\_\_\_  
 used on lease  Dually Completed.  
 Commingled

**PRODUCTION INTERVAL**  
3898' to 4264'

<b>CASING RECORD</b> <input type="checkbox"/> new <input type="checkbox"/> used							
Report all strings set - conductor, surface, intermediate, production, etc.							
Purpose of string	size hole drilled	size casing set (in O.D.)	weight lbs/ft.	setting depth	type of cement	# sacks used	type and percent additives
Surface		<u>10-3/4"</u>		<u>274'</u>		<u>190</u>	<u>2% gel, 3% cc</u>
Production		<u>7"</u>		<u>3899'</u>		<u>750</u>	

<b>PERFORATION RECORD</b>		<b>Acid, Fracture, Shot, Cement Squeeze Record</b>	
shots per foot	specify footage of each interval perforated	(amount and kind of material used)	Depth
<u>2</u>	<u>3898' to 4264'</u>		

P1



13-9-22W  
MAR 14 1985 \*  
State Geological Survey  
WICHITA BRANCH

# WHITE

AND ELLIS DRILLING, Inc.

## DRILLERS LOG

OPERATOR: Samson Resources, Inc.  
 2 West Second Street  
 Tulsa, OK 74103

CONTRACTOR: White & Ellis Drilling, Inc., 401 E. Douglas, Suite 500,  
 Wichita, Ks. 67202

Lease Name Buss Well No.          C #6         

Sec. 13 T. 9S R. 22W Spot SE SW NE

County Graham State Kansas Elevation         

### Casing Record:

Surface: 10 3/4" @ 273' with 190 sx., 2% gel, 3% cc

Production: 7" @ 3899' with 700 sx.

Type Well: Oil Well Total Depth 3900'

Drilling Commenced 2-19-85 Drilling Completed 2-26-85

Formation	From	To	Tops
Cellar	0	8	
Shale, Sand	8	1851	
Shale, Lime	1851	2487	
Shale	2487	2867	
Shale, Lime	2867	3225	
Lime, Shale	3225	3900	