

*State Geological Survey*  
WICHITA BRANCH

15-065-20454

**KANSAS DRILLERS LOG**

S. 14 T. 9 R. 23 <sup>E</sup>/<sub>W</sub>  
Loc. SE NE SE  
County Graham

API No. 15 — 065 — 20,954  
County Number

Operator  
Associates O&G and Bill J. Porter

Address  
501 - 120 S. Market Wichita, Kansas 67202

Well No. #1 Lease Name Bethell

Footage Location  
feet from (N) (S) line feet from (E) (W) line

Principal Contractor Geologist

Spud Date Total Depth P.B.T.D.

Date Completed Oil Purchaser

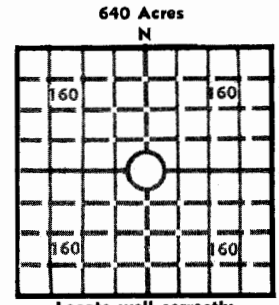

Elev.: Gr. \_\_\_\_\_  
DF \_\_\_\_\_ KB \_\_\_\_\_

**CASING RECORD**

Report of all strings set — surface, intermediate, production, etc.

Purpose of string	Size hole drilled	Size casing set (in O.D.)	Weight lbs/ft.	Setting depth	Type cement	Sacks	Type and percent additives

**LINER RECORD**

**PERFORATION RECORD**

Top, ft.	Bottom, ft.	Sacks cement	Shots per ft.	Size & type	Depth interval

**TUBING RECORD**

Size	Setting depth	Packer set at

**ACID, FRACTURE, SHOT, CEMENT SQUEEZE RECORD**

Amount and kind of material used	Depth interval treated

**INITIAL PRODUCTION**

Date of first production	Producing method (flowing, pumping, gas lift, etc.)			
<b>RATE OF PRODUCTION PER 24 HOURS</b>	Oil bbls.	Gas MCF	Water bbls.	Gas-oil ratio CFPB
Disposition of gas (vented, used on lease or sold)			Producing interval (s)	

**INSTRUCTIONS:** As provided in KCC Rule 82-2-125, within 90 days after completion of a well, one completed copy of this Drillers Log shall be transmitted to the State Geological Survey of Kansas, 4150 Monroe Street, Wichita, Kansas 67209. Copies of this form are available from the Conservation Division, State Corporation Commission, 3830 So. Meridian (P.O. Box 17027), Wichita, Kansas 66217. Phone AC 316-522-2206. If confidential custody is desired, please note Rule 82-2-125. Drillers Logs will be on open file in the Oil and Gas Division, State Geological Survey of Kansas, Lawrence, Kansas 66044.



# DREILING OIL, INC.

Victoria, Kansas 67671

## WELL LOG

Company **Associates Oil & Gas**  
**Suite 501 - 120 Bldg.**  
**Wichita, KS 67202**

Farm **Bethell** No. 1

Total Depth **3870'**

Comm. **4-18-78** Comp. **4-24-78**

Contractor **Dreiling Oil, Inc.**  
**R.R. #1**  
**Victoria, KS 67671**

Sec. 14 Twp. 9 Rng. 23

Location **500' FNL - 330' FEL**  
**SE/4**

County **Graham**

Elevation: **2343 K. B.**

**2340 D. F.**

**2338 G. R.**

### Casing Record

**207' - 8 5/8"**  
**3868' - 4 1/2"**

### Cement Record

**135 sacks cement**  
**125 scks cement**

### Production:

Figures Indicate Bottom of Formations

0'  
40'  
212'  
737'  
1470'  
1683'  
1780'  
1936'  
1968'  
2208'  
2508'  
2743'  
2960'  
3140'  
3295'  
3519'  
3702'  
3810'  
3848'  
3870'

40'  
212'  
737'  
1470'  
1683'  
1780'  
1936'  
1968'  
2208'  
2508'  
2743'  
2960'  
3140'  
3295'  
3519'  
3702'  
3810'  
3848'  
3870'  
T.D.

**PostRock**  
Shale  
Shale  
Shale & Sand  
Sand  
Shale  
Shale  
Snhydrite  
Shale  
Shale  
Shale  
Shale  
Shale  
Shale & Lime  
Shale  
Shale & Lime  
Shale & Lime  
Lime  
Lime  
Lime