

KANSAS CORPORATION COMMISSION

WELL RECORD

19-9-23W

(Mail to Kansas Geological Survey, 4150 Monroe Street, Wichita, Kansas 67209)

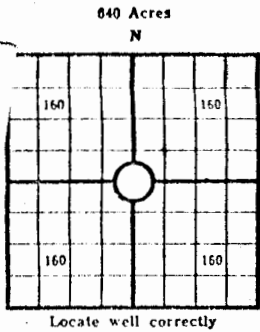

Lease Name: HARVEY Well No. 1
 Well Located: C NE NW 440 FNL, 440 FEL NW
Graham Co. SEC 19 TWP 9S RGE 23W
 Operator: A. L. Abercrombie, Inc.
 Address: 801 Union Center, Wichita, Kansas 67202
 Elevation: Ground 2390 D.F. 2396 K.B. 2398
 Type Well: (Oil, gas, dry hole) oil 86 BOPD

Drilling Commenced: January 23, 1972 Drilling Completed: Feb. 1, 1972
 Well Completed: 19 Total Depth 3984'
 Initial Production: 86 BOPD, 39° gravity

Feb. 2 '72

Casing Record

Size: 8-5/8" Set at 225' Size: _____ Set at _____
 Size: 4-1/2" Set at 3981' Size: _____ Set at _____

Drilled 227' of 12 1/2" surface hole. Set 8-5/8" surface csg. at 217'. Cemented w/150 sx. Sunset cement. Cement circulated. Plug was down at 9:45 p.m. 1-23-72. Ran 4 1/2", 9 1/2 lb., csg. set @3981'. Cemented w/20 bbls. mud flush and 150 sx. salt saturated cement. Plug was down at 3:00 p.m. 2-1-72.

Cementing

Casing Size	Sacks	Type Cement and Additives
<u>8-5/8"</u>	<u>150</u>	<u>Sunset</u>
<u>4-1/2"</u>	<u>150</u>	<u>Salt saturated</u>

Perforations

Formation	Perforated Interval and Number Shots
_____	<u>3812-3814 8 shots</u>
_____	_____
_____	_____
_____	_____

Electric Log Run (Show type log and depths covered)

R.A. Guard Log 2000-2100
3400-T.D.

Show Drill Stem Tests,
Well Stimulation and
Production Tests

19-9-23w
p. 2

Formation Top Bottom

Lansing-K.C.	3761'	3785'	10" - 30" - 30" - 45" Rec. 10' mud IFP 28-28#, IBHP 907# FFP 32-32#, FBHP 863. BHT 103°.
Lansing-K.C.	3801'	3825'	10" - 30" - 60" - 45" Rec. 640' gas in pipe, 60' SO&GCM, 180' HO & GCM, 180' free oil, 60' muddy oil, 60' HO & GC watery mud, 120' SOC watery mud, 120' water. IFP 31-74#, IBHP 888#, FFP 106#, FBHP 872#.
Lansing-K.C.	3883'	3923'	30" - 30" - 60" - 45" Rec. 150' muddy water w/spots of oil, IFP 31-42#, IBHP 1114#, FFP. 63-85#, FBHP 983#.
Lansing-K.C. Straddle Test	3802'	3818'	10" - 30" - 120" - 45" Rec. 750' gas in pipe, 30' SO & GCM, 60' HO & GCM, 120' gassy oil and 390' oil, IFP 31-42#, IBHP 888#, FFP 74-230#, FBHP 867#, BHT 109°.
Lansing-K.C.	3812'	3814'	A/500 gal., swabbed 11 BOPH A/1500 gal., swabbed 7.5 BOPH

LOG TOPS DEPTH

	0	50	Sand, Clay & Rock
ANHY	2040	50	Shale
B ANHY	2076	1080	Sand
TOP	3484	1278	Shale
HEEB	3699	1402	Sand
TOR	3725	1425	Shale
LANS	3740	1697	Sand
BKC	3959	1785	Shale
LTD	3983	2040	Anhydrite
RTD	3984	2074	Shale
		2700	Lime & Shale
		3150	Shale & Lime
		3603	Lime & Shale
		3710	Lime
		3785	Lime & Chert
		3820	Lime
		3965	Shale & Lime
		3984	Rotary Total Depth
		3984	

ELECTRIC LOG TOPS

Anhydrite	2040 (+ 358)
B/Anhydrite	2076 (+ 322)
Topeka	3484 (-1086)
Heebner	3699 (-1301)
Toronto	3725 (-1327)
Lansing	3740 (-1342)
B/K.C.	3959 (-1561)
ELTD	3983 (-1585)