

PI

**KANSAS DRILLERS LOG**

State Geological Survey  
 WICHITA, KANSAS  
 S. 218 T. 9S R. 23W  
 SE NE NW

API No. 15 — 065 — 21,161  
 County Number

Loc. SE NE NW  
 County Graham

Operator  
 John O. Farmer, Inc.

Address  
 P.O. Box 352, Russell, KS 67665

Well No. #4 Lease Name Albertson

Footage Location  
 990 feet from (N) ~~XX~~ line 330 feet from (E) ~~XX~~ line

Principal Contractor John O. Farmer, Inc. Geologist Sam L. Farmer

Spud Date 9-13-80 Total Depth 3950' P.B.T.D. 3919'

Date Completed 9-21-80 Oil Purchaser Mobil Oil Corporation

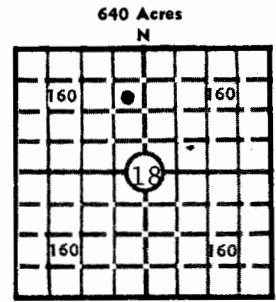

Elev.: Gr. 2365'  
 DF 2368' KB 2370'

**CASING RECORD**

Report of all strings set — surface, intermediate, production, etc.

Purpose of string	Size hole drilled	Size casing set (in O.D.)	Weight lbs/ft.	Setting depth	Type cement	Sacks	Type and percent additives
Surface	12-1/4"	8-5/8"	24	203'	Common	165	3% C.C.
Production	7-7/8"	4-1/2"	9-1/2	3948'	50-50 Pozmix	150	10% Salt
			DV Tool	@ 2042'	Halco Light	325	

**LINER RECORD**

**PERFORATION RECORD**

Top, ft.	Bottom, ft.	Sacks cement	Shots per ft.	Size & type	Depth interval
---	---	---	4	SSB Jets	3870

**TUBING RECORD**

Size	Setting depth	Packer set at
2-3/8"	3883	---

**ACID, FRACTURE, SHOT, CEMENT SQUEEZE RECORD**

Amount and kind of material used	Depth interval treated
2000 gal. 15% NE	3870-76

**INITIAL PRODUCTION**

Date of first production November 12, 1980	Producing method (flowing, pumping, gas lift, etc.) Pumping
RATE OF PRODUCTION PER 24 HOURS	Oil 20 bbls. Gas --- MCF Water 0 bbls. Gas-oil ratio --- CFPB
Disposition of gas (vented, used on lease or sold) ---	Producing interval (s) 3870-76

INSTRUCTIONS: As provided in KCC Rule 82-2-125, within 90 days after completion of a well, one completed copy of this Drillers Log shall be transmitted to the State Geological Survey of Kansas, 4150 Monroe Street, Wichita, Kansas 67209. Copies of this form are available from the Conservation Division, State Corporation Commission, 3830 So. Meridian (P.O. Box 17027), Wichita, Kansas 66217. Phone AC 316-522-2206. If confidential custody is desired, please note Rule 82-2-125. Drillers Logs will be on open file in the Oil and Gas Division, State Geological Survey of Kansas, Lawrence, Kansas 66044.

Operator John O. Farmer, Inc.		DESIGNATE TYPE OF COMP.: OIL, GAS, DRY HOLE, SWDW, ETC.:
Well No. #4	Lease Name Albertson	Oil
S 18 T9S R23W <del>XX</del> W		

**WELL LOG**

Show all important zones of porosity and contents thereof; cored intervals, and all drill-stem tests, including depth interval tested, cushion used, time tool open, flowing and shut-in pressures, and recoveries.

SHOW GEOLOGICAL MARKERS, LOGS RUN, OR OTHER DESCRIPTIVE INFORMATION.

FORMATION DESCRIPTION, CONTENTS, ETC.	TOP	BOTTOM	NAME	DEPTH
Blue Shale	0	205		<u>Log Tops</u>
Sand & Shale	205	935		
Shale & Sand	935	1575	Anhydrite	2038 (+332)
Sand	1575	1780	Heebner	3675 (-1305)
Red Bed	1780	2021	Toronto	3700 (-1330)
Anhydrite	2021	2071	Lansing	3717 (-1347)
Shale	2071	2155	B/KC	3948 (-1578)
Shale & Lime	2155	3240	T.D.	3951 (-1581)
Lime & Shale	3240	3640		
Lime	3640	3950		
<p>DST #1 3855-3875            Tool open 30-60-90-90 with fair blow            Rec: 120' gas                  75' heavy oil cut mud            FP: 43-43            BHP: 305-283</p> <p>DST #2 3874-3920            Tool open 30-30-30-30 - weak blow - 18 min.            Rec: 15' very slightly oil spot mud            FP: 43-54            BHP: 954-694</p>				

USE ADDITIONAL SHEETS, IF NECESSARY, TO COMPLETE WELL RECORD.

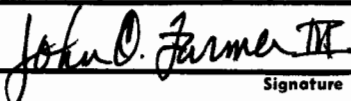
Date Received	
	Signature
	Vice-President
	Title
	December 4, 1980
	Date

10980