

*md*

SIDE ONE

18-9-23W P

STATE CORPORATION COMMISSION OF KANSAS  
OIL & GAS CONSERVATION DIVISION

WELL COMPLETION OR RECOMPLETION FORM  
ACO-1 WELL HISTORY

DESCRIPTION OF WELL AND LEASE

Operator: License # 5135  
Name John O. Farmer, Inc.  
Address P.O. Box 352  
Russell, KS 67665  
City/State/Zip

Purchaser Mobil Oil Corporation  
P.O. Box 2080, Dallas, TX 75221

Operator Contact Person John O. Farmer III  
Phone (913) 483-3144

Contractor: License # 5135  
Name John O. Farmer, Inc.

Wellsite Geologist Sam L. Farmer  
Phone (913) 483-3144

Designate Type of Completion

New Well  Re-Entry  Workover

Oil  SWD  Temp Abd  
 Gas  Inj  Delayed Comp.  
 Dry  Other (Core, Water Supply etc.)

If OWWO: old well info as follows:

Operator  
Well Name  
Comp. Date Old Total Depth

WELL HISTORY

Drilling Method:

Mud Rotary  Air Rotary  Cable

9-22-80 9-29-80 9-30-80  
Spud Date Date Reached TD Completion Date  
4020' 4003'  
Total Depth PBTD

Amount of Surface Pipe Set and Cemented at 212 feet  
Multiple Stage Cementing Collar Used?  Yes  No  
If yes, show depth set...feet  
If alternate 2 completion, cement circulated  
from 212 feet depth to surface/165 SX cmt

API NO. 15-065-21.160

County Graham

SE NW SE Sec. 18 Twp. 9S Rge. 23  East  West

1650 Ft North from Southeast Corner of Section  
1650 Ft West from Southeast Corner of Section  
(Note: Locate well in section plat below)

Lease Name Klenk Well # 5

Field Name Ernst Northwest

Producing Formation Lansing "I"

Elevation: Ground 2422' KB 2427'

Section Plat

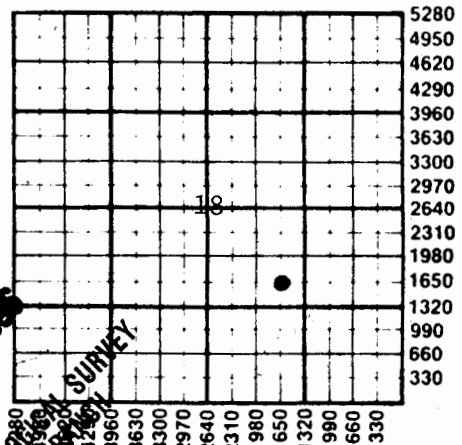

Disposition of Produced Water:  Disposal  Repressuring  
Docket # E-23-923

Questions on this portion of the ACO-1 call:  
Water Resources Board (913) 296-3717

Source of Water:  
Division of Water Resources Permit #  
 Groundwater.....Ft North from Southeast Corner  
(Well) .....Ft West from Southeast Corner of  
Sec Twp Rge  East  West  
 Surface Water.....Ft North from Southeast Corner  
(Stream, pond etc).....Ft West from Southeast Corner  
Sec Twp Rge  East  West  
 Other (explain).....  
(purchased from city, R.W.D. #)

INSTRUCTIONS: This form shall be completed in duplicate and filed with the Kansas Corporation Commission, 200 Colorado Derby Building, Wichita, Kansas 67202, within 90 days after completion or recompletion of any well. Rule 82-3-130 and 82-3-107 apply. Information on side two of this form will be held confidential for a period of 12 months if requested.

68677

SIDE 200

Operator Name ..... John O. Farmer, Inc. ..... Lease Name ..... Klenk ..... Well #. 5 .....

Sec. 18 ..... Twp. 9S ..... Rge. 23 .....  East  West ..... County ..... Graham .....

WELL LOG

INSTRUCTIONS: Show important tops and base of formations penetrated. Detail all cores. Report all drill stem tests giving interval tested, time tool open and closed, flowing and shut-in pressures, whether shut-in pressure reached static level, hydrostatic pressures, bottom hole temperature, fluid recovery, and flow rates if gas to surface during test. Attach extra sheet if more space is needed. Attach copy of log.

Drill Stem Tests Taken  Yes  No  
 Samples Sent to Geological Survey  Yes  No  
 Cores Taken  Yes  No

Blue Shale	0	212
Sand & Shale	212	1312
Shale & Sand	1312	1603
Sand	1603	1805
Red Bed	1805	2064
Anhydrite	2064	2100
Shale & Shells	2100	2385
Lime & Shale	2385	2550
Shale & Lime	2550	2995
Lime & Shale	2995	3280
Shale & Lime	3280	3435
Lime & Shale	3435	3845
Lime	3845	4020

Formation Description  Log  Sample

Name	Top	Bottom
Anhydrite	2064	(+363)
Heebner	3723	(-1296)
Toronto	3749	(-1322)
Lansing	3766	(-1339)
L.T.D.	4019	(-1592)

DST #1 3906-26'  
 Tool open 60-60-90-90; weak blow  
 Rec: 60' gas  
 120' heavy oil cut mud  
 FP: 20-30  
 BHP: 110-130

APR 25 1966  
 KANSAS GEOLOGICAL SURVEY  
 WICHITA BRANCH

**CASING RECORD**  New  Used  
 Report all strings set-conductor, surface, intermediate, production, etc.

Purpose of String	Size Hole Drilled	Size Casing Set (in O.D.)	Weight Lbs/Ft.	Setting Depth	Type of Cement	#Sacks Used	Type and Percent Additives
Surface	12-1/4"	8-5/8"	24#	212'	Common	165	3% C.C.
Production	7-7/8"	4-1/2"	9#	4018'	50-50 Poz	150	10% salt
D.V. Tool				2077'	Halco Light	375	

**PERFORATION RECORD**  Acid, Fracture, Shot, Cement Squeeze Record  
 (Amount and Kind of Material Used)

Shots Per Foot	Specify Footage of Each Interval Perforated	Depth
4	3915-20'	2000 gal, 15% NE
		3915-20'

**TUBING RECORD**

Size	Set At	Packer at	Liner Run	<input type="checkbox"/> Yes <input checked="" type="checkbox"/> No
2-3/8"	4000'	--		