

IMPORTANT
Kans. Geo. Survey request samples on this well.

15-065-21061

WICHITA BRANCH
KANSAS DRILLERS LOG

S. 12 T. 9 R. 24 ^E/_W
Loc. C SW NW SW
County Graham

API No. 15 — 065 — 21,061
County Number

Operator
Barnett Oil, Inc.

Address
1625 Vickers KSB&T Building Wichita, Kansas 67202

Well No. # 1 Lease Name Hildebrand

Footage Location
feet from (N) (S) line feet from (E) (W) line

Principal Contractor Murfin Drilling Co. Geologist R. B. Gebhart, Jr.

Spud Date September 21, 1978 Total Depth 3853' P.B.T.D.

Date Completed September 25, 1978 Oil Purchaser

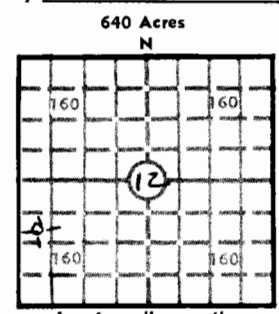

Elev.: Gr. 2456'
DF 2458' KB 2461'

CASING RECORD

Report of all strings set — surface, intermediate, production, etc.

Purpose of string	Size hole drilled	Size casing set (in O.D.)	Weight lbs/ft.	Setting depth	Type cement	Sacks	Type and percent additives
surface	12 1/2"	8-5/8"		214'	Pozmix	150	2% gel

LINER RECORD

PERFORATION RECORD

Top, ft.	Bottom, ft.	Sacks cement	Shots per ft.	Size & type	Depth interval

TUBING RECORD

Size	Setting depth	Packer set at

ACID, FRACTURE, SHOT, CEMENT SQUEEZE RECORD

Amount and kind of material used	Depth interval treated

INITIAL PRODUCTION

Date of first production	Producing method (flowing, pumping, gas lift, etc.)
RATE OF PRODUCTION PER 24 HOURS	Oil Gas Water Gas-oil ratio
	bbis. MCF bbis. CFPB
Disposition of gas (vented, used on lease or sold)	Producing interval(s)

INSTRUCTIONS: As provided in KCC Rule 82-2-125, within 90 days after completion of a well, one completed copy of this Drillers Log shall be transmitted to the State Geological Survey of Kansas, 4150 Monroe Street, Wichita, Kansas 67209. Copies of this form are available from the Conservation Division, State Corporation Commission, 3830 So. Meridian (P.O. Box 17027), Wichita, Kansas 66217. Phone AC 316-522-2206. If confidential custody is desired, please note Rule 82-2-125. Drillers Logs will be on open file in the Oil and Gas Division, State Geological Survey of Kansas, Lawrence, Kansas 66044.

Operator Barnett Oil, Inc. DESIGNATE TYPE OF COMP.: OIL, GAS, DRY HOLE, SWDW, ETC.: Dry hole

Well No. 1 Lease Name Hildebrand

S 12 T 9S R 24 K W

WELL LOG Show all important zones of porosity and contents thereof; cored intervals, and all drill-stem tests, including depth interval tested, cushion used, time tool open, flowing and shut-in pressures, and recoveries. SHOW GEOLOGICAL MARKERS, LOGS RUN, OR OTHER DESCRIPTIVE INFORMATION.

Table with 5 columns: FORMATION DESCRIPTION, CONTENTS, ETC., TOP, BOTTOM, NAME, DEPTH. Rows include Anhydrite, Base Anhy., Topeka, Heebner, Toronto, and Lansing with depth measurements.

No electric log. No D.S.T.

USE ADDITIONAL SHEETS, IF NECESSARY, TO COMPLETE WELL RECORD.

Date Received Signature: [Handwritten Signature] Title: Vice President-Operations Date: October 24, 1978

9L1L9

WELL LOG

15-065-21061

COMPANY Barnett Oil, Inc.

SEC. 12 T. 9S R. 24W

FARM HILDEBRAND NO. 1

LOC. SW NW SW

RIG. NO. 16

TOTAL DEPTH 3853'

COUNTY Graham
KANSAS

COMM. September 21, 1978

COMP. September 25, 1978

CONTRACTOR Murfin Drilling Company

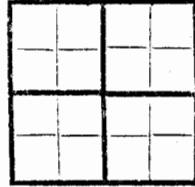

CASING

20	10	
15		8-5/8" @ 214' w/150 sx.
12	5	
13	5	

ELEVATION

PRODUCTION

FIGURES INDICATE BOTTOM OF FORMATIONS

93'	Surface soils & Clay
112'	Sand & Shale
128'	Shale, Clay & Sand
140'	Sand
217'	Shale
1485'	Sand & Shale
1675'	Clay & Shale
1865'	Sand
2119'	Shale
2158'	Anhydrite
2725'	Shale
3095'	Shale & Lime
3400'	Shale
3555'	Lime & Shale
3710'	Shale
3853'	Lime & Shale

RTD