

RELEASED

SIDE ONE

2/17/88

KCC

27-9-26W

STATE CORPORATION COMMISSION OF KANSAS
OIL & GAS CONSERVATION DIVISION
WELL COMPLETION OR RECOMPLETION FORM
FROM CONFIDENTIAL ACQ-1 WELL HISTORY
DESCRIPTION OF WELL AND LEASE

API NO. 15-.....179-20,886.....
County.....Sheridan.....
NW SE SW.....Sec.27..Twp.9S..Rge.26W. X West

Operator: License #5146.....
NameRains & Williamson Oil Co., Inc.....
Address435 Page Court, 220 W. Douglas
Wichita, KS 67202.....
City/State/Zip

990 Ft North from Southeast Corner of Section
3630 Ft West from Southeast Corner of Section
(Note: Locate well in section plat below)

Lease Name.....L. & K. Simon.....Well #...1....

Purchaser.....

Field Name.....

Operator Contact PersonJuanita Green.....
Phone265-9686.....

Producing Formation.....

Elevation: Ground.....2627.....KB.....2632.....

Contractor: License #
NameRains & Williamson Oil Co., Inc.....

Wellsite Geologist.....
Phone.....

Designate Type of Completion
 New Well Re-Entry Workover
 Oil SWD Temp Abd
 Gas Inj Delayed Comp.
 Dry Other (Core, Water Supply etc.)

KANSAS GEOLOGICAL SURVEY

FEB 18 1988

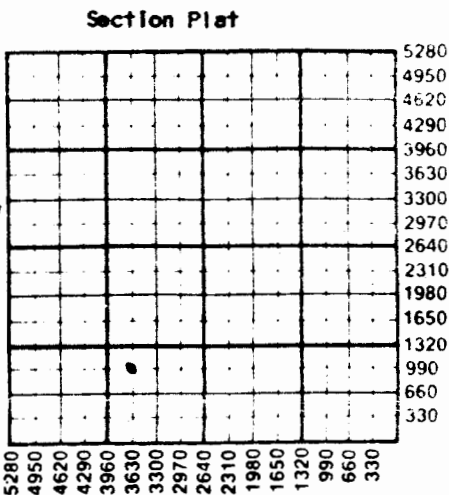

If OWNO: old well info as follows:
Operator,
Well Name,
Comp. Date, Old Total Depth.....

WELL HISTORY

Drilling Method:
 Mud Rotary Air Rotary Cable
1-26-872-1-87.....2-1-87.....
Spud Date Date Reached TD Completion Date
4135',
Total Depth PBD

Amount of Surface Pipe Set and Cemented at 307' feet
Multiple Stage Cementing Collar Used? Yes No
If yes, show depth set.....feet
If alternate 2 completion, cement circulated
from.....feet depth to.....w/.....SX cmt
Cement Company Name,
Invoice #

WATER SUPPLY INFORMATION
Disposition of Produced Water: Disposal
Docket # Repressuring

Questions on this portion of the ACQ-1 call:
Water Resources Board (913) 296-3717
Source of Water:
Division of Water Resources Permit #.....
 Groundwater.....Ft North from Southeast Corner
(Well)Ft West from Southeast Corner of
Sec Twp Rge East West
 Surface Water.....Ft North from Southeast Corner
(Stream, pond etc).....Ft West from Southeast Corner
Sec Twp Rge East West
 Other (explain).....
(purchased from city, R.W.D. #)

INSTRUCTIONS: This form shall be completed in triplicate and filed with the Kansas Corporation Commission, 200 Colorado Derby Building, Wichita, Kansas 67202, within 120 days of the spud date of any well. Rule 82-3-130, 82-3-107 and 82-3-106 apply. Information on side two of this form will be held confidential for a period of 12 months if requested in writing and submitted with the form. See rule 82-3-107 for confidentiality in excess of 12 months. One copy of all wireline logs and drillers time log shall be attached with this form. Submit CP-4 form with all plugged wells. Submit CP-111 form with all temporarily abandoned wells.

All regulations promulgated to regulate the oil and gas industry have been fully complied with, and the statements herein are complete and correct to the best of my knowledge.

SignatureWilson Rains.....
Title.....President..... Date2-11-87.....

Subscribed and sworn to before me this 11 day of February 1987.
Notary Public.....Juanita M. Green.....
Date Commission Expires.....10-4-87.....

JUANITA M. GREEN
NOTARY PUBLIC
STATE OF KANSAS
My Appt. Exp. Oct. 4, 1987

K.C.C. OFFICE USE ONLY
 Letter of Confidentiality Attached
 Wireline Log Received
 Drillers Timelog Received
Distribution
 KCC SWD/Rep NGPA
 KGS Plug Other
(Specify)

Sec 27, Twp. 9, Rge. 26W

SIDE TWO

Operator Name Rains & Williamson Oil Co., Inc. Lease Name L & K Simon Well # 1

27 Twp. 9S Rge. 26W County Sheridan

East
 West

WELL LOG

INSTRUCTIONS: Show important tops and base of formations penetrated. Detail all cores. Report all drill stem tests giving interval tested, time tool open and closed, flowing and shut-in pressures, whether shut-in pressure reached static level, hydrostatic pressures, bottom hole temperature, fluid recovery, and flow rates of gas to surface during test. Attach extra sheet if more space is needed. Attach copy of log.

Drill Stem Tests Taken <input type="checkbox"/> Yes <input type="checkbox"/> No	Formation Description <input checked="" type="checkbox"/> Log <input type="checkbox"/> Sample
Samples Sent to Geological Survey <input type="checkbox"/> Yes <input type="checkbox"/> No	
Cores Taken <input type="checkbox"/> Yes <input type="checkbox"/> No	

	Name	Top	Bottom
DST #1 - 3840-3890, 30 (45) 90 (45). Rec. 780' MW. FP's 83-125, 230-355. IBHP 1045, FBHP 1004.	Anhydrite	2290 (+342)	
	B/Anhydrite	2324 (+308)	
	Topeka	3630 (-998)	
	Heebner	3842 (-1210)	
	Toronto	3860 (-1228)	
	Lansing	3872 (-1240)	
	BKC	4115 (-1483)	
	LTD	4135 (-1503)	

DST #2 - 3897-3937, 30 (45) 60 (45). Rec. 690' SW. FP's 52-125, 240-313. IBHP 1170, FBHP 1129.			
DST #3 - 4005-4096, 30 (45) 30 (45). Rec. 2' mud. FP's 64-41, 64-31. IBHP 366, FBHP 177.			

CASING RECORD New Used
Report all strings set-conductor, surface, intermediate, production, etc.

Purpose of String	Size Hole Drilled	Size Casing Set (in O.D.)	Weight Lbs/Ft.	Setting Depth	Type of Cement	#Sacks Used	Type and Percent Additives
Surface	12 1/4"	8 5/8"	23#	307'	60/40 port.	190	2% gel. 3% cc.

Shots Per Foot	Specify Footage of Each Interval Perforated	Acid, Fracture, Shot, Cement Squeeze Record (Amount and Kind of Material Used)	Depth

TUBING RECORD Size Set At Packer at Liner Run Yes No

Date of First Production _____ Producing Method Flowing Pumping Gas Lift Other (explain).....

Estimated Production Per 24 Hours	Oil Bbls	Gas MCF	Water Bbls	Gas-Oil Ratio	Gravity

METHOD OF COMPLETION

Production Interval

Disposition of gas: Vented Open Hole Perforation
 Sold Other (Specify)
 Used on Lease Dually Completed
 Commingled

hg80

DRILLER'S LOG

COMPANY: Rains & Williamson Oil Co., Inc.

SEC. 27 T. 9S R. 26W

LOC. NW SE SW

WELL NAME: L & K Simon #1

COUNTY: Sheridan

RIG NO. #9

TOTAL DEPTH 4135'

ELEVATION 2627 GL 2632 KB

COMMENCED: 1-26-87

COMPLETED: 2-1-87

CONTRACTOR: Rains & Williamson Oil Co., Inc.

CASING RECORD:

SURFACE: 8 5/8" @ 307' w/190 sx. 60/40 poz., 2% gel, 3% cc.

PRODUCTION: D&A

LOG

(Figures Indicate Bottom of Formations)

Shale	313
Shale & Shells	1769
Shale	1955
Sand	2070
Redbed & Shale	2279
Shale	2333
Lime & Shale	2964
Shale & Lime	3209
Lime & Shale	3890
Lime	3930
Lime & Shale	4005
Lime	4070
Lime & Shale	4096
Lime	4135
ROTARY TOTAL DEPTH	4135

STATE OF Kansas)

COUNTY OF Sedgwick)

SS:

I, Wilson Rains, President of Rains & Williamson Oil Co., Inc.