

1-9-27W

State Geological Survey  
KANSAS DRILLERS LOG  
WICHITA, BRANCH

IMPORTANT  
Kans. Geo. Survey request  
samples on this well.

S. 1 T. 9 R. 27 X  
W  
Loc. SW SW NE  
County Sheridan

API No. 15 — 179 — 20,366  
County Number

Operator  
Chief Drilling Company, Inc.

Address 905 Century Plaza  
Wichita, Kansas

Well No. #1 Lease Name Popp

Footage Location  
feet from (N) (S) line feet from (E) (W) line

Principal Contractor Chief Drilling Co., Inc. Geologist Don D. Strong

Spud Date 9/17/73 Total Depth 4030' P.B.T.D.

Date Completed 9/22/73 Oil Purchaser

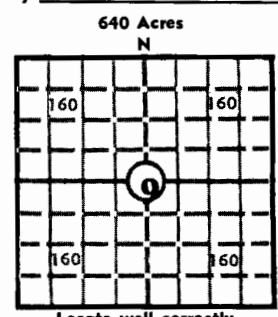

Locate well correctly  
Elev.: Gr. 2666  
DF 2668 KB 2671

CASING RECORD

Report of all strings set — surface, intermediate, production, etc.

Purpose of string	Size hole drilled	Size casing set (in O.D.)	Weight lbs/ft.	Setting depth	Type cement	Sacks	Type and percent additives
	12 1/4"	8 5/8"	28	219'	common quick set	150	

LINER RECORD

PERFORATION RECORD

Top, ft.	Bottom, ft.	Sacks cement	Shots per ft.	Size & type	Depth interval

TUBING RECORD

Size	Setting depth	Packer set at

ACID, FRACTURE, SHOT, CEMENT SQUEEZE RECORD

Amount and kind of material used	Depth interval treated

INITIAL PRODUCTION

Date of first production	Producing method (flowing, pumping, gas lift, etc.)				
RATE OF PRODUCTION PER 24 HOURS	Oil	Gas	Water	Gas-oil ratio	
	bbls.	MCF	bbls.	CFPB	
Disposition of gas (vented, used on lease or sold)			Producing interval (s)		

INSTRUCTIONS: As provided in KCC Rule 82-2-125, within 90 days after completion of a well, one completed copy of this Drillers Log shall be transmitted to the State Geological Survey of Kansas, 4150 Monroe Street, Wichita, Kansas 67209. Copies of this form are available from the Conservation Division, State Corporation Commission, 3830 So. Meridian (P.O. Box 17027), Wichita, Kansas 66217. Phone AC 316-522-2206. If confidential custody is desired, please note Rule 82-2-125. Drillers Logs will be on open file in the Oil and Gas Division, State Geological Survey of Kansas, Lawrence, Kansas 66044.

Operator Chief Drilling Co., Inc. DESIGNATE TYPE OF COMP.: OIL, GAS, DRY HOLE, SWDW, ETC.:

Well No. 1 Lease Name Popp Dry hole

S 1 T 9 R 27 WE W

**WELL LOG**  
 Show all important zones of porosity and contents thereof; cored intervals, and all drill-stem tests, including depth interval tested, cushion used, time tool open, flowing and shut-in pressures, and recoveries. SHOW GEOLOGICAL MARKERS, LOGS RUN, OR OTHER DESCRIPTIVE INFORMATION.

FORMATION DESCRIPTION, CONTENTS, ETC.	TOP	BOTTOM	NAME	DEPTH
<u>FORMATION TOPS</u>				
Anhydrite	2276	2312		
Heebner	2312			
Toronto	3782			
Top Lansing	3820			
R.T.D.	4030			
No tests; no log				

USE ADDITIONAL SHEETS, IF NECESSARY, TO COMPLETE WELL RECORD.

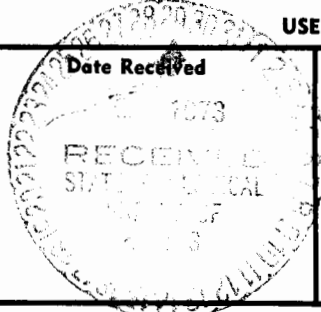

*Jim Robinson*  
 Signature  
 Vice President  
 Title  
 September 24, 1973  
 Date

010069