

STATE CORPORATION COMMISSION OF KANSAS
OIL & GAS CONSERVATION DIVISION

WELL COMPLETION OR RECOMPLETION FORM
ACO-1 WELL HISTORY

DESCRIPTION OF WELL AND LEASE

CONFIDENTIAL

Operator: License # 5140
Name Frontier Oil Company
Address 125 N. Market, Ste 1720
Wichita, Ks. 67202
City/State/Zip

Purchaser: N/A

Operator Contact Person Jean Angle
Phone 316-263-1201

Contractor: License # 5302
Name Red Tiger Drilling Company

Wellsite Geologist Richard Parker
Phone 913-483-5348

Designate Type of Completion

New Well Re-Entry Workover

Oil SWD Temp Abd
 Gas Inj Delayed Comp.
 Dry Other (Core, Water Supply etc.)

If OWWO: old well info as follows:

Operator
Well Name
Comp. Date Old Total Depth

WELL HISTORY

Drilling Method:

Mud Rotary Air Rotary Cable

6-10-85 6-18-85 6-19-85
Spud Date Date Reached TD Completion Date
4210' N/A
Total Depth PBDT

Amount of Surface Pipe Set and Cemented at 259 feet
Multiple Stage Cementing Collar Used? Yes No
If yes, show depth set.....feet
If alternate 2 completion, cement circulated
from.....feet depth to.....w/.....SX cmt

API No. 15-179-20-827..... 30-9-28W/C

County Sheridan

C-S/2 S/2 NE/4 Sec. 30 Twp. 9S Rge. 28W East West

2970' Ft North from Southeast Corner of Section
1320' Ft West from Southeast Corner of Section
(Note: Locate well in section plat below)

Lease Name Adams Well # 2

Field Name (Wildcat)

Producing Formation N/A

Elevation: Ground 2817' KB 2822'

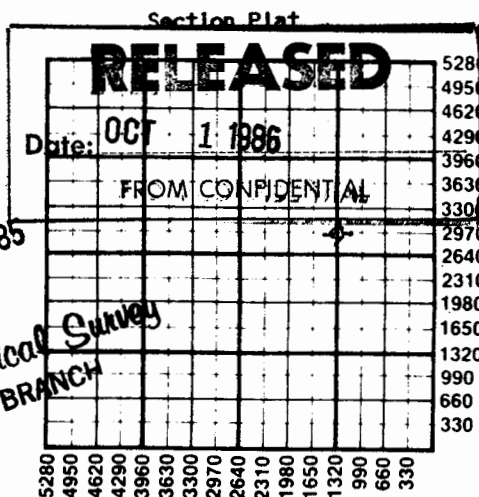

WATER SUPPLY INFORMATION
Disposition of Produced Water: N/A Disposal Repressuring
Docket #

Questions on this portion of the ACO-1 call:

Water Resources Board (913) 296-3717

Source of Water: Oliver Krannawitter, Hoxie, Ks.
Division of Water Resources Permit #

Groundwater NW/4 Ft North from Southeast Corner
(Well)Ft West from Southeast Corner of
Sec 30 Twp 9S Rge 28 East West

Surface Water.....Ft North from Southeast Corner
(Stream, pond etc).....Ft West from Southeast Corner
Sec Twp Rge East West

Other (explain).....
(purchased from city, R.W.D. #)

INSTRUCTIONS: This form shall be completed in duplicate and filed with the Kansas Corporation Commission, 200 Colorado Derby Building, Wichita, Kansas 67202, within 90 days after completion or recompletion of any well. Rule 82-3-130 and 82-3-107 apply. Information on side two of this form will be held confidential for a period of 12 months if requested in writing and submitted with the form. See rule 82-3-107 for confidentiality in excess of 12 months. One copy of all wireline logs and drillers time log shall be attached with this form. Submit CP-4 form with all plugged wells. Submit CP-111 form with all temporarily abandoned wells.

SIDE TWO

Operator Name Frontier Oil Company Lease Name Adams Well # 2

Sec 30 Twp 9S Rge 28W East West County Sheridan

Table with columns: Oil, Gas, Water, Gas-Oil Ratio, Gravity. Rows: Estimated Production Per 24 Hours, Bbls, MCF, Bbls, CFPB.

N/A

METHOD OF COMPLETION

Production Interval

N/A

Disposition of gas: Vented

Open Hole

Perforation

Drill Stem Tests Taken

Yes

No

Samples Sent to Geological Survey

Yes

No

Cores Taken

Yes

No

Formation Description

Log

Sample

DST 1 (4098-4130) 60-30-30-30 1st op wk inc to fr 2nd op fr blo. Rec 170' SW, 10'M IF 72-103 FF 82-123 ISI 1216 FSI 1186

DST 2 (4128-4150) Packer failure.

DST 3 (4098-4150) 60-30-30-30. 1st op wk bldg blo 2nd op wk bldg blo. Rec 250' WM IF 82-144 FF 165-206 ISIP 1236 FSIP 1216.

Table with columns: Name, Top, Section. Rows: Anhydrite, Howard, Topeka, Heebner, Toronto, Lansing, Base KC, RTD.

RTD 4210'

Plugged.

CONFIDENTIAL

CASING RECORD New Used

Report all strings set-conductor, surface, intermediate, production, etc.

Table with columns: Purpose of String, Size Hole, Size Casing, Weight, Setting, Type of Cement, #Sacks Used, Type and Percent Additives.

N/A

PERFORATION RECORD

Acid, Fracture, Shot, Cement Squeeze Record

Table with columns: Shots Per Foot, Specify Footage of Each Interval Perforated, (Amount and Kind of Material Used), Depth.

TUBING RECORD Size Set At Packer at Liner Run Yes No

N/A

Date of First Production Producing Method Flowing Pumping Gas Lift Other (explain)

N/A