

WICHITA BRANCH  
KANSAS DRILLERS LOG

**IMPORTANT**  
Kans. Geo. Survey request  
samples on this well.

15-179-20481

S. 21 T. 9 R. 29 <sup>X</sup>W  
Loc. C SE SE  
County Sheridan

API No. 15 — 179 — 20,481  
County Number

Operator  
Don E. Pratt

Address  
P. O. Box 370 Hays, Kansas 67601

Well No. #1-21 Lease Name Pratt "A"

Footage Location  
660' feet from (N) (S) line 660 feet from (E) (W) line

Principal Contractor Geologist  
Murfin Drilling Co., Green & Green

Spud Date Total Depth P.B.T.D.  
10-28-77 4198'

Date Completed Oil Purchaser  
11-5-77 OKC Corp.,

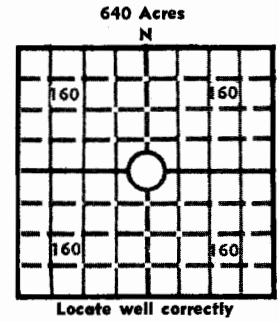

Elev.: Gr. 2818  
DF 2820 KB 2823

**CASING RECORD**

Report of all strings set — surface, intermediate, production, etc.

Purpose of string	Size hole drilled	Size casing set (in O.D.)	Weight lbs/ft.	Setting depth	Type cement	Sacks	Type and percent additives
8 5/8" surface	12 1/2" <del>8 5/8"</del>	8 5/8"	20#	252'	cqs	220	
5 1/2" oil string		5 1/2"	15#	4197'	"	200	

**LINER RECORD**

**PERFORATION RECORD**

Top, ft.	Bottom, ft.	Sacks cement	Shots per ft.	Size & type	Depth interval
			4		4099-4102

**TUBING RECORD**

Size	Setting depth	Packer set at
2 3/8		

**ACID, FRACTURE, SHOT, CEMENT SQUEEZE RECORD**

Amount and kind of material used	Depth interval treated
4,000 gals., 11-17 & 11-22	

**INITIAL PRODUCTION**

Date of first production 11-11-77	Producing method (flowing, pumping, gas lift, etc.) swab
RATE OF PRODUCTION PER 24 HOURS Oil 29 bbl. 5 hrs. bbls. Gas MCF Water bbls. Gas-oil ratio CFPB	Producing interval(s)
Disposition of gas (vented, used on lease or sold)	

INSTRUCTIONS: As provided in KCC Rule 82-2-125, within 90 days after completion of a well, one completed copy of this Drillers Log shall be transmitted to the State Geological Survey of Kansas, 4150 Monroe Street, Wichita, Kansas 67209. Copies of this form are available from the Conservation Division, State Corporation Commission, 3830 So. Meridian (P.O. Box 17027), Wichita, Kansas 66217. Phone AC 316-522-2206. If confidential custody is desired, please note Rule 82-2-125. Drillers Logs will be on open file in the Oil and Gas Division, State Geological Survey of Kansas, Lawrence, Kansas 66044.

Operator **Don E. Pratt** DESIGNATE TYPE OF COMP.: OIL, GAS, DRY HOLE, SWDW, ETC.: **Oil**

Well No. **#1** Lease Name **Pratt A.,**

S 21 T 9 R29 <sup>EX</sup> W

**WELL LOG**

Show all important zones of porosity and contents thereof; cored intervals, and all drill-stem tests, including depth interval tested, cushion used, time tool open, flowing and shut-in pressures, and recoveries.

SHOW GEOLOGICAL MARKERS, LOGS RUN, OR OTHER DESCRIPTIVE INFORMATION.

FORMATION DESCRIPTION, CONTENTS, ETC.	TOP	BOTTOM	NAME	DEPTH
Copy 66 geological report attached.,				

USE ADDITIONAL SHEETS, IF NECESSARY, TO COMPLETE WELL RECORD.

Date Received \_\_\_\_\_  
Signature *Susie Ubert* **S. Ubert, Office Mgr.,**  
Title \_\_\_\_\_  
Date 12-14-77  
Date \_\_\_\_\_

HOH67