



SIDE ONE

*Ind*

STATE CORPORATION COMMISSION OF KANSAS  
OIL & GAS CONSERVATION DIVISION

WELL COMPLETION OR RECOMPLETION FORM  
ACO-1 WELL HISTORY

DESCRIPTION OF WELL AND LEASE

Operator: License # 5205  
Name Mid Continent Energy Corp.  
Address 120 S. Market, Suite 712  
Wichita, KS 67202  
City/State/Zip .....

Purchaser.....

Operator Contact Person Brad Buehler  
Phone 316-265-9501

Contractor: License # 5418  
Name Allendrilling Company

Wellsite Geologist Martin Dubois  
Phone.....

Designate Type of Completion  
 New Well  Re-Entry  Workover  
 Oil  SWD  Temp Abd  
 Gas  Inj  Delayed Comp.  
 Dry  Other (Core, Water Supply etc.)

If OWO: old well info as follows:  
Operator .....  
Well Name .....  
Comp. Date ..... Old Total Depth.....

WELL HISTORY

Drilling Method:  
 Mud Rotary  Air Rotary  Cable  
5-20-85 5-28-85 5-29-85  
Spud Date Date Reached TD Completion Date  
4740' .....  
Total Depth PBTD

Amount of Surface Pipe Set and Cemented at 307 feet  
Multiple Stage Cementing Collar Used?  Yes  No  
If yes, show depth set.....feet  
If alternate 2 completion, cement circulated  
from.....feet depth to.....w/.....SX cmt

API NO. 15- 913-20,352 25-9-33W  
County Thomas  
C NE NW 1/4 Sec 25 Twp 9 Rge 33  East  West

4620 Ft North from Southeast Corner of Section  
3300 Ft West from Southeast Corner of Section  
(Note: Locate well in section plat below)

Lease Name Thorpe Well # 1

Field Name Wildcat

Producing Formation.....

Elevation: Ground 3135 3142 KB.....

Section Plat

JUN 2 5 1985  
State Geological Survey  
WICHITA BRANCH  
STATE CORPORATION COMMISSION  
Wichita, Kansas

JUN 2 4 1985  
CONSERVATION DIVISION  
Wichita, Kansas

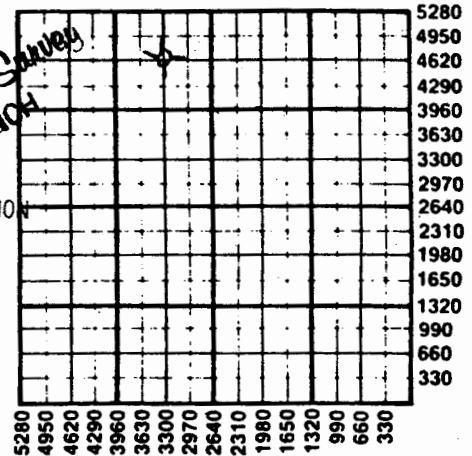

WATER SUPPLY INFORMATION  
Disposition of Produced Water:  Disposal  Repressuring  
Docket # .....

Questions on this portion of the ACO-1 call:  
Water Resources Board (913) 296-3717  
Source of Water:  
Division of Water Resources Permit #.....  
 Groundwater.....Ft North from Southeast Corner  
(Well) .....Ft West from Southeast Corner of  
Sec Twp Rge  East  West  
 Surface Water.....Ft North from Southeast Corner  
(Stream, pond etc).....Ft West from Southeast Corner  
Sec Twp Rge  East  West  
 Other (explain) Bill Ferricks, Colby, KS  
(purchased from city, R.W.D. #)

INSTRUCTIONS: This form shall be completed in duplicate and filed with the Kansas Corporation Commission, 200 Colorado Derby Building, Wichita, Kansas 67202, within 90 days after completion or recompletion of any well. Rule 82-3-130 and 82-3-107 apply.  
Information on side two of this form will be held confidential for a period of 12 months if requested in writing and submitted with the form. See rule 82-3-107 for confidentiality in excess of 12 months.  
One copy of all wireline logs and drillers time log shall be attached with this form. Submit CP-4 form with all plugged wells. Submit CP-111 form with all temporarily abandoned wells.

SIDE TWO

Operator Name: Mid Continent Energy Corp. Lease Name: Thorne Well #: 1

Sec: 25 Twp: 9 Rge: 33 East West County: Thomas

WELL LOG

INSTRUCTIONS: Show important tops and base of formations penetrated. Detail all cores. Report all drill stem tests giving interval tested, time tool open and closed, flowing and shut-in pressures, whether shut-in pressure reached static level, hydrostatic pressures, bottom hole temperature, fluid recovery, and flow rates if gas to surface during test. Attach extra sheet if more space is needed. Attach copy of log.

Drill Stem Tests Taken [X] Yes [ ] No
Samples Sent to Geological Survey [ ] Yes [ ] No
Cores Taken [ ] Yes [ ] No

Formation Description
[ ] Log [ ] Sample

DST #1: 4267'-4300' (Lans. 140' & 160' zones)
Wk. blow through 1st open; wk. blow died 12" into 2nd open. 30"-30"-30"-30"; Rec. 10' oil spkd. mud; FP=20# all, ISIP=30#, FSIP=30#, HP=2211-2201#, BHT=121°.

DST #2: 4292'-4345' (Lans. 180' & 200' zones); 30"-30"-60"-60". Wk. blow inc. to 4 1/2" on 1st open, wk. blow inc. to 2 1/2" on 2nd open. Rec. 20' OCWM (15% oil, 30% wtr., 55% mud) & 85' wtry. mud w/oil specks. Chlorides=20,000. FP=20-30, 30-40 SIP=1223-1223, HP=2201-2102, BHT=124°.

DST #3: 4510-4568' (Marmaton "D" & "E" zones); 30"-30"-30"-30"; 1st open, wk. blow died in 25"; no blow on 2nd open. Rec. 30' mud w/scum oil. IFP=40-40, FFP=40-40, ISIP=946-777, HP=2409-2217 BHT=126°.

DST #4: see attached page

Table with 3 columns: Name, Top, Bottom. Lists geological formations such as Anhydrite, B/Anhydrite, Topeka, Heebner, Toronto, Lansing, Stark, B/K.C., Pawnee, Up. Ck. Sh., John. Zone, Cher. Sd., Miss. LS., Miss. Dol., L.T.D. with their respective top and bottom elevations.

CASING RECORD, PERFORATION RECORD, TUBING RECORD, and production details section. Includes fields for Purpose of String, Size Hole, Size Casing, Weight, Setting Depth, Type of Cement, #Sacks Used, Type and Percent Additives, Shots Per Foot, Acid, Fracture, Shot, Cement Squeeze Record, Date of First Production, and Producing Method.

25-9-33W

Computer inventoried

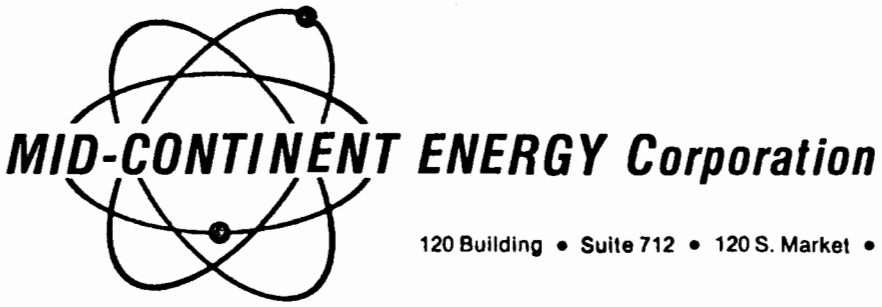

120 Building • Suite 712 • 120 S. Market • Wichita, Kansas 67202 • (316) 265-9501

AP2 #15-913-20352 Thorpe #1

DRILL STEM TESTS - continued from ACO-1

DST #4: 4612-4654' (Johnson Zone); 30"-30"-30"-30"; 1st open wk. blow died in 15"; no blow on 2nd open. Rec. 5' mud, FP=44-44, 44-44, SIP=55-55, HP=2522-2500, BHT=125°.

STRADDLE TEST: 3772'-3803'. Fair blow inc. to 5" on 1st open. Fair blow 3" bucket on 2nd, 30"-30"-30"-30"; IFP=33-55, FFP=55-77, SIP=1063-1041, HP=2000-1944, BHT=119°. Rec. 120' mdy. s/w.

25-9-33W  
C NE NW

JUN 2 5 1965  
State Geological Survey  
WICHITA BRANCH

RECEIVED  
STATE CORPORATION COMMISSION

JUN 2 4 1965  
CONSERVATION DIVISION  
Wichita, Kansas