

FIRST
CORRECTED

RECEIVED

For KCC Use:
Effective Date: 1-21-04
District # 1
SGA? Yes No

KANSAS CORPORATION COMMISSION
OIL & GAS CONSERVATION DIVISION

JAN 14 2004

Form C-1
September 1999

Form must be Typed
Form must be Signed
Blanks must be Filled

NOTICE OF INTENT TO DRILL

Must be approved by KCC five (5) days prior to commencing well

KCC WICHITA

Expected Spud Date February 9 2004
month day year

OPERATOR: License# 32451
Name: CLX ENERGY, INC.
Address: 518-17th Street, Suite 745
City/State/Zip: Denver, CO 80202
Contact Person: E. J. Henderson
Phone: 303/825-7080

CONTRACTOR: License# 5929
Name: Duke Drilling Co., Inc.

A.P. NESEWN
Spot G-N/2-NE/4 Sec. 13 Twp. 30 R. 11
660 feet from S / N (circle one) Line of Section
1445 feet from E / W (circle one) Line of Section
Is SECTION Regular Irregular?

(Note: Locate well on the Section Plat on reverse side)

County: Barber
Lease Name: Rolf Land, L.P. Well #: 1
Field Name: Exploratory Well Rhodes

Is this a Prorated / Spaced Field? Yes No

Target Formation(s): Douglas Sand

Nearest Lease or unit boundary: 660 916
Ground Surface Elevation: 1,810 1796 feet MSL

Water well within one-quarter mile: Yes No
Public water supply well within one mile: Yes No

Depth to bottom of fresh water: Unknown 160
Depth to bottom of usable water: Unknown 200

Surface Pipe by Alternate: 1 2
Length of Surface Pipe Planned to be set: 350'

Length of Conductor Pipe required: None

Projected Total Depth: 3,900'

Formation at Total Depth: Lansing

Water Source for Drilling Operations:
Well 1 Farm Pond Other

DWR Permit #: _____

(Note: Apply for Permit with DWR)

Will Cores be taken? Yes No

If Yes, proposed zone: _____

IS: 916' FNLL, ELEV = 1796'

Well Drilled For: Oil Enh Rec Infield Mud Rotary
 Gas Storage Pool Ext. Air Rotary
 OWWO Disposal Wildcat Cable
 Seismic; # of Holes Other Other

If OWWO: old well information as follows:

Operator: _____
Well Name: _____
Original Completion Date: _____ Original Total Depth: _____

Directional, Deviated or Horizontal wellbore? Yes No

If Yes, true vertical depth: _____

Bottom Hole Location: _____

KCC DKT #: _____

LOCATION WAS: 660' FNL, 1320' FEL, N/2 NE
LOCATION IS: 916' FNL, 1445' FEL, NESEWN

AFFIDAVIT

The undersigned hereby affirms that the drilling, completion and eventual plugging of this well will comply with K.S.A. 55-101, et. seq.

It is agreed that the following minimum requirements will be met:

MOVED LOC. DUE TO SURFACE OBSTRUCTION

1. Notify the appropriate district office *prior* to spudding of well;
2. A copy of the approved notice of intent to drill *shall be* posted on each drilling rig;
3. The minimum amount of surface pipe as specified below *shall be set* by circulating cement to the top; in all cases surface pipe *shall be set* through all unconsolidated materials plus a minimum of 20 feet into the underlying formation.
4. If the well is dry hole, an agreement between the operator and the district office on plug length and placement is *necessary prior to plugging*;
5. The appropriate district office will be notified before well is either plugged or production casing is cemented in;
6. If an ALTERNATE II COMPLETION, production pipe shall be cemented from below any usable water to surface within *120 days* of spud date. *In all cases, NOTIFY district office* prior to any cementing.

I hereby certify that the statements made herein are true and to the best of my knowledge and belief.

Date: 1/08/04 Signature of Operator or Agent: E. J. Henderson Title: President

For KCC Use ONLY
API # 15 - 007-22797-0000
Conductor pipe required NONE feet
Minimum surface pipe required 220 feet per Alt. (1)
Approved by: RSP1-16-04 IRSP+2804
This authorization expires: 7-16-04
(This authorization void if drilling not started within 6 months of effective date.)
Spud date: _____ Agent: _____

Remember to:

- File Drill Pit Application (form CDP-1) with Intent to Drill;
- File Completion Form ACO-1 within 120 days of spud date;
- File acreage attribution plat according to field proration orders;
- Notify appropriate district office 48 hours prior to workover or re-entry;
- Submit plugging report (CP-4) after plugging is completed;
- Obtain written approval before disposing or injecting salt water.

13 30 11/2

IN ALL CASES PLOT THE INTENDED WELL ON THE PLAT BELOW

Plat of acreage attributable to a well in a prorated or spaced field

If the intended well is in a prorated or spaced field, please fully complete this side of the form. If the intended well is in a prorated or spaced field complete the plat below showing that the well will be properly located in relationship to other wells producing from the common source of supply. Please show all the wells and within 1 mile of the boundaries of the proposed acreage attribution unit for gas wells and within 1/2 mile of the boundaries of the proposed acreage attribution unit for oil wells.

API No. 15 - _____
Operator: CLX ENERGY, INC.
Lease: Rolf Land, L.P.
Well Number: 1
Field: Exploratory

Number of Acres attributable to well: 40
QTR / QTR / QTR of acreage: C - N/2 - NE/4

Location of Well: County: Barber
660 feet from S (N) (circle one) Line of Section
1,320 feet from (E) / W (circle one) Line of Section
Sec. 13 Twp. 30 S. R. 11 East West

Is Section XX Regular or _____ Irregular

If Section is Irregular, locate well from nearest corner boundary.
Section corner used: ___NE ___NW ___SE ___SW

PLAT

*(Show location of the well and shade attributable acreage for prorated or spaced wells.)
(Show footage to the nearest lease or unit boundary line.)*

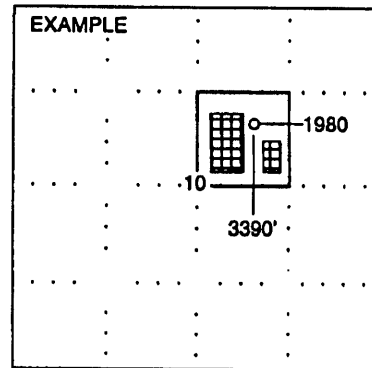
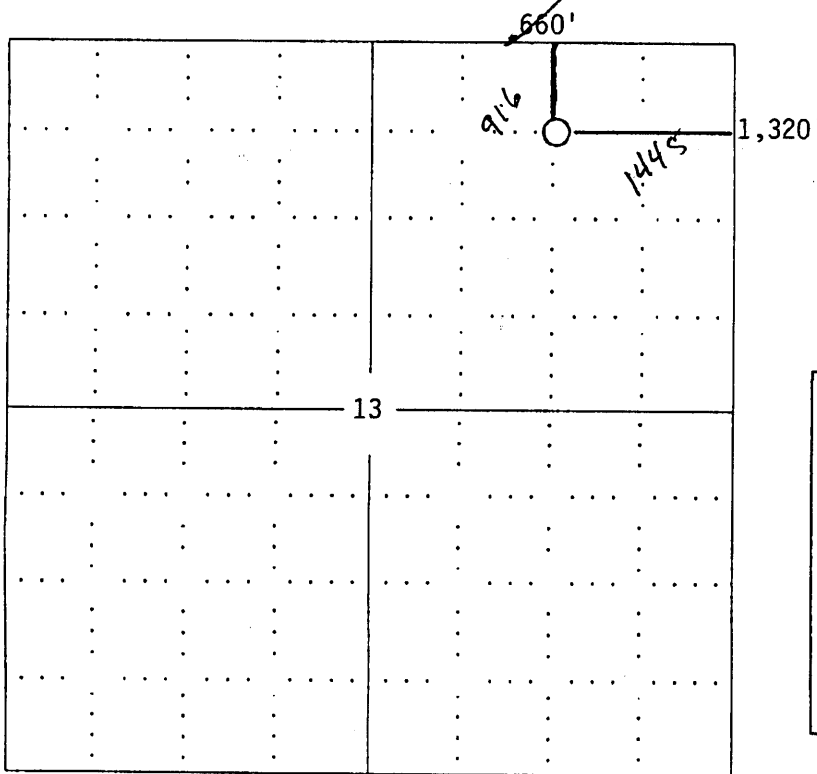

SEWARD CO.

NOTE: In all cases locate the spot of the proposed drilling locaton.

In plotting the proposed location of the well, you must show:

1. The manner in which you are using the depicted plat by identifying section lines, i.e. 1 section, 1 section with 8 surrounding sections, 4 sections, etc.
2. The distance of the proposed drilling location from the section's south / north and east / west.
3. The distance to the nearest lease or unit boundary line.
4. If proposed location is located within a prorated or spaced field a certificate of acreage attribution plat must be attached: (C0-7 for oil wells; CG-8 for gas wells).