

For KCC Use:
 Effective Date: 8-21-03
 District #: 3
 SCA? Yes No

KANSAS CORPORATION COMMISSION
 OIL & GAS CONSERVATION DIVISION

**FIRST
 CORRECTED**

Form C-1
 September 1999
 Form must be Typed
 Form must be Signed
 All blanks must be Filled

NOTICE OF INTENT TO DRILL

Must be approved by KCC five (5) days prior to commencing well

Expected Spud Date: August 20, 2003
 month day year

Spot: NE/4 SW/4 NE/4 Sec. 10 Twp. 35 S. R. 21 East West

OPERATOR: License# 33264
 Name: Central Production Co. Inc.
 Address: 718 Oak St.
 City/State/Zip: Humboldt, KS 66748
 Contact Person: John Sperry
 Phone: 417-667-5062/417-684-4294

3658 feet from () N (circle one) Line of Section
1393 feet from () W (circle one) Line of Section
 is SECTION Regular Irregular?

(Note: Locate well on the Section Plot on reverse side)

CONTRACTOR: License# 33274
 Name: David Casey

County: Labette
 Lease Name: Barr Well #: B19

Field Name: Chetopa

Is this a Propped / Spaced Fluid? Yes No

Target Formation(s): Bartlesville

Nearest Lease or unit boundary: 1247'

Ground Surface Elevation: 834.56 feet MSL

Water well within one-quarter mile: Yes No

Public water supply well within one mile: Yes No

Depth to bottom of fresh water: 200 ft

Depth to bottom of usable water: 300 ft

Surface Pipe by Alternative: 1-2

Length of Surface Pipe Planned to be set: 20 ft

Length of Conductor Pipe required: 20 ft

Projected Total Depth: 150'

Formation at Total Depth: Bartlesville

Water Source for Drilling Operations:

Well Farm Pond Other: none - air rotary

DWR Permit #: _____

(Notes: Apply for Permit with DWR)

Will Cores be taken? Yes No

If Yes, proposed zone: _____

Well Drilled For:	Well Class:	Type Equipment:
<input checked="" type="checkbox"/> Oil	<input checked="" type="checkbox"/> Infield	<input type="checkbox"/> Mud Rotary
<input type="checkbox"/> Gas	<input type="checkbox"/> Pool Ext.	<input checked="" type="checkbox"/> Air Rotary
<input type="checkbox"/> GWC	<input type="checkbox"/> Wildcat	<input type="checkbox"/> Cable
<input type="checkbox"/> Seismic: # of Holes _____	<input type="checkbox"/> Other _____	
<input type="checkbox"/> Other _____		

If GWC: old well information as follows:
 Operator: _____
 Well Name: _____
 Original Completion Date: _____ Original Total Depth: _____

Directional, Deviated or Horizontal wellbore? Yes No

If Yes, true vertical depth: _____

Bottom Hole Location: _____

KCC DKT #: _____

*WAS: EOR ES: OIL

AFFIDAVIT

**RECEIVED
 KANSAS CORPORATION COMMISSION**

The undersigned hereby affirms that the drilling, completion and eventual plugging of this well will comply with K.C.A. 17-1-101. I agree that the following minimum requirements will be met:

1. Notify the appropriate district office *prior* to spudding of well;
2. A copy of the approved notice of intent to drill *shall be posted* on each drilling rig;
3. The minimum amount of surface pipe as specified below *shall be set* by circulating cement to the top in all cases through all unconsolidated materials plus a minimum of 20 feet into the underlying formation.
4. If the well is dry hole, an agreement between the operator and the district office on plug length and placement is necessary *prior to plugging*;
5. The appropriate district office will be notified before well is either plugged or production casing is cemented in.
6. If an ALTERNATE to COMPLETION, production pipe shall be cemented from below any usable water to surface within 120 days of spud date. *In all cases, NOTIFY district office prior to any cementing.*

1-25-04 AUG 18 2003
 CONSERVATION DIVISION
 WICHITA, KS

I hereby certify that the statements made herein are true and to the best of my knowledge and belief.

Date: 8/13/03 Signature of Operator or Agent: John Sperry the Vice-president--Engr

For KCC Use ONLY
 API # 15 - 099-2331900-00
 Conductor pipe required: NONE feet
 Minimum surface pipe required: 20' feet per Alt.
 Approved by: JPW 8-26-03 L RSP 1-80-04
 This authorization expires: 2-26-04/8-26-04
 (This authorization void if drilling not started within 6 months of effective date.)
 Spud date: _____ Agent: _____

Remember to:

- File Drill Pit Application (form CDP-1) with Intent to Drill;
- File Completion Form ACC-1 within 120 days of spud date;
- File acreage attribution plot according to field operation orders;
- Notify appropriate district office 48 hours prior to workover or re-entry;
- Submit plugging report (CP-4) after plugging is completed.
- Obtain written approval before disposing or injecting salt water.

10
 35
 21E

IN ALL CASES PLOT THE INTENDED WELL ON THE PLAT BELOW

Plat of acreage attributable to a well in a prorated or spaced field

if the intended well is in a prorated or spaced field, please fully complete this side of the form. If the intended well is in a prorated or spaced field complete the plat below showing that the well will be properly located in relationship to other wells producing from the common source of supply. Please show all the wells and within 1 mile of the boundaries of the proposed acreage attribution unit for gas wells and within 1/2 mile of the boundaries of the proposed acreage attribution unit for oil wells.

API No. 15 - _____
 Operator: Central Production Co. Inc.
 Lease: Barr
 Well Number: B19
 Field: Chetopa
 Number of Acres attributable to well: 0.50
 QTR / QTR / QTR of acreage: NE/4 - SW/4 - NE/4

Location of Well: County: Labette
3658 feet from N / S (circle one) Line of Section
1393 feet from E / W (circle one) Line of Section
 Sec. 10 Twp. 35 S. R. 21 East West

Is Section X Regular or _____ Irregular

If Section is Irregular, locate well from nearest corner boundary.
 Section corner used: ___NE ___NW ___SE ___SW

PLAT

*(Show location of the well and shade attributable acreage for prorated or spaced wells.)
 (Show footage to the nearest lease or unit boundary line.)*

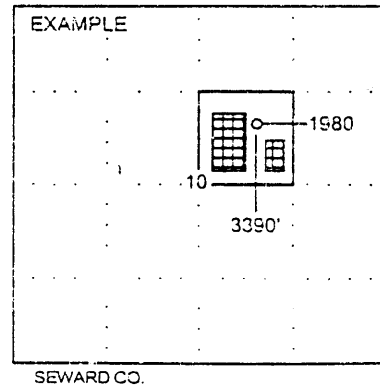
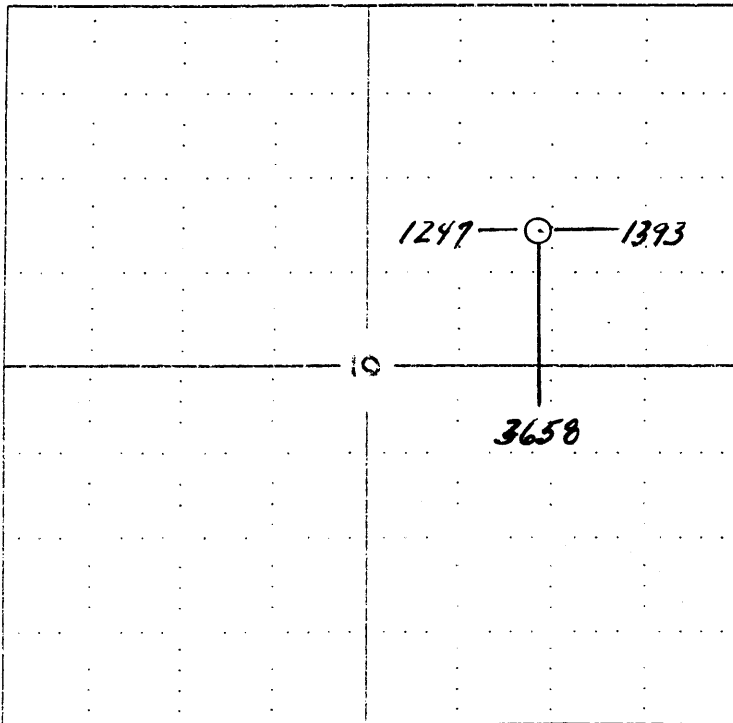

NOTE: In all cases locate the spot of the proposed drilling location.

In plotting the proposed location of the well, you must show:

1. The manner in which you are using the depicted plat by identifying section lines, i.e. 1 section, 1 section with 8 surrounding sections, 4 sections, etc.
2. The distance of the proposed drilling location from the section's south / north and east / west.
3. The distance to the nearest lease or unit boundary line.
4. If proposed location is located within a prorated or spaced field a certificate of acreage attribution plat must be attached: (CO-7 for oil wells; CO-8 for gas wells).