

For KCC Use:
 Effective Date: 8-31-03
 District #: 3
 SGA? Yes No

KANSAS CORPORATION COMMISSION
 OIL & GAS CONSERVATION DIVISION

FIRST
CORRECTED

Form C-1
 September 1999

Form must be Typed

Form must be Signed

All blanks must be Filled

NOTICE OF INTENT TO DRILL

Must be approved by KCC five (5) days prior to commencing well

Expected Spud Date: August 20, 2003
 month day year

Sec: Ap Ne NW/4 SW/4NE/4 Sec. 10 Twp. 35 S. R. 21
37.95 feet from (S) / N (circle one) Line of Section
21.06 feet from (E) / W (circle one) Line of Section
 Is SECTION: Regular Irregular?

OPERATOR: License# 33264
 Name: Central Production Co., Inc.
 Address: 718 Oak St.
 City/State/Zip: Humboldt, KS 66748
 Contact Person: John Sperry
 Phone: 417-667-5062/417-664-4294

(Note: Locate well on the Section Plat on reverse side)
 County: Labette
 Lease Name: Barr Well #: B20
 Field Name: Chetopa

CONTRACTOR: License# 33274
 Name: David Casey

Is this a Fractured / Spaced Well? Yes No

Well Drilled For:	Well Class:	Type Equipment:
<input checked="" type="checkbox"/> Oil	<input checked="" type="checkbox"/> Infield	<input type="checkbox"/> Mud Rotary
<input type="checkbox"/> Gas	<input type="checkbox"/> Pool Ext.	<input checked="" type="checkbox"/> Air Rotary
<input type="checkbox"/> GMAO	<input type="checkbox"/> Wellcat	<input type="checkbox"/> Cable
<input type="checkbox"/> Seismic: _____ of Holes	<input type="checkbox"/> Other	
<input type="checkbox"/> Other		

Nearest Lease or Unit Boundary: 534'
 Ground Surface Elevation: 828.83 feet MSL

Water well within one-quarter mile: Yes No
 Public water supply well within one mile: Yes No

Depth to bottom of fresh water: 200 ft+
 Depth to bottom of usable water: 300 ft+

Surface Pipe by Alternate: 20 ft
 Length of Surface Pipe Planned to be set: 20 ft

Length of Conductor Pipe required: 20 ft
 Projected Total Depth: 150'
 Formation at Total Depth: Bartlesville

If O/W/C: old well information as follows:
 Operator: _____
 Well Name: _____
 Original Completion Date: _____ Original Total Depth: _____

Water Source for Drilling Operations:
 Well _____ Farm Pond _____ Other none - air rotary

Directional / Deviated or Horizontal wellbore? Yes No

DWR Permit #: _____
 (Note: Apply for Permit with DWR)
 Will Corps be taken? Yes No

If Yes, true vertical depth: _____

Bottom Hole Location: _____

KCC DKT #: _____

If Yes, proposed zone: _____

* WAS: EOR IS OIL

AFFIDAVIT

RECEIVED

The undersigned hereby affirms that the drilling, completion and eventual plugging of this well will comply with K.S.A. 55-**KANSAS CORPORATION COMMISSION**
 it is agreed that the following minimum requirements will be met:

1. Notify the appropriate district office *prior* to spudding of well;
2. A copy of the approved notice of intent to drill *shall be* posted on each drilling rig;
3. The minimum amount of surface pipe as specified below *shall be set* by circulating cement to the top in all cases surface pipe shall be set through all unconsolidated materials plus a minimum of 20 feet into the underlying formation.
4. If the well is dry hole, an agreement between the operator and the district office on plug length and placement is necessary *prior to plugging*;
5. The appropriate district office will be notified before well is either plugged or production casing is cemented in;
6. If an ALTERNATE to COMPLETION production pipe shall be cemented from below any usable water to surface within 120 days of spud date. *In all cases, NOTIFY district office prior to any cementing.*

Permit Extension - Request Received 1-25-03 AUG 18 2003

CONSERVATION DIVISION
 WICHITA, KS

I hereby certify that the statements made herein are true and to the best of my knowledge and belief

John Sperry

Date: 8/13/03 Signature of Operator or Agent: _____ Title: Vice-president--Engr

For KCC Use ONLY
 API # 15 - 099-23320-00-00
 Conductor pipe required, NONE feet
 Minimum surface pipe required 20' feet per Alt.
 Approved by: DPW 8-26-03 / RJP 2-2-04
 This authorization expires: 2-26-04 / 8-26-04
 (This authorization void if drilling not started within 6 months of effective date.)
 Spud date: _____ Agent: _____

- Remember to:
- File Drill Pit Application (form GDP-1) with Intent to Drill;
 - File Completion Form ACC-1 within 120 days of spud date;
 - File acreage distribution plat according to field proration orders;
 - Notify appropriate district office 48 hours prior to workover or re-entry;
 - Submit plugging report (CP-4) after plugging is completed;
 - Obtain written approval before disposing or injecting salt water.

10
 35
 216

IN ALL CASES PLOT THE INTENDED WELL ON THE PLAT BELOW

Plat of acreage attributable to a well in a prorated or spaced field

If the intended well is in a prorated or spaced field, please fully complete this side of the form. If the intended well is in a prorated or spaced field complete the plat below showing that the well will be properly located in relationship to other wells producing from the common source of supply. Please show all the wells and within 1 mile of the boundaries of the proposed acreage attribution unit for gas wells and within 1/2 mile of the boundaries of the proposed acreage attribution unit for oil wells.

API No. 15 - _____
 Operator: Central Production Co., Inc.
 Lease: Barr
 Well Number: B20
 Field: Chetopa
 Number of Acres attributable to well: 0.50
 QTR / QFR / QTR of acreage: NW/4 - SW/4 - NE/4

Location of Well: County: Labette
3795 feet from N / N (circle one) Line of Section
2106 feet from E / W (circle one) Line of Section
 Sec. 10 Twp. 35 S. R. 21 East West

is Section X Regular or _____ Irregular

If Section is Irregular, locate well from nearest corner boundary.
 Section corner used: ___NE ___NW ___SE ___SW

PLAT

(Show location of the well and shade attributable acreage for prorated or spaced wells.)
 (Show footage to the nearest lease or unit boundary line.)

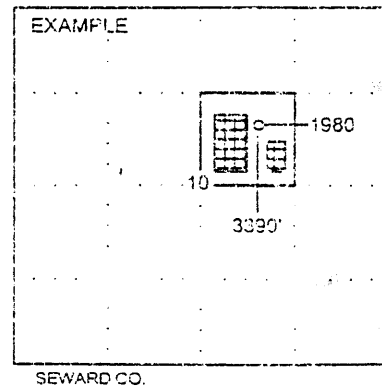
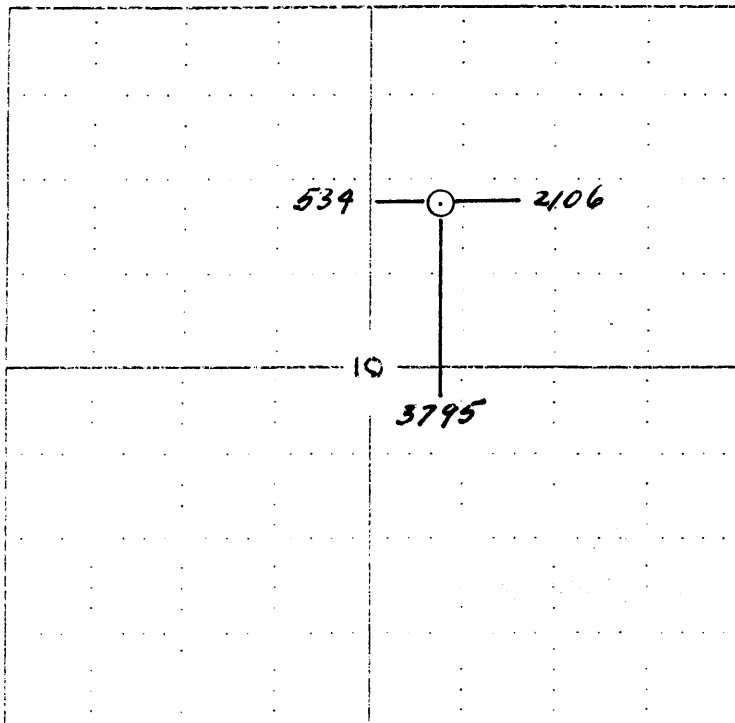

NOTE: In all cases locate the spot of the proposed drilling location.

In plotting the proposed location of the well, you must show:

1. The manner in which you are using the depicted plat by identifying section lines, i.e. 1 section, 1 section with 8 surrounding sections, 4 sections, etc.
2. The distance of the proposed drilling location from the section's south / north and east / west.
3. The distance to the nearest lease or unit boundary line.
4. If proposed location is located within a prorated or spaced field a certificate of acreage attribution plat must be attached: (CO-7 for oil wells; CO-8 for gas wells).