

**CORRECTED**

For KCC Use:  
Effective Date: 8-31-03  
Normative: 3  
SGA?  Yes  No

KANSAS CORPORATION COMMISSION  
OIL & GAS CONSERVATION DIVISION

Permit Extension -  
Request Received 1-25-04 Form C-1  
September 1998  
Form must be Typed  
Form must be Signed  
All blanks must be Filled

**NOTICE OF INTENT TO DRILL**

Must be approved by KCC five (5) days prior to commencing well

Expected Spud Date August 20, 2003  
month day year

OPERATOR: License# 33264  
Name: Central Production Co., Inc.  
Address: 718 Oak St.  
City/State/Zip: Humboldt, KS 66748  
Contact Person: John Sperry  
Phone: 417-667-5062/417-684-4294

CONTRACTOR: License# 33274  
Name: David Casey

Spot  East  West  
AP W/2 NW/4 SW/4 NE/4 Sec. 10 Twp. 35 S. R. 21  
3658 feet from 3/4 N (circle one) Line of Section  
2344 feet from 3/4 W (circle one) Line of Section  
Is SECTION  Regular  Irregular?

(Note: Locate well on the Section Plat on reverse side)

County: Labette  
Lease Name: Barr Well # B46  
Field Name: Chetopa

Is this a Prorated / Spaced Field?  Yes  No  
Target Formation(s): Bartlesville

Nearest Lease or unit boundary: 296'  
Ground Surface Elevation: 834.60 feet M.C.L.

Water well within one-quarter mile:  Yes  No  
Public water supply well within one mile:  Yes  No

Depth to bottom of fresh water: 200 ft+  
Depth to bottom of usable water: 300 ft+

Surface Pipe by Alternate: 1 X 2  
Length of Surface Pipe Planned to be set: 20 ft

Length of Conductor Pipe required: 20 ft  
Projected Total Depth: 150'

Formation at Total Depth: Bartlesville  
Water Source for Drilling Operations:  
Well  Farm Pond  Other ROGS - Air Rotary

DWR Permit #: \_\_\_\_\_  
(Note: Apply for Permit with DWR )

Will Cores be taken?  Yes  No  
If Yes, proposed zone: \_\_\_\_\_

Well Drilled For:  Oil  Gas  GWC  Seismic: \_\_\_\_\_ # of Holes  Other \_\_\_\_\_  
Well Class:  Infield  Pool Ext.  Wildcat  Other \_\_\_\_\_  
Type Equipment:  Mud Rotary  Air Rotary  Cable

If DWAOC: old well information as follows:  
Operator: \_\_\_\_\_  
Well Name: \_\_\_\_\_  
Original Completion Date: \_\_\_\_\_ Original Total Depth: \_\_\_\_\_

Directional/ Deviated or Horizontal wellbore?  Yes  No  
If Yes, true vertical depth: \_\_\_\_\_  
Bottom Hole Location: \_\_\_\_\_  
KCC DKT #: \_\_\_\_\_

\* WAS = EOR IS = OIL

**AFFIDAVIT**

The undersigned hereby affirms that the drilling, completion and eventual plugging of this well will comply with K.S.A. 35-101 et. seq.  
It is agreed that the following minimum requirements will be met:

1. Notify the appropriate district office *prior* to spudding of well;
2. A copy of the approved notice of intent to drill *shall be posted* on each drilling rig;
3. The minimum amount of surface pipe as specified below *shall be set* by circulating cement to the top, in all cases surface pipe shall be set through all unconsolidated materials plus a minimum of 20 feet into the underlying formation;
4. If the well is dry hole, an agreement between the operator and the district office on plug length and placement is necessary *prior to plugging*;
5. The appropriate district office will be notified before well is either plugged or production casing is cemented in;
6. If an ALTERNATE II COMPLETION, production pipe shall be cemented from below any usable water to surface within 120 days of spud date. *In all cases, NOTIFY district office* prior to any cementing.

I hereby certify that the statements made herein are true and to the best of my knowledge and belief.

Date: 8/13/03 Signature of Operator or Agent: John Sperry Title: Vice-president - Eng

RECEIVED  
KANSAS CORPORATION COMMISSION  
AUG 18 2003

CONSERVATION DIVISION

For KCC Use ONLY  
API # 15 - 099-23306-0000  
Conductor pipe required: NONE feet  
Minimum surface pipe required: 20' feet per Alt.   
Approved by: DPW 8-26-03 RJP 2-2-04  
This authorization expires: 2-26-04 8-26-04  
(This authorization void if drilling not started within 6 months of effective date.)  
Spud date: \_\_\_\_\_ Agent: \_\_\_\_\_

Remember to:

- File Drill Pit Application (form CDP-1) with Intent to Drill;
- File Completion Form ACC-1 within 120 days of spud date;
- File acreage attribution plat according to field prorations orders;
- Notify appropriate district office 48 hours prior to workover or re-entry;
- Submit plugging report (GP-4) after plugging is completed;
- Obtain written approval before disposing or injecting salt water.

10  
35  
216

**IN ALL CASES PLOT THE INTENDED WELL ON THE PLAT BELOW**

*Plat of acreage attributable to a well in a prorated or spaced field*

If the intended well is in a prorated or spaced field, please fully complete this side of the form. If the intended well is in a prorated or spaced field complete the plat below showing that the well will be properly located in relationship to other wells producing from the common source of supply. Please show all the wells and within 1 mile of the boundaries of the proposed acreage attribution unit for gas wells and within 1/2 mile of the boundaries of the proposed acreage attribution unit for oil wells.

API No. 15 - \_\_\_\_\_  
 Operator: Central Production Co., Inc.  
 Lease: Barr  
 Well Number: B46  
 Field: Chetopa  
 Number of Acres attributable to well: 0.50  
 QTR / QTR / QTR of acreage: NW/4 - SW/4 - NE/4

Location of Well: County: Labette  
3658 feet from  / N (circle one) Line of Section  
2344 feet from  / W (circle one) Line of Section  
 Sec. 10 Twp. 35 S. R. 21  East  West

Is Section X Regular or \_\_\_\_\_ Irregular

If Section is Irregular, locate well from nearest corner boundary.  
 Section corner used: \_\_\_NE \_\_\_NW \_\_\_SE \_\_\_SW

**PLAT**

(Show location of the well and shade attributable acreage for prorated or spaced wells.)  
 (Show footage to the nearest lease or unit boundary line.)

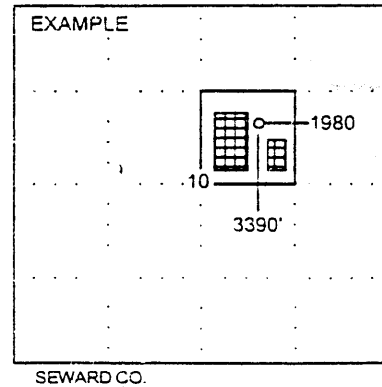
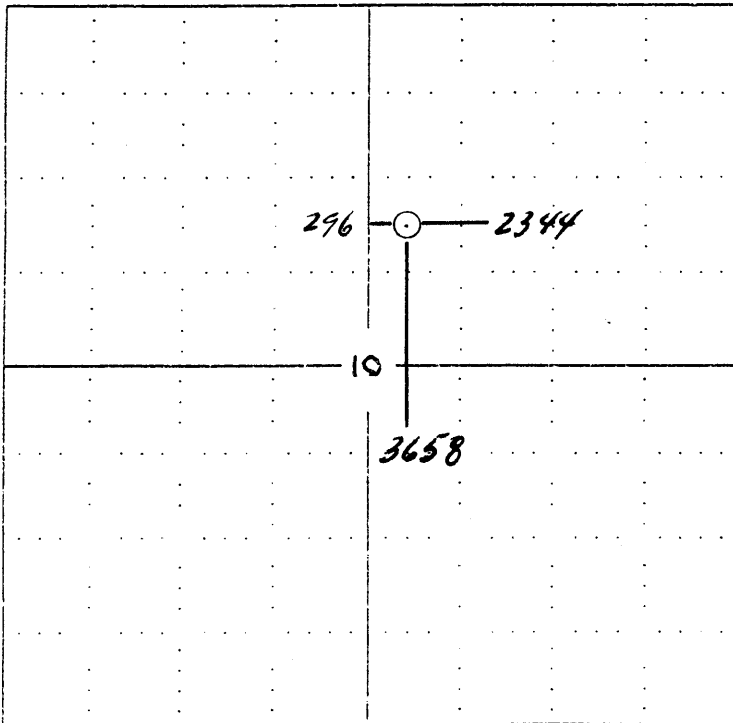

**NOTE:** In all cases locate the spot of the proposed drilling location.

In plotting the proposed location of the well, you must show:

1. The manner in which you are using the depicted plat by identifying section lines, i.e. 1 section, 1 section with 8 surrounding sections, 4 sections, etc.
2. The distance of the proposed drilling location from the section's south / north and east / west.
3. The distance to the nearest lease or unit boundary line.
4. If proposed location is located within a prorated or spaced field a certificate of acreage attribution plat must be attached: (CO-7 for oil wells; CO-8 for gas wells).