

For KCC Use:
 Effective Date: 8-21-03
 District #: 3
 SGA? Yes No

KANSAS CORPORATION COMMISSION
 OIL & GAS CONSERVATION DIVISION

FIRST CORRECTED

Form C-1
 September 1999
 Form must be Typed
 Form must be signed
 All blanks must be Filled

NOTICE OF INTENT TO DRILL

Must be approved by KCC five (5) days prior to commencing well

Expected Spud Date: August 20, 2003
 month day year

Sec: Ap NW/4 SW/4 NE/4 Sec. 10 Twp. 35 S. R. 21
 East West

OPERATOR: License# 33264
 Name: Central Production Co. Inc.
 Address: 718 Oak St.
 City/State/Zip: Humboldt, KS 66748
 Contact Person: John Sperry
 Phone: 417-667-5062/417-684-4294

3520 feet from N (circle one) Line of Section
2423 feet from W (circle one) Line of Section
 Is SECTION: Regular Irregular?

(Note: Locate well on the Section Plat on reverse side)

CONTRACTOR: License# 33274
 Name: David Casey

County: Labette
 Lease Name: Barr Well # 847
 Field Name: Chetopa

Is this a Prorated / Spaced Field? Yes No
 Target Formation(s): Bartlesville

Well Drilled For:	Well Class:	Type Equipment:
<input checked="" type="checkbox"/> Oil	<input checked="" type="checkbox"/> Infield	<input type="checkbox"/> Mud Rotary
<input type="checkbox"/> Gas	<input type="checkbox"/> Pool Exp.	<input checked="" type="checkbox"/> Air Rotary
<input type="checkbox"/> CWAC	<input type="checkbox"/> Wildcat	<input type="checkbox"/> Cable
<input type="checkbox"/> Seismic: # of Holes	<input type="checkbox"/> Other	
<input type="checkbox"/> Other		

Nearest Lease or unit boundary: 217'
837.06 feet MSL

Ground Surface Elevation: _____ feet MSL
 Water well within one-quarter mile: Yes No
 Public water supply well within one mile: Yes No

Depth to bottom of fresh water: 200 ft+
 Depth to bottom of usable water: 300 ft+

Surface Pipe by Alternate: X-2
 Length of Surface Pipe Planned to be set: 20 ft

Length of Conductor Pipe required: 20 ft
 Projected Total Depth: 150'

Formation at Total Depth: Bartlesville
 Water Source for Drilling Operations:
 Well _____ Farm Pond _____ Other NONE - air rotary

If OWAC: old well information as follows:
 Operator: _____
 Well Name: _____
 Original Completion Date: _____ Original Total Depth: _____

Directional, Deviated or Horizontal wellbore? Yes No

If yes, true vertical depth: _____
 Bottom Hole Location: _____

KCC DKT #: _____

DWR Permit #: _____
 (Note: Apply for Permit with DWP)

Will Cores be taken? Yes No

If Yes, proposed zone: _____

*** WAS = EOR
 IF = OIL**

AFFIDAVIT

**RECEIVED
 KANSAS CORPORATION COMMISSION**

AUG 18 2003

The undersigned hereby attests that the drilling, completion and eventual plugging of this well will comply with K.S.A. 35-101, et seq.
 It is agreed that the following minimum requirements will be met:

**Permit Extension -
 Request Received 1-25-04**

**CONSERVATION DIVISION
 WICHITA, KS**

1. Notify the appropriate district office prior to spudding of well;
2. A copy of the approved notice of intent to drill shall be posted on each drilling rig;
3. The minimum amount of surface pipe as specified below shall be set by circulating cement to the top of all cases surface pipe shall be set through all unconsolidated materials plus a minimum of 20 feet into the underlying formation.
4. If the well is dry hole, an agreement between the operator and the district office on plug length and placement is necessary prior to plugging;
5. The appropriate district office will be notified before well is either plugged or production casing is cemented in;
6. If an ALTERNATE to COMPLETION, production pipe shall be cemented from below any usable water to surface within 120 days of spud date. In all cases, NOTIFY district office prior to any cementing.

I hereby certify that the statements made herein are true and to the best of my knowledge and belief.

Date: 8/13/03 Signature of Operator or Agent: John Sperry Title: Vice-president - Engr

For KCC Use ONLY

API # 15 - 099-23305-00-00

Conductor pipe required: NONE feet

Minimum surface pipe required: 20' feet per Alt. XO

Approved by: DPW 8-26-03 RJP 2-2-04

This authorization expires: 2-26-04 8-26-04
 (This authorization void if drilling not started within 8 months of effective date.)

Spud date: _____ Agent: _____

- Remember to:
- File Drill Fit Application (form CDP-1) with Intent to Drill;
 - File Completion Form ACO-1 within 120 days of spud date;
 - File acreage attribution plat according to field proration orders;
 - Notify appropriate district office 48 hours prior to workover or re-entry;
 - Submit plugging report (CP-4) after plugging is completed;
 - Obtain written approval before disposing or injecting salt water

Mail to: KCC - Conservation Division, 130 S. Market - Room 2078, Wichita, Kansas 67202

10
35
216

IN ALL CASES PLOT THE INTENDED WELL ON THE PLAT BELOW

Plat of acreage attributable to a well in a prorated or spaced field

If the intended well is in a prorated or spaced field, please fully complete this side of the form. If the intended well is in a prorated or spaced field complete the plat below showing that the well will be properly located in relationship to other wells producing from the common source of supply. Please show all the wells and within 1 mile of the boundaries of the proposed acreage attribution unit for gas wells and within 1/2 mile of the boundaries of the proposed acreage attribution unit for oil wells.

API No. 15 - _____
 Operator: Central Production Co. Inc.
 Lease: Barr
 Well Number: B47
 Field: Chetopa
 Number of Acres attributable to well: 0.50
 QTR / QTR / QTR of acreage: NW/4 - SW/4 - NE/4

Location of Well: County: Labette

3520 feet from S / N (circle one) Line of Section
2423 feet from E / W (circle one) Line of Section
 Sec. 10 Twp. 35 S. R. 21 East West

Is Section Regular or _____ Irregular

If Section is irregular, locate well from nearest corner boundary.
 Section corner used: ___NE ___NW ___SE ___SW

PLAT

(Show location of the well and shade attributable acreage for prorated or spaced wells.)
 (Show footage to the nearest lease or unit boundary line.)

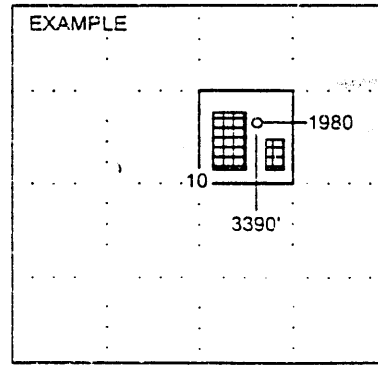
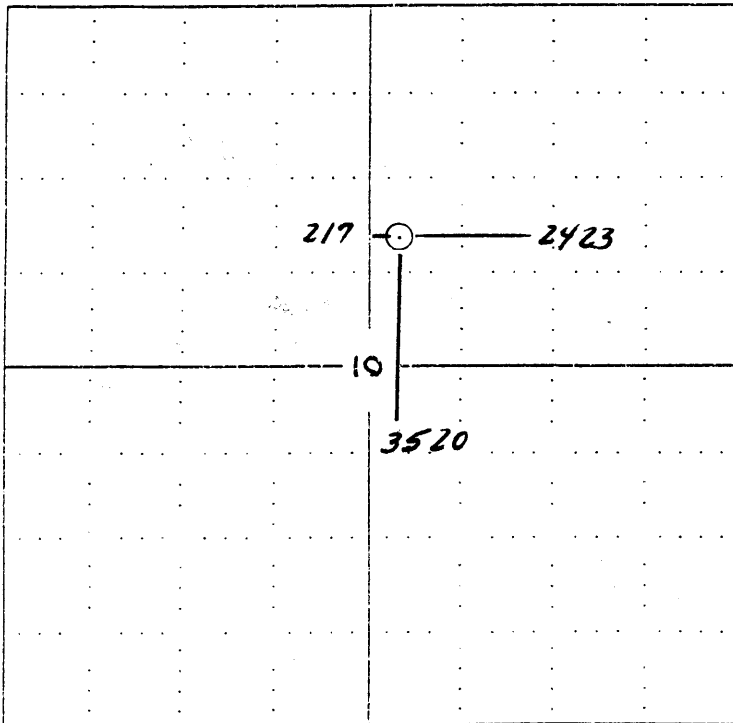

SEWARD CO.

NOTE: In all cases locate the spot of the proposed drilling location.

In plotting the proposed location of the well, you must show:

1. The manner in which you are using the depicted plat by identifying section lines, i.e. 1 section, 1 section with 8 surrounding sections, 4 sections, etc.
2. The distance of the proposed drilling location from the section's south / north and east / west.
3. The distance to the nearest lease or unit boundary line.
4. If proposed location is located within a prorated or spaced field a certificate of acreage attribution plat must be attached: (CO-7 for oil wells; CO-8 for gas wells).