

For KCC Use: 10-13-03  
Effective Date: 10-13-03  
District # \_\_\_\_\_  
SGA?  Yes  No

**KANSAS CORPORATION COMMISSION** **CORRECTED**  
**OIL & GAS CONSERVATION DIVISION**  
**NOTICE OF INTENT TO DRILL**

Form C-1  
December 2002  
Form must be Typed  
Form must be signed  
All blanks must be Filled

Must be approved by KCC five (5) days prior to commencing well

Expected Spud Date 11/25/03  
month day year

Spot: **\*CORRECTED 11/14/03**  East  
SE SE NW - SW Sec. 24 Twp. 27S R. 34  West

OPERATOR: License # 5447

\*1350 feet from  N /  S Line of Section

Name: OXY USA Inc.

\*1280 feet from  E /  W Line of Section

Address: P.O. Box 2528

Is SECTION X Regular \_\_\_\_\_ Irregular?

City/State/Zip: Liberal, KS 67905

(Note: Locate well on the Section Plat on reverse side)

Contact Person: Vicki Carder

County: Haskell

Phone: (620) 629-4242

Lease Name: Ward A Well #: 4

CONTRACTOR: License # Must USE KCC Lic. Driller

Field Name: Panoma Council Grove

Name: Will Advise on ACO-1

Is this a Prorated / Spaced Field?  Yes  No

Well Drilled For: Well Class: Type Equipment:

Target Formation(s): Council Grove

- Oil  Enh Rec  Infield  Mud Rotary  
 Gas  Storage  Pool Ext  Air Rotary  
 OWWO  Disposal  Wildcat  Cable  
 Seismic: # of Holes  Other Field Ext.  
 Other

Nearest Lease or unit Boundary: 1280

Ground Surface Elevation: 3015 feet MSL

Water well within one-quarter mile  Yes  No

Public water supply well within one mile:  Yes  No

Depth to bottom of fresh water: 500

Depth to bottom of usable water: 840

Surface Pipe by Alternate:  1  2

Length of Surface Pipe Planned to be set: 860' Min

Length of Conductor Pipe Required: NONE

Projected Total Depth: 3100

Formation at Total Depth: Council Grove

Water Source for Drilling Operations:

If OWWO: old well information as follows:  
Operator: \_\_\_\_\_  
Well Name: \_\_\_\_\_  
Original Completion Date: \_\_\_\_\_ Original Total Depth: \_\_\_\_\_

Well  Farm Pond Other X

DWR Permit # \_\_\_\_\_

(Note: Apply for Permit with DWR )

Directional, Deviated or Horizontal wellbore?  Yes  No

IF Yes, true vertical depth \_\_\_\_\_

Bottom Hole Location \_\_\_\_\_

KCC DKT #: \_\_\_\_\_

Will Cores be Taken?  Yes  No

If Yes, Proposed zone: \_\_\_\_\_

SEE ATTACHED PANOMA LETTER

PRORATED & SPACED HUGOTON & PANOMA

**AFFIDAVIT**

RECEIVED

The undersigned hereby affirms that the drilling, completion and eventual plugging of this well will comply with K.S.A. 55-101, et. Seq.  
It is agreed that the following minimum requirements will be met:

LOCATION WAS NENE SW SW, 1250' fsl, 1250' fsl  
IS SE SE NW SW, 1350' fsl, 1280' fsl

NOV 19 2003

KCC WICHITA

- Notify the appropriate district office **prior** to spudding of well;
- A copy of the approved notice of intent to drill **shall be** posted on each drilling rig;
- The minimum amount of surface pipe as specified below **shall be set** by circulating cement to the top; in all cases surface pipe **shall be set** through uncemented materials plus a minimum of 20 feet into the underlying formation.
- If the well is dry hole, an agreement between the operator and the district office on plug length and placement is necessary **prior to plugging**;
- The appropriate district office will be notified before well is either plugged or production casing is cemented in;
- If an ALTERNATE II COMPLETION, production pipe shall be cemented from below any usable water to surface within **120 days** of spud date. Or pursuant to Appendix "B" - Eastern Kansas surface casing order #133,891-C, which applies to the KCC District 3 area, alternate II cementing must be completed within 30 days of the spud date or the well shall be plugged. **In all cases, NOTIFY district office** prior to any cementing.

I hereby certify that the statements made herein are true and to the best of my knowledge and belief.

Date: November 14, 2003 Signature of Operator or Agent: Vicki Carder Title: Capital Project

**For KCC Use ONLY**

API # 15-081-21498-00-00  
Conductor pipe required NONE feet  
Minimum Surface pipe required 860 feet per Alt. (1) 2  
Approved by: RJP 10-8-03 / RJP 11-26-03  
This authorization expires: 4-8-04  
(This authorization void if drilling not started within 6 months of effective date.)  
Spud date: \_\_\_\_\_ Agent: \_\_\_\_\_

Remember to:

- File Drill Pit Application (form CDP-1) with Intent to Drill;
- File Completion Form ACO-1 within 120 days of spud date;
- File acreage attribution plat according to field proaction orders;
- Notify appropriate district office 48 hours prior to workover or re-entry;
- Submit plugging report (CP-4) after plugging is completed;
- Obtain written approval before disposing or injecting salt water.
- If this permit has expired (see: authorized expiration date) please check the box below and return to the address below.

Well Not Drilled - Permit Expired

Signature of Operator or Agent: \_\_\_\_\_

Date: \_\_\_\_\_

Mail to: KCC - Conservation Division, 130 S. Market - Room 2078, Wichita, Kansas 67202

24 27 34

**IN ALL CASES PLOT THE INTENDED WELL ON THE PLAT BELOW**

*Plat of acreage attributable to a well in a prorated or spaced field*

**If the intended well is in a prorated or spaced field, please fully complete this side of the form.** If the intended well is in a prorated or spaced field complete the plat below showing that the well will be properly located in relationship to other wells producing from the common source of supply. Please show all the wells and within 1 mile of the boundaries of the proposed acreage attribution unit for gas wells and within 1/2 mile of the boundaries of the proposed acreage attribution unit for oil wells.

API No. 15 - \_\_\_\_\_  
 Operator: OXY USA Inc.  
 Lease: Ward A  
 Well Number: 4  
 Field: Panoma Council Grove

Number of Acres attributable to well: 640  
 QTR / QTR / QTR of acreage: NE - SW - SW

Location of Well: County Haskell  
1350 feet from  N /  S Line of Section  
1280 feet from  E /  W Line of Section  
 Sec. 24 Twp. 27S R. 34  East  West

Is Section  Regular or  Irregular

**IF Section Is Irregular, locate well from nearest corner boundary.**

Section corner used:  NE  NW  SE  SW

**PLAT**

*(Show location of the well and shade attributable acreage for prorated or spaced wells.)  
 (Show footage to the nearest lease or unit boundary line.)*

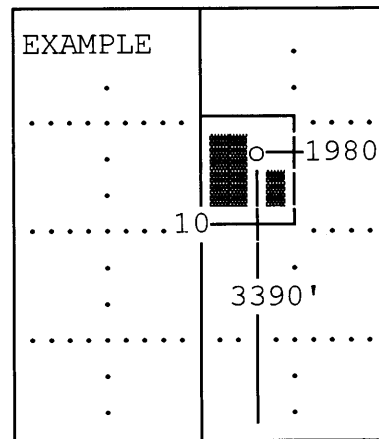
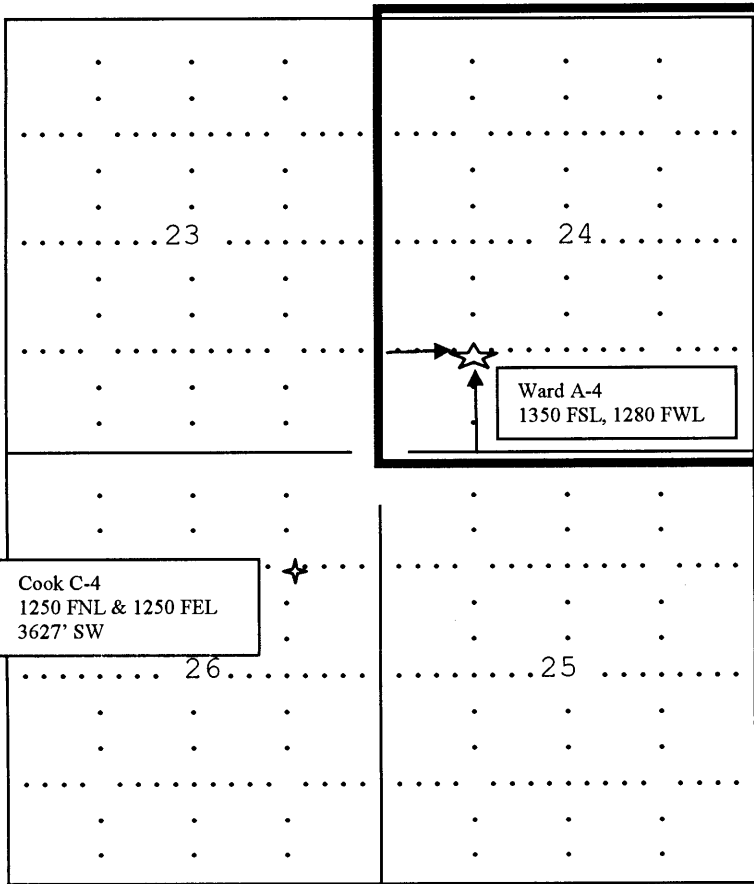

SEWARD CO.

**Note: In all cases locate the spot of the proposed drilling location.**

Haskell County

**In plotting the proposed location of the well, you must show:**

1. The manner in which you are using the depicted plat by identifying section lines, i.e. 1 section, 1 section with 8 surrounding sections, 4 sections, etc.
2. The distance of the proposed drilling location from the sections south / north and east / west.
3. The distance to the nearest lease or unit boundary line.
4. If proposed location is located within a prorated or spaced field a certificate of acreage attribution plat must be attached: (CO-7 for oil wells; CG-8 for gas wells).