

RECEIVED

Form C-1

December 2002

Form must be Typed

Form must be Signed

blanks must be Filled

For KCC Use: 12.5.03
Effective Date: 12.5.03
District #: 3
SGA? [] Yes [X] No

KANSAS CORPORATION COMMISSION
OIL & GAS CONSERVATION DIVISION

DEC 03 2003

NOTICE OF INTENT TO DRILL

KCC WICHITA

Must be approved by KCC five (5) days prior to commencing well

Expected Spud Date: December 10, 2003
month day year

Spot SE SE Sec. 36 Twp. 32 S. R. 10
10 feet from N / S Line of Section
10 feet from E / W Line of Section

Is SECTION [X] Regular [] Irregular?

(Note: Locate well on the Section Plat on reverse side)

County: Chautauqua
Lease Name: Arrington "5" Well #: CGEH#1
Field Name: Floyd Landon

Is this a Prorated / Spaced Field? [] Yes [] No

Target Information(s): Mississippi

Nearest Lease or unit boundary: 2700' (Unit AH)

Ground Surface Elevation: 1120' feet MSL

Water well within one-quarter mile: [X] Yes [X] No

Public water supply well within one mile: [] Yes [X] No

Depth to bottom of fresh water: 120'

Depth to bottom of usable water: 200' 300'

Surface Pipe by Alternate: [] 1 [X] 2

Length of Surface Pipe Planned to be set: 65'

Length of Conductor Pipe required: - -

Projected Total Depth: 2500'

Formation at Total Depth: Mississippi

Water Source for Drilling Operations: [] Well [X] Farm Pond [] Other

DWR Permit #: (Note: Apply for Permit with DWR [])

Will Cores be taken? [] Yes [X] No

If Yes, proposed zone:

OPERATOR: License# 31834
Name: Consolidated Gas and Energy
Address: c/o Rte 2 Box 225
City/State/Zip: Neodesha, Ks 66757
Contact Person: J.J. Hanke
Phone: 620) 325-5212

CONTRACTOR: License# 8736
Name: James D. Dixon

Well Drilled For: [X] Gas [] Oil [] Enh Rec [] Infield [] Pool Ext. [] Air Rotary [] Cable
Well Class: [] Storage [] Wildcat [] Other
Type Equipment: [X] Mud Rotary [] Air Rotary [] Cable

If OWWO: old well information as follows:
Operator:
Well Name:
Original Completion Date: Original Total Depth:

Directional, Deviated or Horizontal wellbore? [] Yes [X] No

If Yes, true vertical depth:

Bottom Hole Location:

KCC DKT #: * Unit Boundary *

AFFIDAVIT

The undersigned hereby affirms that the drilling, completion and eventual plugging of this well will comply with K.S.A. 55 et. seq.

It is agreed that the following minimum requirements will be met:

- 1. Notify the appropriate district office prior to spudding of well;
2. A copy of the approved notice of intent to drill shall be posted on each drilling rig;
3. The minimum amount of surface pipe as specified below shall be set by circulating cement to the top; in all cases surface pipe shall be set through all unconsolidated materials plus a minimum of 20 feet into the underlying formation.
4. If the well is dry hole, an agreement between the operator and the district office on plug length and placement is necessary prior to plugging;
5. The appropriate district office will be notified before well is either plugged or production casing is cemented in;
6. If an ALTERNATE II COMPLETION, production pipe shall be cemented from below any usable water to surface within 120 days of spud date. Or pursuant to Appendix "B" - Eastern Kansas surface casing order #133,891-C, which applies to the KCC District 3 area, alternate II cementing must be completed within 30 days of the spud date or the well shall be plugged. In all cases, NOTIFY district office prior to any cementing.

I hereby certify that the statements made herein are true and to the best of my knowledge and belief.

Date: Dec 1, 03 Signature of Operator or Agent: [Signature] Title: Consultant

For KCC Use ONLY
API # 15 - 019-26615-00-00
Conductor pipe required NONE feet
Minimum surface pipe required 40 feet per Alt. # 2
Approved by: RJP 12.5.03
This authorization expires: 6.5.04
Spud date: Agent:

Remember to:

- File Drill Pit Application (form CDP-1) with Intent to Drill;
- File Completion Form ACO-1 within 120 days of spud date;
- File acreage attribution plat according to field proration orders;
- Notify appropriate district office 48 hours prior to workover or re-entry;
- Submit plugging report (CP-4) after plugging is completed;
- Obtain written approval before disposing or injecting salt water.
- If this permit has expired (See: authorized expiration date) please check the box below and return to the address below.

[] Well Not Drilled - Permit Expired

Signature of Operator or Agent:

Date:

Mail to: KCC - Conservation Division, 130 S. Market - Room 2078, Wichita, Kansas 67202

36 32 10E

IN ALL CASES PLOT THE INTENDED WELL ON THE PLAT BELOW

Plat of acreage attributable to a well in a prorated or spaced field

If the intended well is in a prorated or spaced field, please fully complete this side of the form. If the intended well is in a prorated or spaced field complete the plat below showing that the well will be properly located in relationship to other wells producing from the common source of supply. Please show all the wells and within 1 mile of the boundaries of the proposed acreage attribution unit for gas wells and within 1/2 mile of the boundaries of the proposed acreage attribution unit for oil wells.

API No. 15 - _____
 Operator: Consolidated Gas and Energy
 Lease: Arrington "5"
 Well Number: CGEH#1
 Field: Floyd Landon
 Number of Acres attributable to well: 80
 QTR / QTR / QTR of acreage: SE SE SE

Location of Well: County: Chautauqua
10 feet from N / S Line of Section
10 feet from E / W Line of Section
 Sec. 36 Twp. 32 S. R. 10 East West

Is Section: Regular or Irregular

If Section is Irregular, locate well from nearest corner boundary.

Section corner used: NE NW SE SW

PLAT

(Show location of the well and shade attributable acreage for prorated or spaced wells.)

(Show footage to the nearest lease or unit boundary line.)

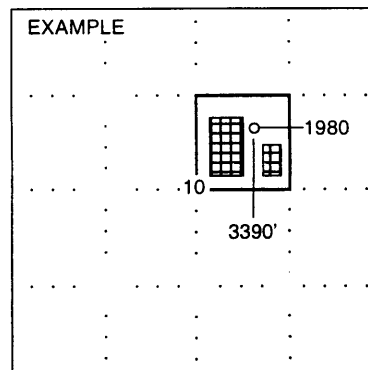
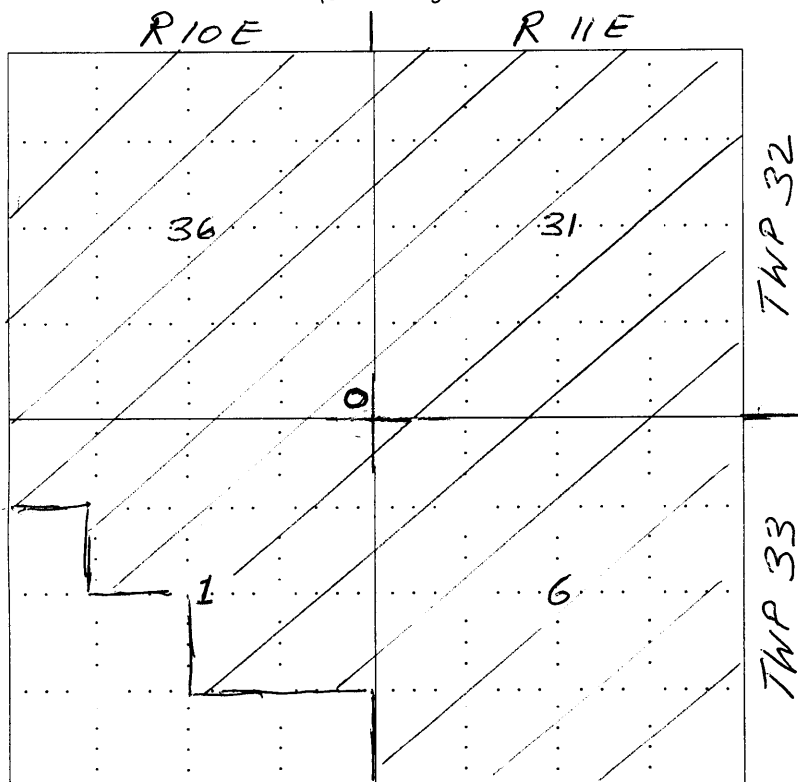

SEWARD CO.

NOTE: In all cases locate the spot of the proposed drilling locaton.

In plotting the proposed location of the well, you must show:

1. The manner in which you are using the depicted plat by identifying section lines, i.e. 1 section, 1 section with 8 surrounding sections, 4 sections, etc.
2. The distance of the proposed drilling location from the section's south / north and east / west.
3. The distance to the nearest lease or unit boundary line.
4. If proposed location is located within a prorated or spaced field a certificate of acreage attribution plat must be attached: (CO-7 for oil wells; CG-8 for gas wells).