

For KCC Use: 11-9-03  
 Effective Date: 4  
 District # 4  
 SGA?  Yes  No

KANSAS CORPORATION COMMISSION  
 OIL & GAS CONSERVATION DIVISION  
**NOTICE OF INTENT TO DRILL**

Must be approved by KCC five (5) days prior to commencing well

RECEIVED  
 OCT 29 2003  
 KCC WICHITA

Form C-1  
 December 2002  
 Form must be Typed  
 Form must be Signed  
 All blanks must be Filled

Expected Spud Date December 5, 2003  
month day year

OPERATOR: License# 32047  
 Name: MICA Energy Corp.  
 Address: P.O. Box 20707  
 City/State/Zip: Oklahoma City, OK 73156  
 Contact Person: Michael E. Carr  
 Phone: 405-942-4552

CONTRACTOR: License# KLN 20606  
 Name: Murfin Drilling Company

<b>Well Drilled For:</b>	<b>Well Class:</b>	<b>Type Equipment:</b>
<input checked="" type="checkbox"/> Oil	<input type="checkbox"/> Enh Rec	<input type="checkbox"/> Infield
<input type="checkbox"/> Gas	<input type="checkbox"/> Storage	<input type="checkbox"/> Pool Ext.
<input type="checkbox"/> OWO	<input type="checkbox"/> Disposal	<input checked="" type="checkbox"/> Wildcat
<input type="checkbox"/> Seismic; # of Holes	<input type="checkbox"/> Other	<input type="checkbox"/> Cable
<input type="checkbox"/> Other		

If OWWO: old well information as follows:  
 Operator: \_\_\_\_\_  
 Well Name: \_\_\_\_\_  
 Original Completion Date: \_\_\_\_\_ Original Total Depth: \_\_\_\_\_

Directional, Deviated or Horizontal wellbore?  Yes  No

If Yes, true vertical depth: \_\_\_\_\_

Bottom Hole Location: \_\_\_\_\_

KCC DKT #: \_\_\_\_\_

Spot NE SE Sec. 20 Twp. 2S S. R. 25  
 S1/2 - 1575' feet from  N /  S Line of Section  
610 feet from  E /  W Line of Section

Is SECTION  Regular  Irregular?  
 (Note: Locate well on the Section Plat on reverse side)

County: Norton  
 Lease Name: Connell Well #: 1  
 Field Name: Wildcat

Is this a Prorated / Spaced Field?  Yes  No

Target Information(s): LKC, Arbuckle, Reagan  
 Nearest Lease or unit boundary: 660'

Ground Surface Elevation: 2570' feet MSL  
 Water well within one-quarter mile:  Yes  No

Public water supply well within one mile:  Yes  No

Depth to bottom of fresh water: 480' 230'  
 Depth to bottom of usable water: 4400' 1300' Kiowa

Surface Pipe by Alternate:  1  2

Length of Surface Pipe Planned to be set: 350'

Length of Conductor Pipe required: None

Projected Total Depth: 3800'

Formation at Total Depth: Granite

Water Source for Drilling Operations:  
 Well  Farm Pond Other  X

DWR Permit #: \_\_\_\_\_  
 (Note: Apply for Permit with DWR )  
 Will Cores be taken?  Yes  No

If Yes, proposed zone: \_\_\_\_\_

**AFFIDAVIT**

The undersigned hereby affirms that the drilling, completion and eventual plugging of this well will comply with K.S.A. 55 et. seq.  
 It is agreed that the following minimum requirements will be met:

1. Notify the appropriate district office **prior** to spudding of well;
2. A copy of the approved notice of intent to drill **shall be** posted on each drilling rig;
3. The minimum amount of surface pipe as specified below **shall be set** by circulating cement to the top; in all cases surface pipe **shall be set** through all unconsolidated materials plus a minimum of 20 feet into the underlying formation.
4. If the well is dry hole, an agreement between the operator and the district office on plug length and placement is necessary **prior to plugging**;
5. The appropriate district office will be notified before well is either plugged or production casing is cemented in;
6. If an ALTERNATE II COMPLETION, production pipe shall be cemented from below any usable water to surface within **120 days** of spud date.  
 Or pursuant to Appendix "B" - Eastern Kansas surface casing order #133,891-C, which applies to the KCC District 3 area, alternate II cementing must be completed within 30 days of the spud date or the well shall be plugged. **In all cases, NOTIFY district office** prior to any cementing.

I hereby certify that the statements made herein are true and to the best of my knowledge and belief.

Date: 10-26-03 Signature of Operator or Agent: [Signature] Title: President

**For KCC Use ONLY**  
 API # 15 - 137-20422-00-00  
 Conductor pipe required NONE feet  
 Minimum surface pipe required 280 feet per Alt. (2)  
 Approved by: RSP 11-4-03  
 This authorization expires: 5-4-04  
 (This authorization void if drilling not started within 6 months of effective date.)  
 Spud date: \_\_\_\_\_ Agent: \_\_\_\_\_

**Remember to:**

- File Drill Pit Application (form CDP-1) with Intent to Drill;
  - File Completion Form ACO-1 within 120 days of spud date;
  - File acreage attribution plat according to field proration orders;
  - Notify appropriate district office 48 hours prior to workover or re-entry;
  - Submit plugging report (CP-4) after plugging is completed;
  - Obtain written approval before disposing or injecting salt water.
- If this permit has expired (See: authorized expiration date) please check the box below and return to the address below.

Well Not Drilled - Permit Expired  
 Signature of Operator or Agent: \_\_\_\_\_  
 Date: \_\_\_\_\_

Mail to: KCC - Conservation Division, 130 S. Market - Room 2078, Wichita, Kansas 67202

20  
2  
25M

OCT 24 1980

P.O. Box 404  
Concordia, Ks. 66901

**Fall & Associates**  
Stake and Elevation Service  
1-800-536-2821

Invoice Number KO1020032

<u>MICA ENERGY CORP.</u> Operator		<u>1</u> Number		<u>Connell</u> Farm Name
<u>Norton-KS</u> County-State	<u>20</u> S	<u>2s</u> T	<u>25w</u> R	<u>1575' FSL 610' FEL Sec.</u> Location

\* MICA ENERGY  
P.O. Box 20707  
Oklahoma City, OK 73156

Elevation 2570 Gr.

Ordered By: Mike

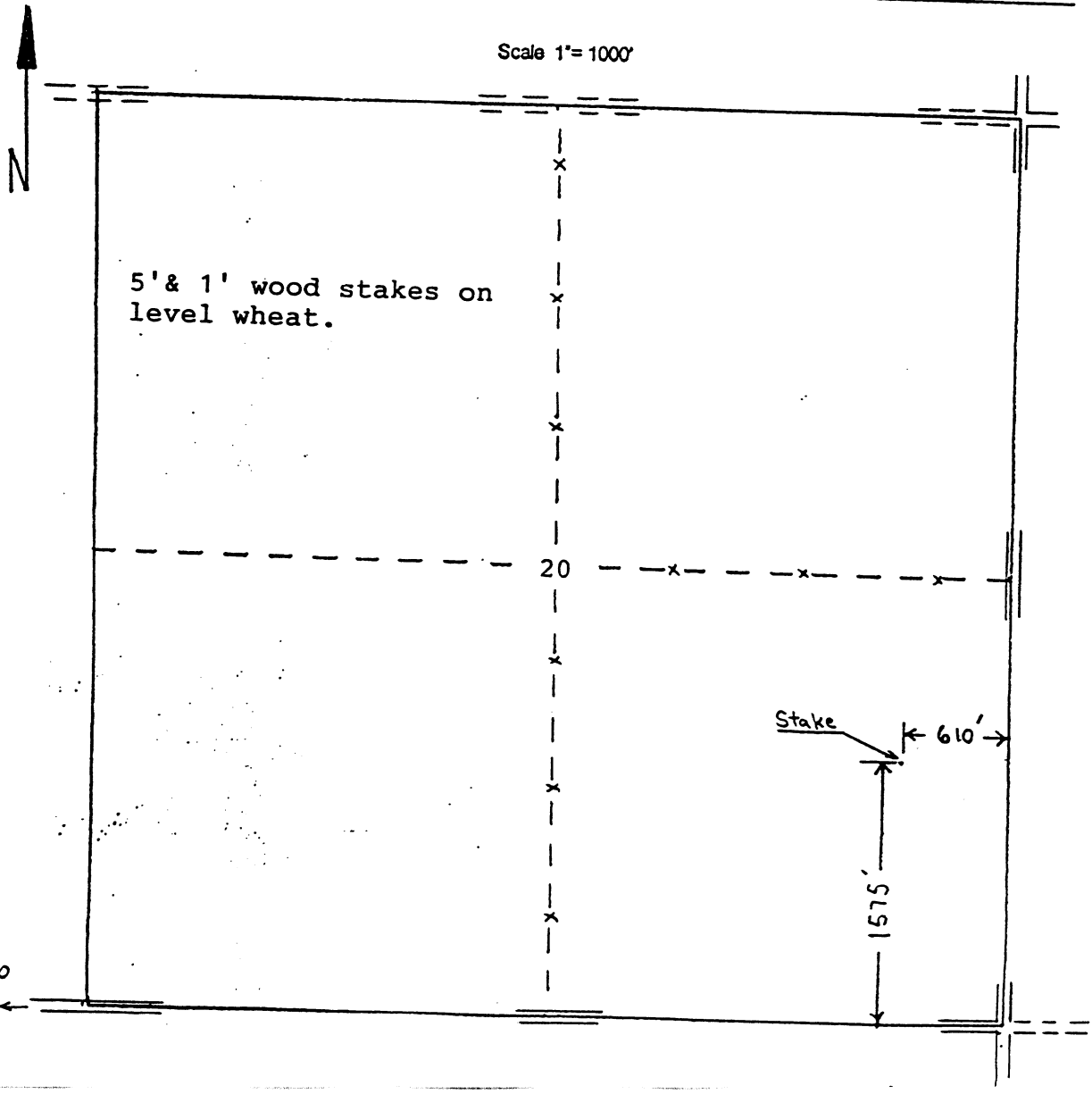

IN ALL CASES PLOT THE INTENDED WELL ON THE PLAT BELOW

Plat of acreage attributable to a well in a prorated or spaced field

If the intended well is in a prorated or spaced field, please fully complete this side of the form. If the intended well is in a prorated or spaced field complete the plat below showing that the well will be properly located in relationship to other wells producing from the common source of supply. Please show all the wells and within 1 mile of the boundaries of the proposed acreage attribution unit for gas wells and within 1/2 mile of the boundaries of the proposed acreage attribution unit for oil wells.

API No. 15 - \_\_\_\_\_
Operator: MICA Energy Corp.
Lease: Connell
Well Number: 1
Field: Wildcat
Number of Acres attributable to well: \_\_\_\_\_
QTR / QTR / QTR of acreage: S/2 - NE - SE

Location of Well: County: Norton
1575' feet from N / S Line of Section
610 feet from E / W Line of Section
Sec. 20 Twp. 2S S. R. 25 East West

Is Section: Regular or Irregular

If Section is Irregular, locate well from nearest corner boundary.

Section corner used: NE NW SE SW

PLAT

(Show location of the well and shade attributable acreage for prorated or spaced wells.)

(Show footage to the nearest lease or unit boundary line.)

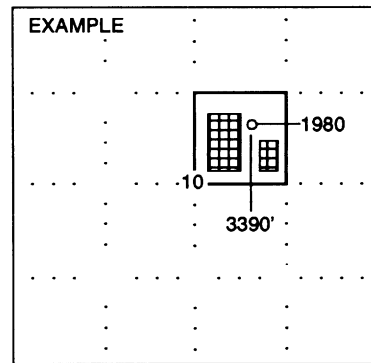
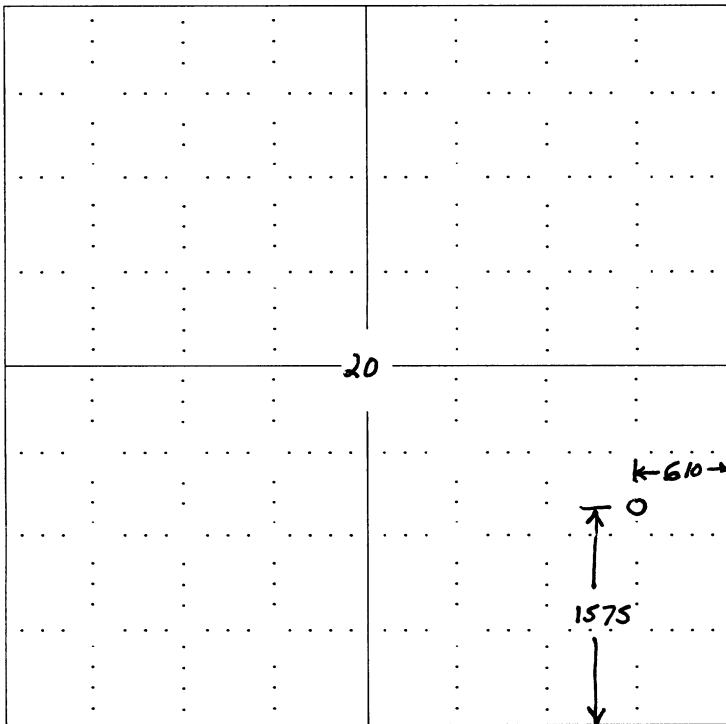

NOTE: In all cases locate the spot of the proposed drilling locaton.

In plotting the proposed location of the well, you must show:

- 1. The manner in which you are using the depicted plat by identifying section lines, i.e. 1 section, 1 section with 8 surrounding sections, 4 sections, etc.
2. The distance of the proposed drilling location from the section's south / north and east / west.
3. The distance to the nearest lease or unit boundary line.
4. If proposed location is located within a prorated or spaced field a certificate of acreage attribution plat must be attached: (CO-7 for oil wells; CG-8 for gas wells).