

RECEIVED

For KCC Use: 1-7.04  
Effective Date: 3  
District # 3  
SGA?  Yes  No

KANSAS CORPORATION COMMISSION  
OIL & GAS CONSERVATION DIVISION

JAN 02 2004

Form C-1  
September 1999  
Form must be Typed  
Form must be Signed  
All blanks must be Filled

NOTICE OF INTENT TO DRILL

Must be approved by KCC rive (5) days prior to commencing well

KCC WICHITA

Expected Spud Date January 7 2004  
month day year

Spot NE - SE - SW Sec 22 Twp. 26 S. R. 18  
 East  
 West  
1025 feet from S (circle one) Line of Section  
2900 feet from E (circle one) Line of Section  
Is SECTION  Regular  Irregular?

OPERATOR: License# 5488  
Name: TWM Production Company  
Address: 1150 Highway 39  
City/State/Zip: Chanute, Kansas 66720  
Contact Person: Michael or Carol Wimsett  
Phone: 620-431-4137

(Note: Locate well on the Section Plat on reverse side)  
County: Allen  
Lease Name: DICE Well #: D-7  
Field Name: Humboldt/Chanute

CONTRACTOR: License# 5491  
Name: W & W Production Company

Is this a Prorated / Spaced Field?  Yes  No  
Target Information(s): Bartlesville  
Nearest Lease or unit boundary: 1025 260?

Well Drilled For: Well Class: Type Equipment:  
 Oil  Enh Rec  Infield  Mud Rotary  
 Gas  Storage  Pool Ext.  Air Rotary  
 OWWO  Disposal  Wildcat  Cable  
 Seismic; # of Holes  Other  
 Other

Ground Surface Elevation: N/A feet MSL  
Water well within one-quarter mile:  Yes  No  
Public water supply well within one mile:  Yes  No

If OWWO: old well information as follows:  
Operator: \_\_\_\_\_  
Well Name: \_\_\_\_\_  
Original Completion Date: \_\_\_\_\_ Original Total Depth: \_\_\_\_\_

Depth to bottom of fresh water: 100  
Depth to bottom of usable water: 150  
Surface Pipe by Alternate: 1  2  
Length of Surface Pipe Planned to be set: 20  
Length of Conductor Pipe required: N/A  
Projected Total Depth: 1000

Directional, Deviated or Horizontal wellbore?  Yes  No

Producing Formation Target: Bartlesville  
Water Source for Drilling Operations:  
Well  Farm Pond  Other \_\_\_\_\_

If Yes, true vertical depth, \_\_\_\_\_  
Bottom Hole Location: \_\_\_\_\_

DWR Permit # \_\_\_\_\_  
(Note: Apply for Permit with DWR )

KCC DKT #: \_\_\_\_\_

Will Cores be taken?  Yes  No  
If Yes, proposed zone: \_\_\_\_\_

AFFIDAVIT

The undersigned hereby affirms that the drilling, completion and eventual plugging of this well will comply with K.S.A. 55-101, et. seq.  
It is agreed that the following minimum requirements will be met:

1. Notify the appropriate district office **prior** to spudding of well;
2. A copy of the approved notice of intent to drill **shall be** posted on each drilling rig;
3. The minimum amount of surface pipe as specified below **shall be set** by circulating cement to the top-, in all cases surface pipe shall be set through all unconsolidated materials plus a minimum of 20 feet into the underlying formation.
4. If the well is dry hole, an agreement between the operator and the district office on plug length and placement is necessary **prior to plugging**,
5. The appropriate district office will be notified before well is either plugged or production casing is cemented in;
6. If an ALTERNATE II COMPLETION, production pipe shall be cemented from below any usable water to surface within 120 days of spud date. In all cases, **NOTIFY** district office prior to any cementing.

I hereby certify that the statements made herein are true and to the best of my knowledge and belief.

Date: DEC. 29, 2003 Signature of Operator or Agent: Carol A. Wimsett Title: Office Manager

For KCC Use ONLY  
API # 15 - 001-29063-00-00  
Conductor pipe required NONE feet  
Minimum surface pipe required 20 feet per Alt. 2  
Approved by: RJP 1-2-04  
This authorization expires: 7-2-04  
(This authorization void if drilling not started within 6 months of effective date.)  
Spud date: \_\_\_\_\_ Agent: \_\_\_\_\_

- Remember to:
- File Drill Pit Application (form CDP-1) with Intent to Drill;
  - File Completion Form ACO-1 within 120 days of spud date;
  - File acreage attribution plat according to field proration orders;
  - Notify appropriate district office 48 hours prior to workover or re-entry,
  - Submit plugging report (CP-4) after plugging is completed;
  - Obtain written approval before disposing or injecting salt water.

Mail to: KCC - Conservation Division, 130 S. Market - Room 2078, Wichita, Kansas 67202

22 26 18E

RECEIVED

JAN 02 2004

KCC WICHITA

IN ALL CASES PLOT THE INTENDED WELL ON THE PLAT BELOW

Plat of acreage attributable to a well in a prorated or spaced field

If the intended well is in a prorated or spaced field, please fully complete this side of the form. If the intended well is in a prorated or spaced field complete the plat below showing that the well will be properly located in relationship to other wells producing from the common source of supply. Please show all the wells and within 1 mile of the boundaries of the proposed acreage attribution unit for gas wells and within 1/2 mile of the boundaries of the proposed acreage attribution unit for oil wells.

API No. 15 - \_\_\_\_\_
Operator: Twm Production Co.
Lease: DICE
Well Number: D-7
Field: HUMBOLDT/CHANUTE
Number of Acres attributable to well: \_\_\_\_\_
QTR / QTR / QTR of acreage: \_\_\_\_\_

Location of Well: County: ALLEN
1025 feet from N / S Line of Section
2900 feet from E / W Line of Section
Sec. 22 Twp. 26 S. R. 18
Is Section: Regular or Irregular
If Section is Irregular, locate well from nearest corner boundary.
Section corner used: NE NW SE SW

PLAT

(Show location of the well and shade attributable acreage for prorated or spaced wells.)
(Show footage to the nearest lease or unit boundary line.)

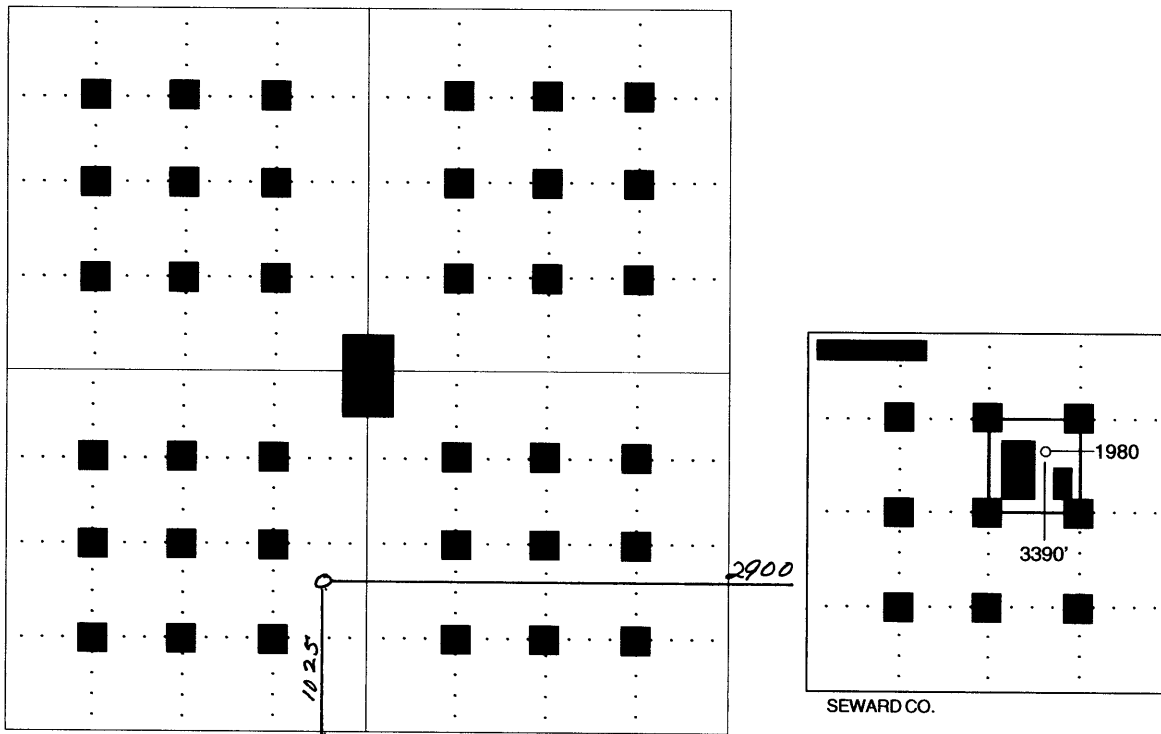

NOTE: In all cases locate the spot of the proposed drilling location.

Section 22

In plotting the proposed location of the well, you must show:

- 1. The manner in which you are using the depicted plat by identifying section lines, i.e. 1 section, 1 section with 8 surrounding sections, 4 sections, etc.
2. The distance of the proposed drilling location from the section's south / north and east / west.
3. The distance to the nearest lease or unit boundary line.
4. If proposed location is located within a prorated or spaced field a certificate of acreage attribution plat must be attached: (CO-7 for oil wells; CG-8 for gas wells).