

For KCC Use: 1-21-04
 Effective Date: 1-21-04
 District #: 1
 SGA? Yes No

KANSAS CORPORATION COMMISSION
 OIL & GAS CONSERVATION DIVISION
NOTICE OF INTENT TO DRILL

Must be approved by KCC five (5) days prior to commencing well

RECEIVED

JAN 14 2004

KCC WICHITA

Form C-1
 December 2002
 Form must be Typed
 Form must be Signed
 All blanks must be Filled

Expected Spud Date 2/1/04
 month day year

Spot SW SE SW Sec. 6 Twp. 30 S. R. 11 East West
330 feet from N / S Line of Section
3630 feet from E / W Line of Section
 Is SECTION Regular Irregular?

OPERATOR: License# 32192
 Name: Pride Energy Company
 Address: PO Box 701950
 City/State/Zip: Tulsa OK 74170-1950
 Contact Person: John W. Pride
 Phone: 9185249200

CONTRACTOR: License# 5123
 Name: Pickrell Drilling Company, Inc.

(Note: Locate well on the Section Plat on reverse side)

County: Barber
 Lease Name: Hoyt Well #: 1-6
 Field Name: Harding

Is this a Prorated / Spaced Field? Yes No
 Target Formation(s): Douglas, Burlingame, Indian Cave, Red Eagle
 Nearest Lease or unit boundary: 330' West & 330' South

Well Drilled For:	Well Class:	Type Equipment:
<input checked="" type="checkbox"/> Oil <input type="checkbox"/> Enh Rec <input checked="" type="checkbox"/> Infield <input checked="" type="checkbox"/> Mud Rotary	<input type="checkbox"/> Pool Ext. <input type="checkbox"/> Air Rotary	<input type="checkbox"/> Cable
<input checked="" type="checkbox"/> Gas <input type="checkbox"/> Storage <input type="checkbox"/> Wildcat	<input type="checkbox"/> Other	
<input type="checkbox"/> OWWO <input type="checkbox"/> Disposal		
<input type="checkbox"/> Seismic; # of Holes <input type="checkbox"/> Other		
<input type="checkbox"/> Other		

Ground Surface Elevation: Est. 1847' feet MSL
 Water well within one-quarter mile: Yes No
 Public water supply well within one mile: Isabel? Yes No

Depth to bottom of fresh water: 180
 Depth to bottom of usable water: 200 220
 Surface Pipe by Alternate: 1 2

If OWWO: old well information as follows:
 Operator: _____
 Well Name: _____
 Original Completion Date: _____ Original Total Depth: _____

Length of Surface Pipe Planned to be set: 300
 Length of Conductor Pipe required: None
 Projected Total Depth: 3950

Directional, Deviated or Horizontal wellbore? Yes No

Formation at Total Depth: Douglas

If Yes, true vertical depth: _____

Water Source for Drilling Operations:
 Well Farm Pond Other

Bottom Hole Location: _____

DWR Permit #: Drilling Contractor applying for

KCC DKT #: _____

(Note: Apply for Permit with DWR)

Will Cores be taken? Yes No

If Yes, proposed zone: _____

AFFIDAVIT

The undersigned hereby affirms that the drilling, completion and eventual plugging of this well will comply with K.S.A. 55 et. seq.

It is agreed that the following minimum requirements will be met:

1. Notify the appropriate district office **prior** to spudding of well;
2. A copy of the approved notice of intent to drill **shall be** posted on each drilling rig;
3. The minimum amount of surface pipe as specified below **shall be set** by circulating cement to the top; in all cases surface pipe **shall be set** through all unconsolidated materials plus a minimum of 20 feet into the underlying formation.
4. If the well is dry hole, an agreement between the operator and the district office on plug length and placement is necessary **prior to plugging**;
5. The appropriate district office will be notified before well is either plugged or production casing is cemented in;
6. If an ALTERNATE II COMPLETION, production pipe shall be cemented from below any usable water to surface within **120 days** of spud date. Or pursuant to Appendix "B" - Eastern Kansas surface casing order #133,891-C, which applies to the KCC District 3 area, alternate II cementing must be completed within 30 days of the spud date or the well shall be plugged. **In all cases, NOTIFY district office** prior to any cementing.

I hereby certify that the statements made herein are true and to the best of my knowledge and belief.

Pres. of Pride Oil & Gas Co.,
 Inc., as General Partner of
 Pride Energy Company

Date: 1/12/04 Signature of Operator or Agent: _____

John W. Pride
 John W. Pride

Title: _____

For KCC Use ONLY
 API # 15 - 007-22796-00-00
 Conductor pipe required NONE feet
 Minimum surface pipe required 270 feet per Alt. 1
 Approved by: RJPT-16-04
 This authorization expires: 7-16-04
 (This authorization void if drilling not started within 6 months of effective date.)
 Spud date: _____ Agent: _____

Remember to:

- File Drill Pit Application (form CDP-1) with Intent to Drill;
 - File Completion Form ACO-1 within 120 days of spud date;
 - File acreage attribution plat according to field proration orders;
 - Notify appropriate district office 48 hours prior to workover or re-entry;
 - Submit plugging report (CP-4) after plugging is completed;
 - Obtain written approval before disposing or injecting salt water.
- If this permit has expired (See: authorized expiration date) please check the box below and return to the address below.

Well Not Drilled - Permit Expired

Signature of Operator or Agent: _____
 Date: _____

Mail to: KCC - Conservation Division, 130 S. Market - Room 2078, Wichita, Kansas 67202

jp3526.hq

63011W

IN ALL CASES PLOT THE INTENDED WELL ON THE PLAT BELOW

Plat of acreage attributable to a well in a prorated or spaced field

If the intended well is in a prorated or spaced field, please fully complete this side of the form. If the intended well is in a prorated or spaced field complete the plat below showing that the well will be properly located in relationship to other wells producing from the common source of supply. Please show all the wells and within 1 mile of the boundaries of the proposed acreage attribution unit for gas wells and within 1/2 mile of the boundaries of the proposed acreage attribution unit for oil wells.

API No. 15 - _____
 Operator: Pride Energy Company
 Lease: Hoyt
 Well Number: 1-6
 Field: Harding

Number of Acres attributable to well: _____
 QTR / QTR / QTR of acreage: SW - SE - SW

Location of Well: County: Barber
330 feet from N / S Line of Section
3630 feet from E / W Line of Section
 Sec. 6 Twp. 30 S. R. 11 East West

Is Section: Regular or Irregular

If Section is Irregular, locate well from nearest corner boundary.

Section corner used: NE NW SE SW

PLAT

(Show location of the well and shade attributable acreage for prorated or spaced wells.)

(Show footage to the nearest lease or unit boundary line.)

Section 6

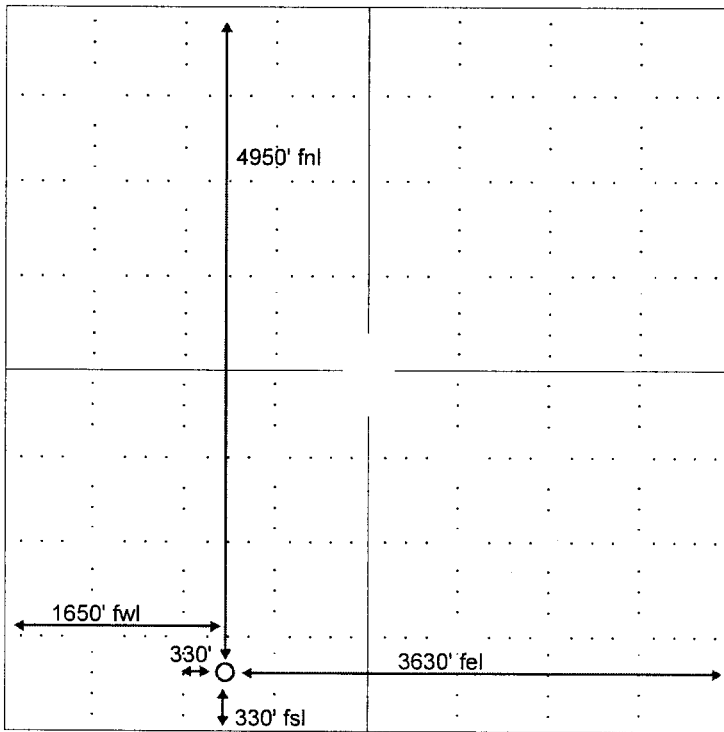

NOTE: In all cases locate the spot of the proposed drilling locaton.

330' from West lease line & 330' from South lease line.

In plotting the proposed location of the well, you must show:

1. The manner in which you are using the depicted plat by identifying section lines, i.e. 1 section, 1 section with 8 surrounding sections, 4 sections, etc.
2. The distance of the proposed drilling location from the section's south / north and east / west.
3. The distance to the nearest lease or unit boundary line.
4. If proposed location is located within a prorated or spaced field a certificate of acreage attribution plat must be attached: (CO-7 for oil wells; CG-8 for gas wells).

RECEIVED
 JAN 14 2004
 KCC WICHITA

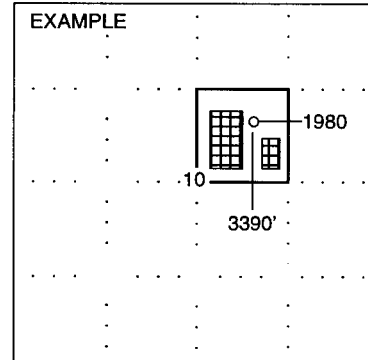

SEWARD CO.

KANSAS

CORPORATION COMMISSION

KATHLEEN SEBELIUS, GOVERNOR

BRIAN J. MOLINE, CHAIR

JOHN WINE, COMMISSIONER

ROBERT E. KREHBIEL, COMMISSIONER

January 16, 2004

John W Pride
Pride Energy Company
PO Box 701950
Tulsa OK 74170-1950

Re: Drilling Pit Application
Hoyt Lease Well No. 1-6
SW/4 06-30S-11W
Barber County, Kansas

Dear Mr. Pride:

District staff has inspected the above referenced location and has determined that the reserve pit shall be constructed **without slots**, the bottom shall be flat and reasonably level and the free fluids must be removed. The fluids are to be removed from the reserve pit as soon as the Hutchinson Salt section has been drilled through and displacement of the fluids into the reserve pit has occurred. The fluids should be removed again as soon as practical after drilling operations have ceased.

If production casing is set all completion fluids shall be removed on a daily basis.

The fluids should be taken to an authorized disposal well. Please call the District Office at (620) 225-8888 when the fluids have been removed. Also, please file the enclosed Surface Pond Waste Transfer, form CDP-5, within 30 days of fluid removal.

A copy of this letter should be posted in the doghouse along with the approved Intent to Drill. If you have any questions or concerns please feel free to contact the undersigned at the above address.

Sincerely,



Jonelle Rains, Supervisor
Department of Environmental Protection and Remediation

cc: Steve Durrant
File