

FOR KCC USE:

EFFECTIVE DATE: 6-1-11-04

DISTRICT # 1

SEAL X Yes No

FORM C-1 7/91

FORM MUST BE TYPED

FORM MUST BE SIGNED

ALL BLANKS MUST BE FILLED

State of Kansas
NOTICE OF INTENTION TO DRILL

Must be approved by the K.C.C. five (5) days prior to commencing well

Expected Spud Date January 10, 2004
month day year

Spot NW-NE-NE Sec 15 Twp 33 S. Rg 19 East X West

330 feet from South/North line of Section
990 feet from East/West line of Section

IS SECTION X REGULAR IRREGULAR

(NOTE: Locate well on the Section Plat on Reverse Side)

County: Comanche

Lease Name: Lindsay Well #: 1-15

Field Name: Colter

Is this a Prorated/Spaced Field? yes X no

Target Formation(s): Viola

Nearest lease or unit boundary: 330'

Ground Surface Elevation: 2033 feet MSL

Water well within one-quarter mile: X yes no

Public water supply well within one mile: yes X no

Depth to bottom of fresh water: 150'

Depth to bottom of usable water: 180'

Surface Pipe by Alternate: X 1 2

Length of Surface Pipe Planned to be set: 650

Length of Conductor pipe required: NONE

Projected Total Depth: 6200'

Formation at Total Depth: Viola

Water Source for Drilling Operations: well X farm pond other

DWR Permit #: Apply w/DWR if using well

Will Cores Be Taken?: yes X no

If yes, proposed zone:

OPERATOR: License # 6528
Name: R. J. Patrick Operating Company
Address: P.O. Box 1157
City/State/Zip: Liberal, Kansas 67905-1157
Contact Person: R. J. Patrick
Phone: 620.624-8483

CONTRACTOR: License #: 5929
Name: Duke Drilling Company, Inc.

Well Drilled For:	Well Class:	Type Equipment:
<u>X</u> Oil <u> </u> Enh Rec	<u> </u> Infield	<u>X</u> Mud Rotary
<u>X</u> Gas <u> </u> Storage	<u>X</u> Pool Ext.	<u> </u> Air Rotary
<u> </u> OWD	<u> </u> Wildcat	<u> </u> Cable
<u> </u> Seismic; <u> </u> # of Holes	<u> </u> Other	
<u> </u> Other		

If OWD: old well information as follows:
Operator:
Well Name:
Comp. Date: Old Total Depth

Directional, Deviated or Horizontal wellbore? yes X no
If yes, true vertical depth:
Bottom Hole Location:

AFFIDAVIT

The undersigned hereby affirms that the drilling, completion and eventual plugging of this well will comply with K.S.A. 55-101, et. seq.

It is agreed that the following minimum requirements will be met:

1. Notify the appropriate district office prior to spudding of well;
2. A copy of the approved notice of intent to drill shall be posted on each drilling rig;
3. The minimum amount of surface pipe as specified below shall be set by circulating cement to the top; in all cases surface pipe shall be set through all unconsolidated materials plus a minimum of 20 feet into the underlying formation;
4. If the well is dry hole, an agreement between the operator and the district office on plug length and placement is necessary prior to plugging;
5. The appropriate district office will be notified before well is either plugged or production casing is cemented in;
6. IF AN ALTERNATE II COMPLETION, PRODUCTION PIPE SHALL BE CEMENTED FROM BELOW ANY USABLE WATER TO SURFACE WITHIN 120 DAYS OF SPUD DATE. IN ALL CASES, NOTIFY DISTRICT OFFICE PRIOR TO ANY CEMENTING.

I hereby certify that the statements made herein are true and to the best of my knowledge and belief.

Date: December 30-03 Signature of Operator or Agent: R. J. Patrick Title: Owner

FOR KCC USE:
 API # 15- 033-21390.00-00
 Conductor pipe required NONE feet
 Minimum surface pipe required 20 feet per Alt. 1
 Approved by: R. J. Patrick
 This authorization expires: 7-6-04
 (This authorization void if drilling not started within 6 months of effective date.)
 Spud date: Agent:

REMEMBER TO:

- File Drill Pit Application (form CDP-1) with Intent to Drill;
- File Completion Form ACD-1 within 120 days of spud date;
- File acreage attribution plat according to field proration orders;
- Notify appropriate district office 48 hours prior to workover or re-entry;
- Submit plugging report (CP-4) after plugging is completed;
- Obtain written approval before disposing or injecting salt water.

Mail to: Conservation Division, 200 Colorado Derby Building, 202 W. First St., Wichita, Kansas 67202-1286.

RECEIVED

JAN 02 2004

KCC WICHITA

103
19W

IN ALL CASES PLOT THE INTENDED WELL ON THE PLAT BELOW

PLAT OF ACREAGE ATTRIBUTABLE TO A WELL IN A PRORATED OR SPACED FIELD

If the intended well is in a prorated or spaced field, please fully complete this side of the form. If the intended well is in a prorated or spaced field complete the plat below showing that the well will be properly located in relationship to other wells producing from the common source of supply. Please show all the wells within 1 mile of the boundaries of the proposed acreage attribution unit for gas wells and within 1/2 mile of the boundaries of the proposed acreage attribution unit for oil wells.

API NO. 15- _____
 OPERATOR _____ LOCATION OF WELL: COUNTY _____
 LEASE _____ feet from south/north line of section _____
 WELL NUMBER _____ feet from east/west line of section _____
 FIELD _____ SECTION _____ TWP _____ RG _____

NUMBER OF ACRES ATTRIBUTABLE TO WELL _____ IS SECTION _____ REGULAR or _____ IRREGULAR
 QTR/QTR/QTR OF ACREAGE _____ IF SECTION IS IRREGULAR, LOCATE WELL FROM NEAREST CORNER BOUNDARY.

Section corner used: _____ NE _____ NW _____ SE _____ SW

PLAT

(Show location of the well and shade attributable acreage for prorated or spaced wells.)
 (Show footage to the nearest lease or unit boundary line.)

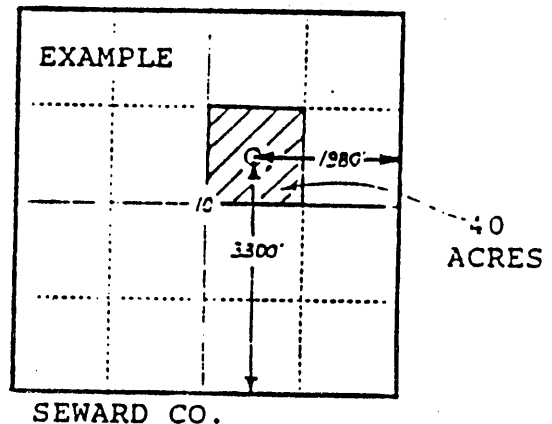
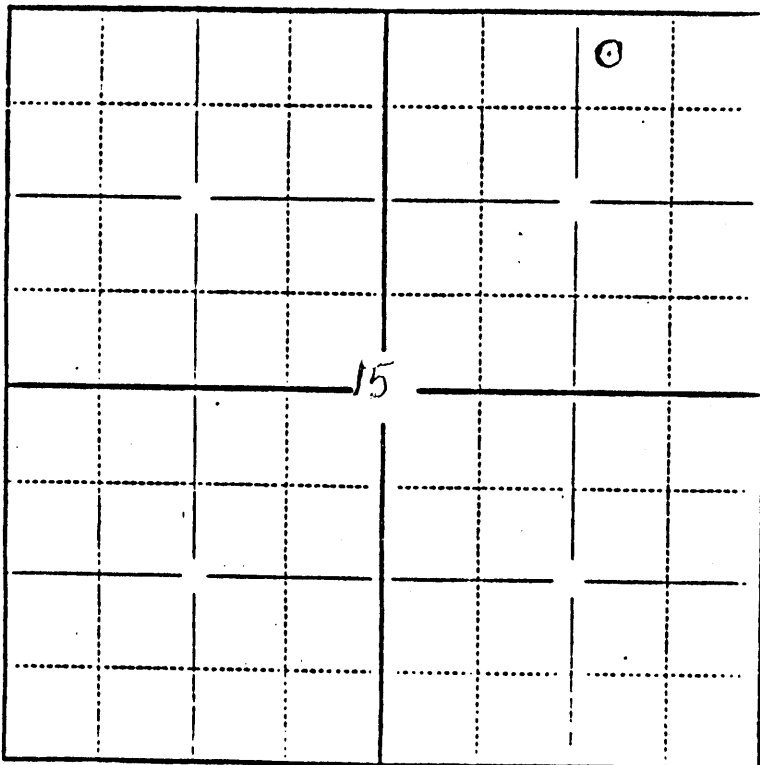

In plotting the proposed location of the well, you must show:

- 1) The manner in which you are using the depicted plat by identifying section lines, i.e. 1 section, 1 section with 8 surrounding sections, 4 sections, etc.;
- 2) the distance of the proposed drilling location from the section's south/north and east/west lines; and
- 3) the distance to the nearest lease or unit boundary line.



KANSAS

CORPORATION COMMISSION

KATHLEEN SEBELIUS, GOVERNOR

BRIAN J. MOLINE, CHAIR

JOHN WINE, COMMISSIONER

ROBERT E. KREHBIEL, COMMISSIONER

January 6, 2004

Mr. R.J. Patrick
R.J. Patrick Operating Company
PO Box 1157
Liberal, KS 67905-1157

RE: Drilling Pit Application
Lindsay Lease Well No. 1-15
NE/4 Sec. 15-33S-19W
Comanche County, Kansas

Dear Mr. Patrick:

District staff has inspected the above referenced location and has determined that the reserve pit shall be constructed **without slots**, the bottom shall be flat and reasonably level, and the free fluids must be removed. The fluids are to be removed from the reserve pit as soon as the Hutchinson Salt section has been drilled through and displacement of the fluids into the reserve pit has occurred. The fluids should be removed again as soon as practical after drilling operations have ceased.

If production casing is set all completion fluids shall be removed on a daily basis.

The fluids should be taken to an authorized disposal well. Please call the District Office at (620) 225-8888 when the fluids have been removed. Also please file the enclosed CDP-5 form, Surface Pond Waste Transfer, within 30 days of fluid removal.

A copy of this letter should be posted in the doghouse along with the approved Intent to Drill.

If you have any questions or concerns please feel free to contact the undersigned at the above address.

Sincerely,

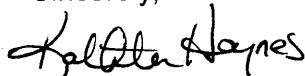

Kathleen Haynes
Environmental Protection and Remediation Department

cc: S Durrant